

HUNTERS®

HERE TO GET *you* THERE

10 Glebe Meadow, Sharow, Ripon, HG4 5BD

Offers Over £250,000

Property Images



HUNTERS[®]

HERE TO GET *you* THERE

Property Images



Floorplan

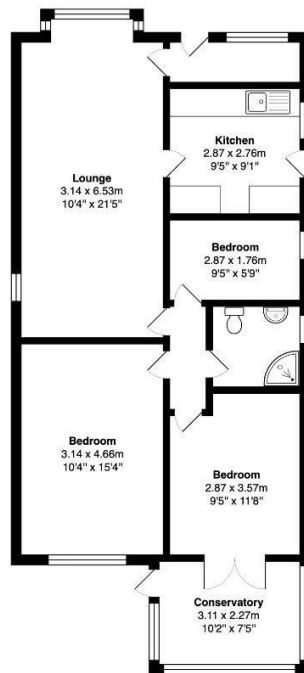

Ground Floor

Total Area: 78.6 m² ... 846 ft²

All measurements are approximate and for display purposes only

EPC

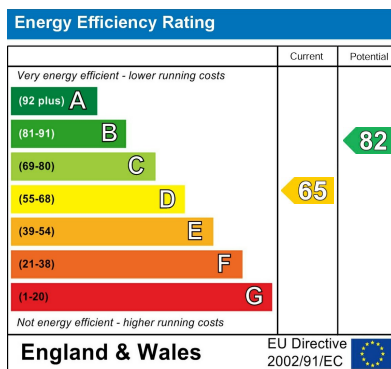

Map

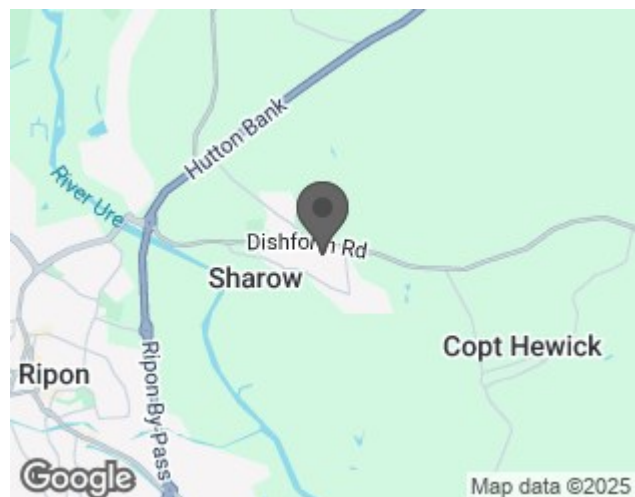

Details

Type: Bungalow - Detached Beds: 3 Bathrooms: 1 Receptions: 1 Tenure: Freehold

Summary

A three bedroom link detached bungalow set in this very popular village on the outskirts of Ripon city now requiring modernizing throughout with great potential to improve, reconfigure throughout and make a lovely home.

Entrance to front hallway with plenty of space for coats and shoes. Through to a generous lounge with large window to the front. A fitted kitchen with space for some appliances and side access.

Three bedrooms, two double and one single, a house bathroom and rear conservatory over looking the rear garden, which offers a lovely aspect with mature trees and shrubs, laid to lawn and timber shed.

There is also a single garage with power and driveway with parking for multiple vehicles as well as planted garden to the front.

The property must be seen to appreciate the potential on offer in this lovely setting.

Features

• THREE BEDROOMS • LOUNGE • KITCHEN • BATHROOM • REAR ENCLOSED GARDEN • CONSERVATORY • DOUBLE GLAZING • CENTRAL HEATING • ATTACHED GARAGE AND DRIVEWAY • VILLAGE LOCATION ON THE OUTSKIRTS OF RIPON