



## Steele Road

Isleworth, TW7

£815,000

This stunning Victorian house, built in 1881, offers an exceptional blend of period charm and modern family living, ideally situated on a prime road in an excellent location close to transport links, schools, and local amenities.

- Beautiful Victorian House Built in 1881
- Extended Three Double Bedroom, with Two Bathrooms and Study/Nursery
- South West Facing Hard Landscaped Private Garden
- Ideally Located Close to The River Thames & St Margarets
- Double Reception with Bay Window
- Master Bedroom with En-Suite
- Practical Utility Space
- Downstairs WC
- Modern Fitted Kitchen



SCAN HERE  
FOR  
PROPERTY  
DETAILS



**Steele Road, Isleworth, TW7 7HL**

Approximate Gross Internal Area  
1453 sq ft - 135 sq m

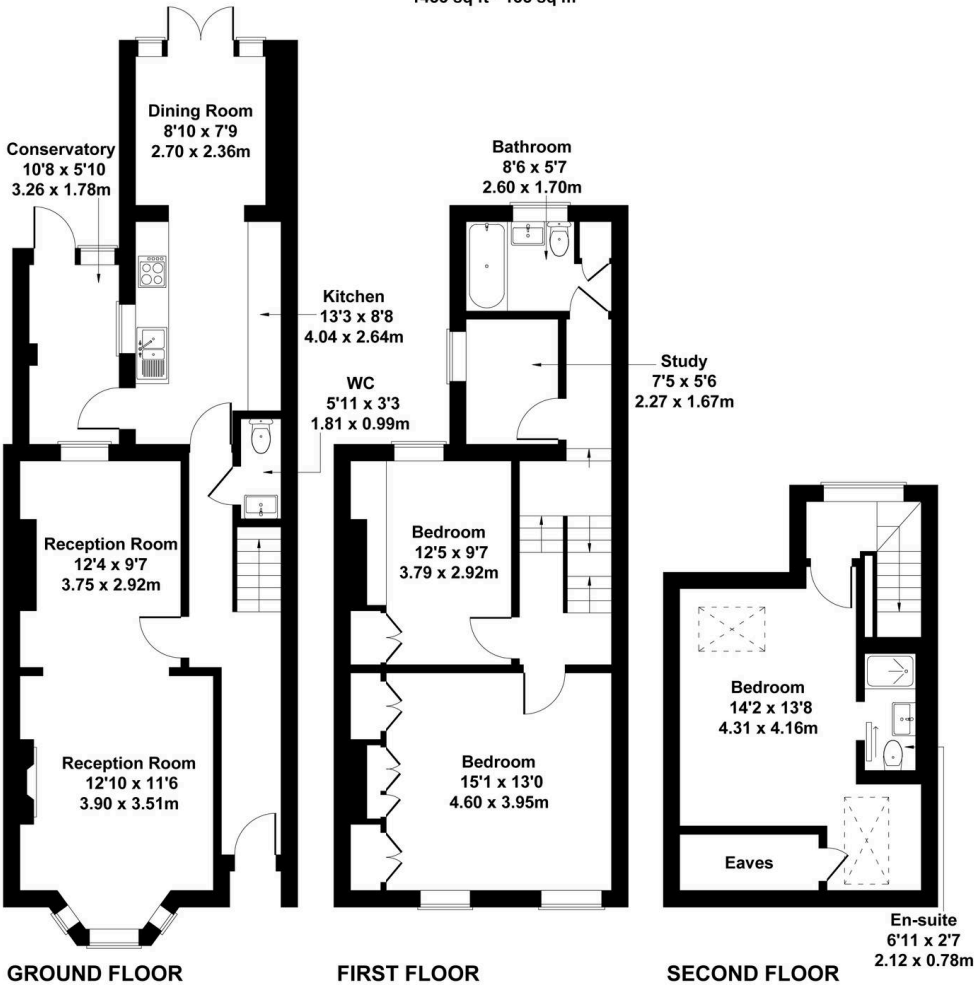

This floorplan is for guidance only and does not form part of an offer or contract.  
Buyers or tenants should verify all details through inspection, searches, and surveys.  
Measurements are approximate and should not be relied upon for valuation or transactions.  
Produced by Plan Portal.  
[www.evolveLondon.co.uk](http://www.evolveLondon.co.uk)