



Apartment (EPC Rating: 73)

**PENYWERN ROAD, LONDON, SW5 9ST**

**£2,695 pcm**



1



1



2



# 2 Bedroom Apartment located in London.

One of the finest roof terraces you are ever likely to see, this fantastic two-bedroom, split-level apartment occupies the top floor of an attractive period building. Ideally located just moments from the shops, cafés, restaurants, and excellent transport links of Earl's Court.

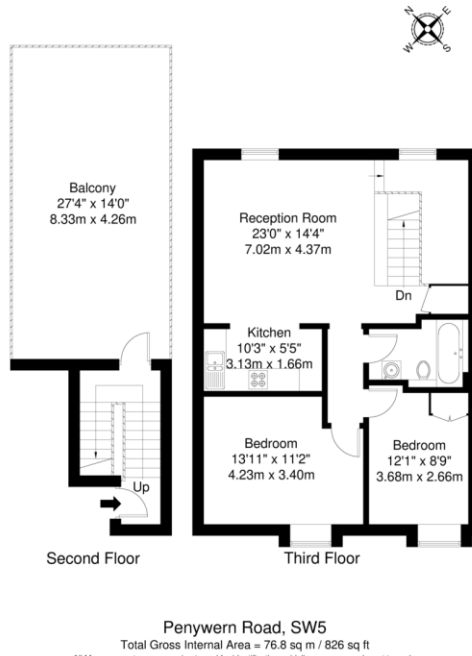

Council Tax Band  
**BAND D**

Call us on  
**0203 633 6560**

Energy Performance Graph

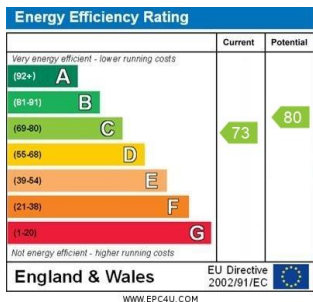

info@brownrok.com  
www.brownrok.com

Agents Note: Whilst every care has been taken to prepare these particulars, they are for guidance purposes only. All measurements are approximate and are for general guidance purposes only and whilst every care has been taken to ensure their accuracy, they should not be relied upon and potential buyers are advised to recheck the measurements.

