



Flat 17 Fairway, Shoppenhangers Road, Maidenhead SL6 2PZ

welcome to

Flat 17 Fairway, Shoppenhangers Road, Maidenhead

Offered to the market is this light and spacious two double bedroom first floor apartment with two bathrooms, a balcony and TWO parking spaces in a gated complex just half a mile of Maidenhead's mainline station with great links into London on the Elizabeth Line. NO ONWARD CHAIN.



Shoppenhangers Road, SL6

Approximate Area = 882 sq ft / 81.9 sq m

For identification only - Not to scale

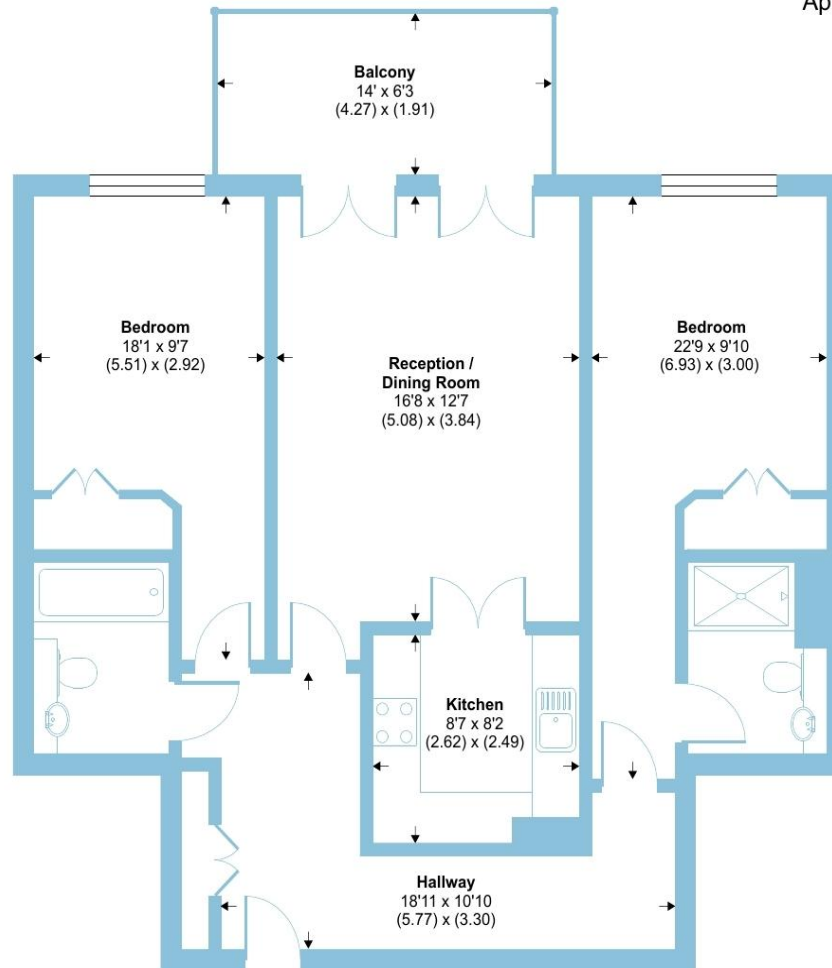

FIRST FLOOR

Located in a gated development off Shoppenhangers Road is Fairway. Built in 2005, professionally maintained and in good condition throughout, this light and spacious first floor apartment offers views from the balcony over the well matured communal grounds.

This home offers the ability to separate off the kitchen from the open living space with double doors meaning you have all the benefits of open plan living but you can hide the kitchen when you want to.

Having two double bedrooms with both an en-suite plus a family bathroom, there isn't much this home doesn't offer, it even has two allocated parking spaces. This property is a MUST VIEW!



Floor plan produced in accordance with RICS Property Measurement Standards incorporating International Property Measurement Standards (IPMS2 Residential). © nichecom 2023. Produced for Barnard Marcus. REF: 979695



welcome to

Flat 17 Fairway, Shoppenhangers Road

- NO ONWARD CHAIN
- GATED COMPLEX WITH TWO PARKING SPACES
- LIGHT & SPACIOUS FIRST FLOOR APARTMENT
- TWO DOUBLE BEDROOMS
- OPEN LIVING AREA
- BALCONY
- SEPARATE KITCHEN
- HALF MILE OF MAIDENHEAD MAINLINE TRAIN STATION

Tenure: Leasehold EPC Rating: B

Council Tax Band: D Service Charge: 2361.00

Ground Rent: 200.00

This is a Leasehold property with details as follows; Term of Lease 125 years from 01 Jan 2005. Should you require further information please contact the branch. Please Note additional fees could be incurred for items such as Leasehold packs.

guide price

£350,000



Please note the marker reflects the
postcode not the actual property

check out more properties at rogerplatt.co.uk



Property Ref:
MHD123601 - 0003

1. MONEY LAUNDERING REGULATIONS Intending purchasers will be asked to produce identification documentation at a later stage and we would ask for your co-operation in order that there is no delay in agreeing the sale. 2. These particulars do not constitute part or all of an offer or contract. 3. The measurements indicated are supplied for guidance only and as such must be considered incorrect. Potential buyers are advised to recheck measurements before committing to any expense. 4. We have not tested any apparatus, equipment, fixtures or services and it is in the buyers interest to check the working condition of any appliances. 5. Where an EPC, or a Home Report (Scotland only) is held for this property, it is available for inspection at the branch by appointment. If you require a printed version of a Home Report, you will need to pay a reasonable production charge reflecting printing and other costs. 6. We are not able to offer an opinion either written or verbal on the content of these reports and this must be obtained from your legal representative. 7. Whilst we take care in preparing these reports, a buyer should ensure that his/her legal representative confirms as soon as possible all matters relating to title including the extent and boundaries of the property and other important matters before exchange of contracts.

Roger Platt is a trading name of Sequence (UK) Limited which is registered in England and Wales under company number 4268443, Registered Office is Cumbria House, 16-20 Hockliffe Street, Leighton Buzzard, Bedfordshire, LU7 1GN. VAT Registration Number is 500 2481 05.

roger platt



01628 773333



Maidenhead@rogerplatt.co.uk



**25-29 Queen Street, MAIDENHEAD, Berkshire,
SL6 1NB**



rogerplatt.co.uk