



Wimbart Road, SW2

£350,000

Dexters



Wimbart Road, SW2

A ground-floor period conversion presented in superb condition throughout with a private garden and no onward chain. The bright and airy accommodation has been thoughtfully arranged to include a spacious forward-facing reception room, feature fireplace, a bay window with plantation shutters; a large, separate kitchen/breakfast room which is brand new; a double bedroom and a bathroom.

Wimbart Road is a residential street located between Brixton Hill and Streatham Hill not too far from Brockwell Park, so ideal for access to the many local shops and supermarkets as well the park itself.

Features

- Period
- Reception Room
- Brand New Separate Kitchen
- Private Garden
- Long Lease
- Chain Free



Wimbart Road, London, SW2

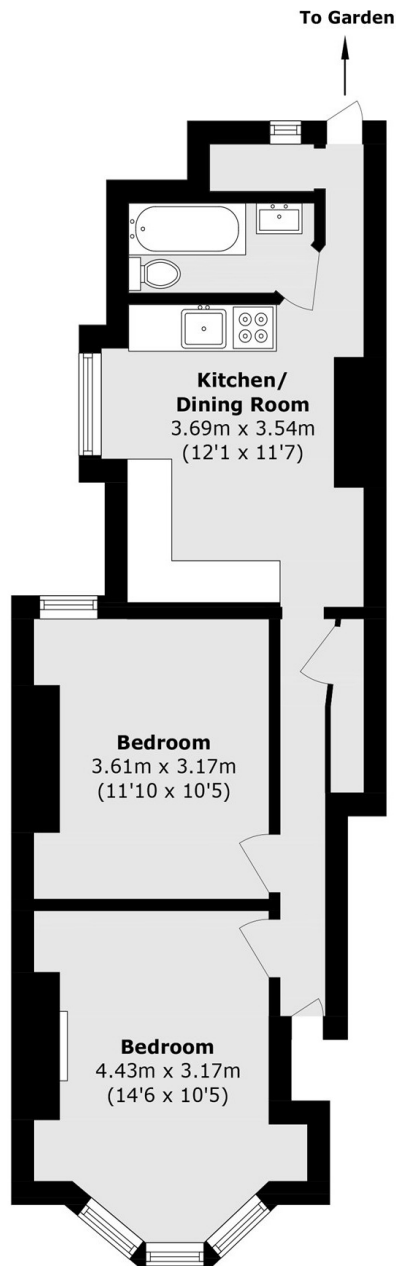

Total area (approx.): 48.9 sq. m (526.3 sq. ft)