

PETERMANS
LOCAL PROPERTY EXPERTS



**Penshurst Gardens,
Edgware,
£1,650,000
Freehold**

- Spectacular 7 Bedroom, 3 Bath, Detached Family Home
- Highly Sought After, Central Location
- Skilfully Extended & Providing 3,500 sq Ft of Accommodation
- 3 Reception Rooms
- Impressive Kitchen/Family Room With Skylight
- 80Ft Rear, South Facing Garden
- 3,522 Sq FT

8 THE PROMENADE, EDGWAREBURY LANE, EDGWARE, MIDDLESEX HA8 7JZ
t: 020 8958 5040 e: edgware@petermans.co.uk w: www.petermans.co.uk



Petermans for themselves and for the vendors or lessors of this property for whom they act, give notice that i) these particulars are a general outline only, for the guidance or prospective purchasers or tenants, and do not constitute the whole or any part of an offer or contract, ii) Petermans cannot guarantee the accuracy of any description, dimensions, references to condition, necessary permissions for use and occupation; and other details contained herein, and prospective purchasers or tenants must not rely on them as statements of fact, and must satisfy themselves as to their accuracy, iii) no employee of Petermans has any authority to make or give any or representation or warranty or enter into any contract whatever in relation to the property, iv) rents, prices, premiums and service charge quoted in these particulars may be subject to VAT in addition, and v) Petermans will not be liable, in negligence or otherwise, for any loss arising from the use of these particulars.



Situated on Penshurst Gardens, directly opposite Heather Walk, this exceptional seven-bedroom, three-bathroom detached family home has been thoughtfully and expertly extended, offering over 3,500 sq ft of beautifully presented accommodation.



The property offers a well-balanced layout, including a separate lounge and dining room, a dedicated office, and a downstairs WC. At its heart is an impressive open-plan kitchen, breakfast, and family area, complete with a central island, skylight, and a separate utility room/second kitchen. On the first floor, the principal bedroom features extensive fitted wardrobes, a private balcony, and a spacious, luxurious en-suite bathroom. The second floor hosts two further bedrooms, served by a stylish Jack and Jill bathroom. The south-facing rear garden extends to approximately 80 ft, providing an ideal space for outdoor entertaining and family living.









Ground Floor

Approx. 164.6 sq. metres (1771.7 sq. feet)

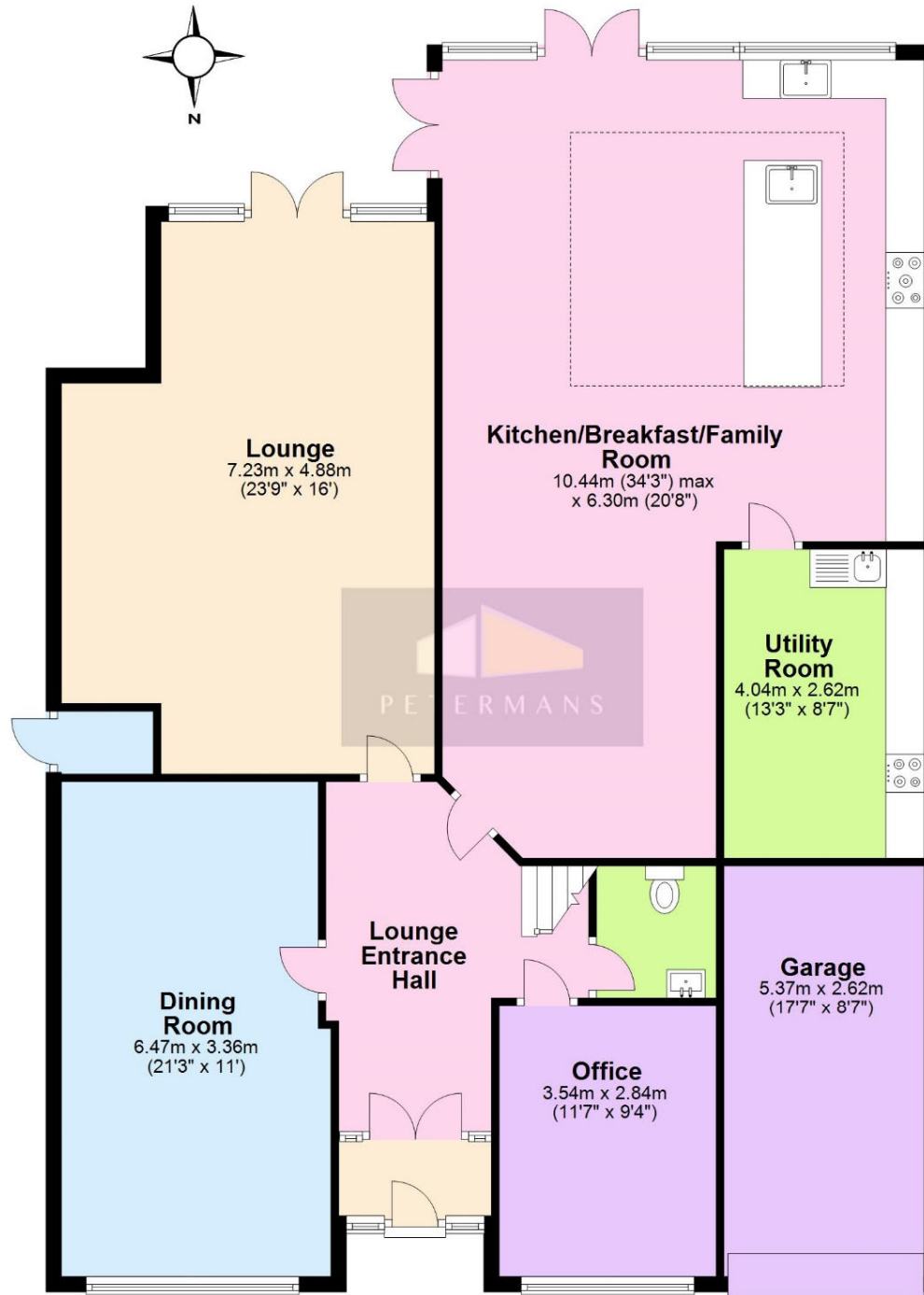

Total area: approx. 327.2 sq. metres (3522.3 sq. feet)

First Floor

Approx. 122.3 sq. metres (1316.8 sq. feet)



Second Floor

Approx. 40.3 sq. metres (433.9 sq. feet)

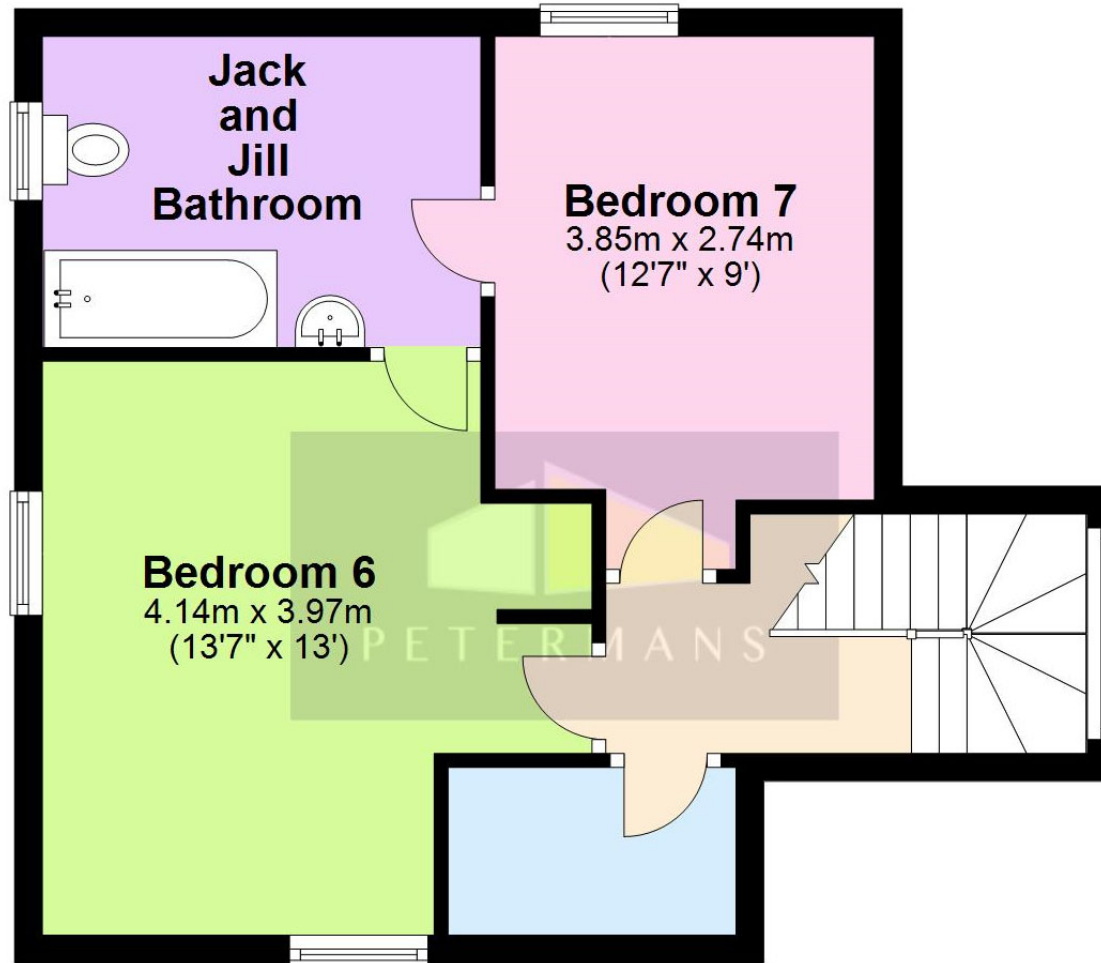

Total area: approx. 327.2 sq. metres (3522.3 sq. feet)

VIEWING STRICTLY BY APPOINTMENT ONLY.

PETERMANS TEL: 020 8958 5040 Please Note That The Gas And Electric Appliances Have Not Been Tested To Ensure That They Are In Working Order. All Measurements Are Taken With A Laser Tape Measure And Therefore Subject To Some Variation. We Recommend Any Potential Purchaser Checks These For Themselves To Confirm Their Accuracy

Price: £1,650,000
Tenure: Freehold
Beds: 7
Baths: 3
Reception Rooms: 4
Total Sq Ft: 3,522
Council Tax Band: Band H in Barnet
EPC Rating: TBC

Distance to:
Edgware Station 0.4 Miles
Mill Hill Station 1.1 Miles

