



Cedar Park Road, Enfield, EN2 0HE

welcome to

Cedar Park Road, Enfield

Barnfields are delighted to offer for sale this spacious two/three bedroom detached 1930's built bungalow in a sought after turning close to the green space of Hilly Fields Country Park, local shops on Lancaster Road and within a 10 minute walk of Gordon Hill Overground Station (Moorgate Line). Originally built with three bedrooms, one of the walls has been removed to create a 25ft lounge to the rear and benefits from off-street parking, garage and a fantastic South Facing rear garden.

This chain free property must be viewed to be fully appreciated!



Hallway

Fitted carpet, radiator.

Bedroom One

13' 9" x 13' 9" (4.19m x 4.19m)

Bay of double glazed windows to front aspect, fitted carpet, picture rails, fireplace with tiled inserts.

Bedroom Two

11' 9" x 11' 1" (3.58m x 3.38m)

Double glazed windows to front, radiator, fitted carpet.

Kitchen

9' 9" x 8' 6" (2.97m x 2.59m)

Range of fitted wall and base units with toning worktops, single drainer sink unit, space for oven with stainless steel splashback and extractor above, space for fridge/freezer, plumbing for washing machine, tiled splashbacks, vinyl flooring, large built-in cupboard, double glazed window and door to garage area.

Shower Room

Fully tiled step-in shower unit, low level WC, pedestal wash hand basin, double glazed window to side aspect, vinyl flooring, part tiled walls.

Lounge

25' 2" x 11' 5" (7.67m x 3.48m)

Originally two rooms that have been knocked into one to create a spacious rear lounge with fitted carpet, picture rails two radiators, double glazed windows and sliding patio doors to garden.

Outside

Garden

A beautifully landscaped and well stocked South Facing rear garden with ornamental pond, central lawn and greenhouse.

Carport/Garage

Accessed via the driveway is an up and over garage door opening to a large covered car port with glass roof giving access to the kitchen and the rear garden.

Off-Street Parking

Brick paved off-street parking to the front with an EV Charger.

Front Garden

A well stocked and well maintained front garden with pretty pathway leading to the front door.



view this property online barnfields.co.uk/Property/ENF105612







welcome to

Cedar Park Road, Enfield

- Detached Bungalow
- Two/Three Bedrooms
- Off-Street Parking EV Charger
- Garage/Car Port
- Close To Shops

Tenure: Freehold EPC Rating: Awaited
Council Tax Band: F

£700,000



Please
note the
marker
reflects
the
postcode
not the
actual
property

check out more properties at barnfields.co.uk



Property Ref:
ENF105612 - 0002

1. MONEY LAUNDERING REGULATIONS Intending purchasers will be asked to produce identification documentation at a later stage and we would ask for your co-operation in order that there is no delay in agreeing the sale. 2. These particulars do not constitute part or all of an offer or contract. 3. The measurements indicated are supplied for guidance only and as such must be considered incorrect. Potential buyers are advised to recheck measurements before committing to any expense. 4. We have not tested any apparatus, equipment, fixtures or services and it is in the buyers interest to check the working condition of any appliances. 5. Where an EPC, or a Home Report (Scotland only) is held for this property, it is available for inspection at the branch by appointment. If you require a printed version of a Home Report, you will need to pay a reasonable production charge reflecting printing and other costs. 6. We are not able to offer an opinion either written or verbal on the content of these reports and this must be obtained from your legal representative. 7. Whilst we take care in preparing these reports, a buyer should ensure that his/her legal representative confirms as soon as possible all matters relating to title including the extent and boundaries of the property and other important matters before exchange of contracts.

Barnfields is a trading name of Sequence (UK) Limited which is registered in England and Wales under company number 4268443, Registered Office is Cumbria House, 16-20 Hockliffe Street, Leighton Buzzard, Bedfordshire, LU7 1GN. VAT Registration Number is 500 2481 05.

Cedar Park Road, Enfield, EN2

Approximate Area = 822 sq ft / 76.3 sq m
Garage = 172 sq ft / 15.9 sq m
Outbuildings = 191 sq ft / 17.7 sq m
Total = 1185 sq ft / 109.9 sq m
For identification only - Not to scale

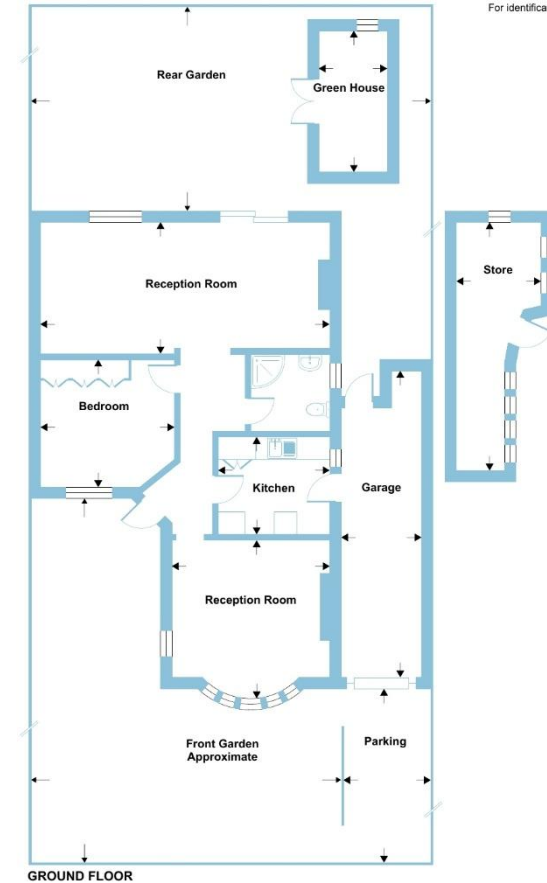

Floor plan produced in accordance with RICS Property Measurement 2nd Edition, Incorporating International Property Measurement Standards (IPMS2 Residential). © nrichcom 2026. Produced for Barnard Marcus. REF: 1406281

barnfields

barnfields



020 8363 3394



info@barnfields.com



1a Windmill Hill, Enfield, Middlesex, EN2 6SE



barnfields.co.uk