



Dykes Hall Road, Hillsborough , Sheffield, S6 4GR

Offers In Region Of £230,000

3 1 1



A spacious three bedroom end-terrace home with high ceilings, generous room proportions and excellent potential to further enhance, offered freehold and benefiting from a courtyard-style rear garden.

Situated on Dykes Hall Road in the ever-popular Hillsborough area, this attractive end-terrace property offers larger-than-average accommodation compared with many of the standard terraces nearby, creating a wonderful sense of space throughout.

The ground floor features a bright and welcoming living room alongside a kitchen and dining area to the rear, providing a practical layout suited to modern living.

To the first floor are three bedrooms together with a family bathroom. The generous ceiling heights and well-proportioned rooms give the property a particularly airy feel.

The property also offers excellent potential for further development, with ample roof space that could allow for a loft conversion without significantly reducing the size of the existing rooms.

Externally, the property enjoys a low-maintenance courtyard-style rear garden, ideal for outdoor seating. Parking is available on-road to the front.

Located within easy reach of Hillsborough's excellent amenities, shops, cafes and transport links, the property is ideally placed for both first-time buyers and families.

Being sold freehold, this home represents a fantastic opportunity to acquire a spacious terrace with further potential in a highly convenient location.

Early viewing is highly recommended.



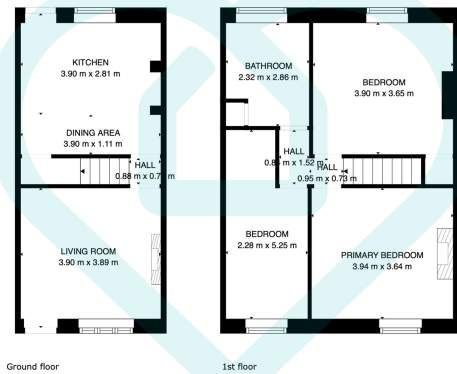

TOTAL: 86 m²
 Ground floor: 33 m², 1st floor: 53 m²
 EXCLUDED AREAS: WALLS: 10 m²

This floor plan is for illustrative purposes only. All measurements and layouts are approximations and do not necessarily capture the precise specifications of the property. No responsibility is taken for any error, omission, or misstatement. We always recommend viewing in person to confirm the exact floor plan of a property. Made with Metropix.



- Three bedroom end-terrace home
- High ceilings and spacious rooms
- Bright living room
- Excellent loft conversion potential
- On-road parking
- Larger than average accommodation
- Kitchen with dining area
- Courtyard-style rear garden
- Freehold property
- Popular Hillsborough location

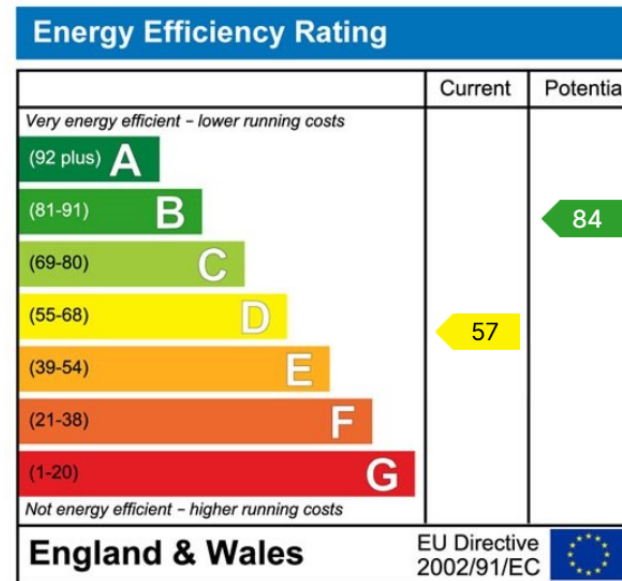

Sales | Lettings | New Homes

VAT Reg Number: 191 3588 84
 Company Reg Number: 08610489
 Company Reg Address: 67 Middlewood Road, Hillsborough, Sheffield, S6 4GX.

The MorfittSmith Building
 67 Middlewood Road
 Hillsborough
 Sheffield
 S6 4GX

Get in touch - arrange an appointment

- 0114 232 1764
- sales@morfittsmith.co.uk
- lettings@morfittsmith.co.uk
- newhomes@morfittsmith.co.uk
- www.morfittsmith.co.uk
- @MorfittSmith
- @MorfittSmith
- MorfittSmith Estate & Letting Agent