

RUSSELL ROAD,
W14

£675,000

Share of Freehold

2

1

1

D

PROPERTY FEATURES

- Open Plan Kitchen/Reception
- High Ceilings and Lots of Light
- Moments from Kensington High Street & Holland Park
- Share of Freehold
- No Onward Chain
- Excellent Condition Throughout



ALEXANDER STEER
Estate Agents



PROPERTY FEATURES

A spacious, raised ground floor conversion flat situated in a quiet, tree lined residential road only a street away from Kensington High Street and a few streets away from Holland Park. Arranged laterally, this lovely flat benefits from excellent ceiling height throughout, East and West aspects allowing for plenty of light and is well appointed. This excellent home is offered to the market with a share of the freehold and no onward chain.

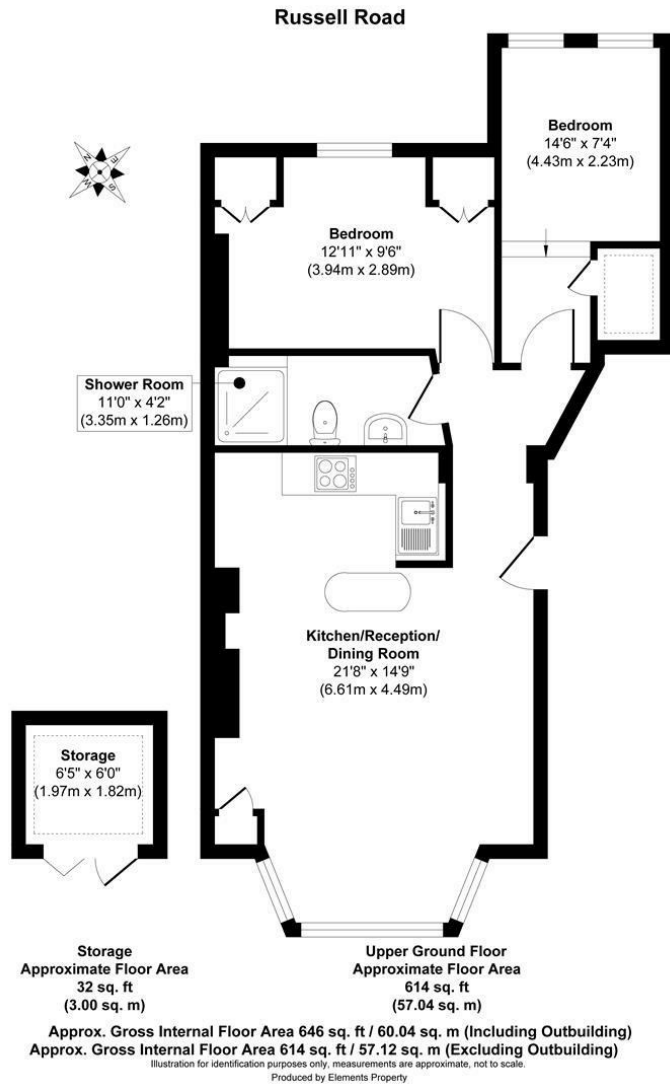

©ALEXANDERSTEERPROPERTY



**ALEXANDER
STEER**

0203 822 0111
hello@alexandersteer.co.uk
158a Shepherds Bush Road, Hammersmith, London,
W6 7PB

All sizes are approximate. The Agent has not tested any apparatus, equipment, fixtures and fittings, or services and so cannot verify that they are in working order or fit for the purpose. A buyer is advised to obtain verification from their Solicitors or Surveyor. Photographs are for illustration purposes only and may depict items, which are not for sale or included in the sale price. References to tenure of a property are based upon Information supplied by the vendor. The agent has not had sight of the title documents, a buyer is advised to obtain verification from their solicitor.

Money Laundering Regulations 2003: Intending purchasers will be asked to produce identification, documentation at a later stage and we would ask for your co-operation in order that there will be no delay in agreeing the sale. These particulars are intended to give a fair description of the property only and are in no way guaranteed, nor do of any contract. They are issued on the express condition that all negotiations are conducted through Alexander Steer Estate Agents. All subject to contract and to being unsold.