



**HENDERSON  
CONNELLAN**  
ESTATE AGENTS

25 Tunwell lane, Corby, Northamptonshire, NN17 1AR  
£240,000

3 1 2



## "An Individual Home with Character"

Rarely available, this end terrace property is well located within the Old Village area and is close to local amenities. The accommodation has been part modernised with a stylish new kitchen and includes a hall, lounge, separate dining room, three bedrooms and a bathroom.

The accommodation requires some cosmetic updating in areas making it an interesting project for a buyer to style and finish to their own design. Outside there is an enclosed garden and a single garage.

### **Description:**

This attractive period home is being offered for sale with NO CHAIN.

The property is well located within the Old Village area which is close to local amenities including the large Asda super market.

The accommodation comprises entrance hall with stairs rising to the first floor landing. There are separate reception rooms with the lounge featuring an open fire place.

There is a dining room which connects to the stunning kitchen which is fitted with a range of wall and base level units with work surfaces incorporating an under counter Belfast sink. The units include drawers and a glazed display unit. There is a range cooker and integrated dish washer while there is a storage cupboard which provides space and plumbing for a washing machine and tumble dryer (appliances not included). A door opens onto the rear garden.

From the first floor landing there is a bathroom which includes a side panel bath with shower and screen, WC and a pedestal wash hand basin with ceramic tiled wall surrounds.

There are three bedrooms.

Gas fired central heating system.

### **Outside:**

There is retained frontage with a stone and brick wall with railings. There is an enclosed garden which offers a good degree of privacy with pedestrian gated access and access to the single garage.





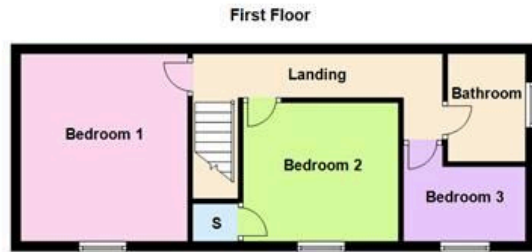
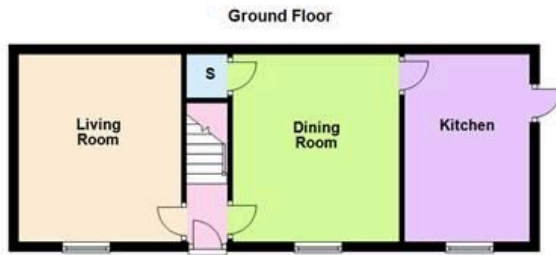

- Kitchen - 12' 11" x 8' 8" (3.93m x 2.64m)
- Dining Room - 11' 6" x 12' 11" (3.50m x 3.93m)
- Living Room - 12' 11" x 11' 3" (3.93m x 3.43m)
- Bedroom 1 - 12' 10" x 11' 6" (3.91m x 3.50m)
- Bedroom 2 - 11' 5" x 10' 0" (3.48m x 3.05m)
- Bedroom 3 - 8' 9" x 5' 2" (2.66m x 1.57m)
- Bathroom - 8' 0" x 5' 4" (2.44m x 1.62m)

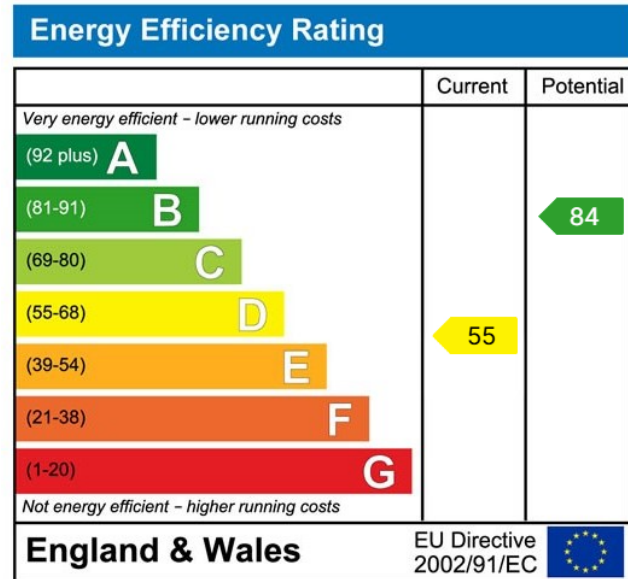

Disclaimer: These particulars do not form part of any offer or contract and should not be relied upon as statements or representations of fact. Any areas, measurements of distances are approximate. The text, photographs and plans are for guidance only and are not necessarily comprehensive.

10 Spencer Court, Corby, Northamptonshire, NN17 1NU

