

HENDERSON CONNELLAN

ESTATE AGENTS

Hallwood Road, Kettering, NN16

"Level Living with Park Views"

"Level Living with Park Views"

This three-bedroom bungalow is in prime location enjoying lovely views over the Pleasure Park opposite and it's Victorian bandstand. The property is offered to the market with NO CHAIN. The versatile interior comprises entrance hallway, spacious living room, kitchen, dining room, sunroom on one side and two double bedrooms and a WC separate to the bathroom on the other. There is a separate door to the third double bedroom with en-suite making the perfect annex or work from home office. Parkland walks are on your doorstep along with a whole range of local amenities and the town centre, General Hospital and Mainline Railway are with easy reach. Outside there is plenty of off road parking, an oversized single garage and a large rear garden with workshop. A most impressive home and setting. The property is finished with gas central heating and UPVC double glazed windows. Call us to book a private viewing today.

Kitchen - 4.5m x 2.74m (14'9" x 9'0")

Dining Room - 3m x 3.63m (9'10" x 11'11")

Living Room - 6.48m x 4.47m (21'3" x 14'8")

Sun Room - 1.83m x 3.63m (6'0" x 11'11")

Bedroom 1 - 3.48m x 3.61m (11'5" x 11'10")

Bedroom 2 - 3.48m x 3.61m (11'5" x 11'10")

Bedroom 3 - 4.04m x 3.23m (13'3" x 10'7")

Ensuite - 2.03m x 1.65m (6'8" x 5'5")

Garage - 7.01m x 3.1m (23'0" x 10'2")

- NO CHAIN
- Three double bedrooms
- Gas central heating
- UPVC double glazed windows
- Large garden
- Off road parking for multiple vehicles
- Single elongated garage with power and lighting
- Stunning park views
- EPC RATING: D
- COUNCIL TAX: E

Council Tax Band: C

Tenure: Freehold





Ground Floor

Approx. 144.1 sq. metres (1551.1 sq. feet)

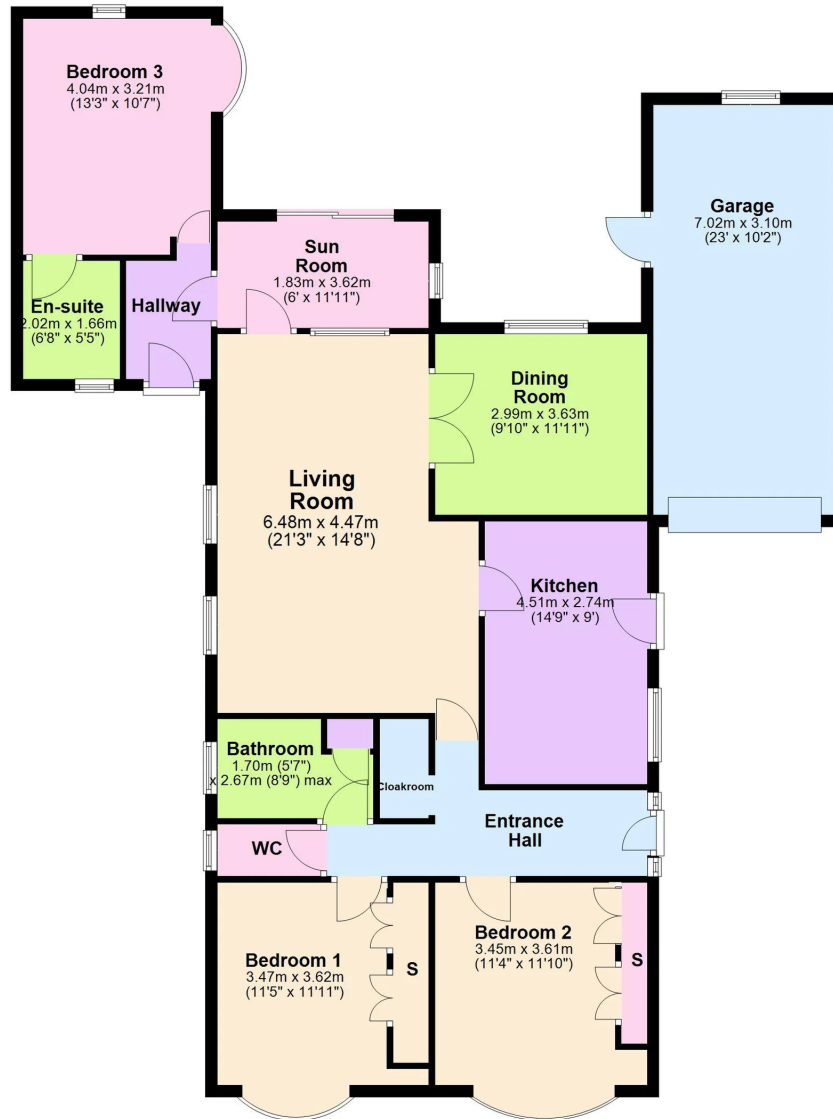

Total area: approx. 144.1 sq. metres (1551.1 sq. feet)

Henderson Connellan Kettering office 01536 417888 ketteringsales@hendersonconnellan.co.uk



Disclaimer: These particulars do not form part of any offer or contract and should not be relied upon as statements or representations of fact. Any areas, measurements of distances are approximate. The text, photographs and plans are for guidance only and are not necessarily comprehensive.

