



Morgans

PROPERTY

47 Jubilee Court, 76 Saint Margaret Street, Dunfermline, KY12 7PF

Offers Over £120,000



1



1



1





One-bedroom apartment



Shower room



Lounge/dining room



Generous double bedroom



Kitchen



Built-in storage



EPC Rating -



Council Tax Band -



Welcome

Superb one bed apartment situated within Jubilee Court. This exclusive retirement complex built by McCarthy and Stone provides a part time house manager, 24 hour care line service, secure entry system, lift to all levels, laundry room, residents lounge and guest suite available by booking. Jubilee Court has proved popular, within walking distance of all amenities and city centre at your fingertips. This complex enjoys a pleasant outlook over landscaped communal gardens. The accommodation comprises; reception hall with walk-in storage cupboard/cloakroom, bright living room with room for dining table and chairs. Fitted kitchen with appliances, double bedroom with built in wardrobe and modern shower room. Residents/visitors parking.





EXTRAS INC. IN SALE/AGENTS NOTE

All floor coverings, blinds, bathroom and light fittings together with integrated appliances. Please note there is a Factor Fee for buildings insurance and maintenance throughout the complex.

From 1st February 2022, residential properties in Scotland are required by law to have installed a system of inter-linked smoke alarms, carbon monoxide detectors and heat detectors (the "inter-linked system"). No warranty is given that any interlinked system has been installed in this property and interested parties should make their own enquiries.





Dunfermline

The ancient capital of Dunfermline won its bid to have official status city in May 2022, as part of the civic honour's competition to celebrate the Queen's platinum jubilee. The City of Dunfermline is of considerable historic interest and is the resting place of King Robert the Bruce. Carnegie's Birthplace museum, the Abbey and Abbot House reflect the historic interest of the city, whilst recent developments have seen Dunfermline move into the modern era with Carnegie Museum and Library. Dunfermline is located approximately five miles from the Forth bridges and is therefore particularly popular with commuters to Edinburgh and many parts of the central belt with easy access to the M90 motorway with its direct links to Edinburgh, Perth and Dundee and across the Kincardine Bridge by way of motorways to Stirling, Glasgow and the West. It benefits from a full range of shops, social and leisure facilities and educational establishments. The local railway stations provide a regular service to Edinburgh with intercity links to other parts of the UK. There are regular and convenient bus services both local and national.

Morgans Property Package

We provide the complete buying and selling package including a comprehensive estate agency service and full legal service. For a FREE PRE-SALE VALUATION, estimate and market appraisal without cost or obligation, contact us.

47 Jubilee Court, 76 Saint Margaret Street, Dunfermline, KY12 7PF

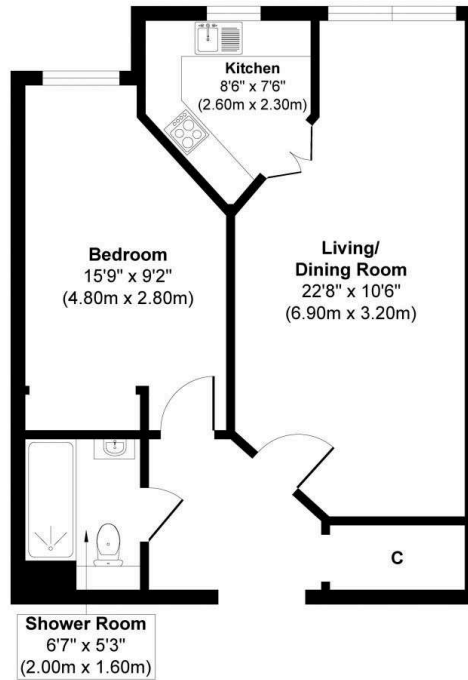

Approximate Floor Area
505 sq. ft
(46.96 sq. m)



Approx. Gross Internal Floor Area 515 sq. ft / 47.95 sq. m
Illustration for identification purposes only, measurements approximate, not to scale. Copyright



SOLICITORS | PROPERTY
33 East Port, Dunfermline, Fife, KY12 7JE
Tel: 01383 620222 Fax: 01383 621213
www.morganlaw.co.uk

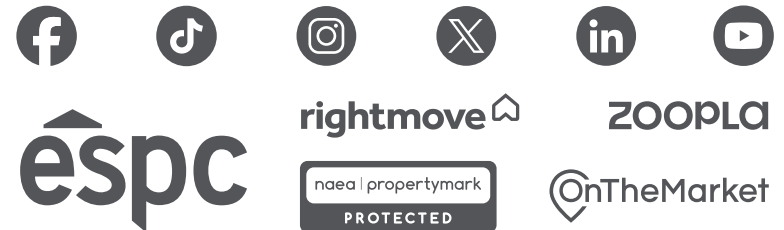

AGENTS NOTE These particulars do not form part of any contract and the statements or plans contained herein are not warranted nor to scale. Approximate measurements have been taken by electronic device at the widest point. Services and appliances have not been tested for efficiency or safety and no warranty is given as to their compliance with any Regulations. No movable items will be included in the sale.