



Leveson Street, London SW16 6DE

welcome to

Leverson Street, London

This well-positioned two-bedroom ground floor apartment offers direct access to a private rear garden and presents excellent potential for enhancement. Ideal for purchasers seeking to personalise a property or investors looking for a promising opportunity, the maisonette provides generous and well-proportioned accommodation throughout.

Both bedrooms are spacious, comfortably accommodating large double beds along with additional storage. These are complemented by a welcoming sitting room and separate kitchen area that provides direct access to the rear garden. The private garden extends around the side of the property, offering a versatile outdoor space.

Situated in the highly sought-after Furzedown area, the property benefits from convenient proximity to Streatham Common Train Station, providing excellent transport links into the City. The apartment is offered with a long lease, making it an attractive option for first-time buyers and investors alike.



Ground Floor
587 sq.ft. (54.5 sq.m.) approx.

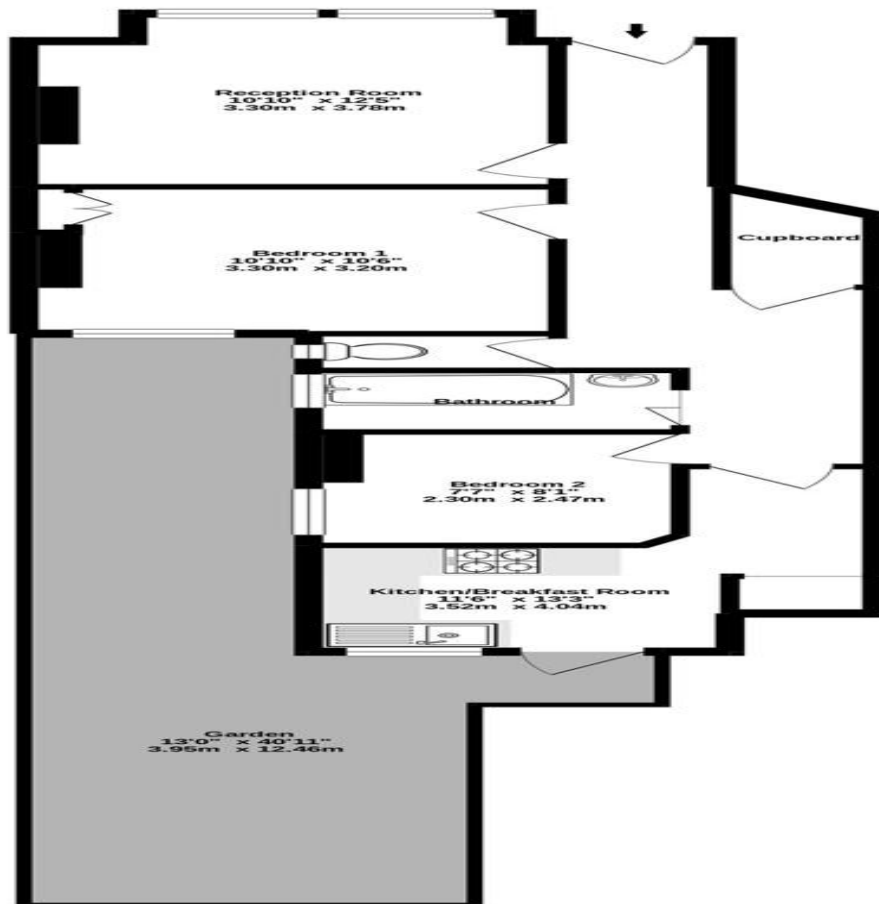

Levenson Street, Streatham, SW16

TOTAL FLOOR AREA : 587 sq.ft. (54.5 sq.m.) approx.

Whilst every attempt has been made to ensure the accuracy of the floorplan contained here, measurements of doors, windows, rooms and any other items are approximate and no responsibility is taken for any error, omission or mis-statement. This plan is for illustrative purposes only and should be used as such by any prospective purchaser. The services, systems and appliances shown have not been tested and no guarantee as to their operability or efficiency can be given.

welcome to

Leverson Street, London

- Two Bedroom
- Near Local Amenities
- Chain Free
- Long Lease
- Wandsworth Borough

Tenure: Leasehold EPC Rating: C

Council Tax Band: B Service Charge: 125.00

Ground Rent: Ask Agent

This is a Leasehold property. We are awaiting further details about the Term of the lease. For further information please contact the branch. Please note additional fees could be incurred for items such as Leasehold packs.

offers in excess of

£375,000



Please note the marker reflects the postcode not the actual property

check out more properties at barnardmarcus.co.uk



Property Ref:
STM109650 - 0004

1. MONEY LAUNDERING REGULATIONS Intending purchasers will be asked to produce identification documentation at a later stage and we would ask for your co-operation in order that there is no delay in agreeing the sale. 2. These particulars do not constitute part or all of an offer or contract. 3. The measurements indicated are supplied for guidance only and as such must be considered incorrect. Potential buyers are advised to recheck measurements before committing to any expense. 4. We have not tested any apparatus, equipment, fixtures or services and it is in the buyers interest to check the working condition of any appliances. 5. Where an EPC, or a Home Report (Scotland only) is held for this property, it is available for inspection at the branch by appointment. If you require a printed version of a Home Report, you will need to pay a reasonable production charge reflecting printing and other costs. 6. We are not able to offer an opinion either written or verbal on the content of these reports and this must be obtained from your legal representative. 7. Whilst we take care in preparing these reports, a buyer should ensure that his/her legal representative confirms as soon as possible all matters relating to title including the extent and boundaries of the property and other important matters before exchange of contracts.

Barnard Marcus is a trading name of Sequence (UK) Limited which is registered in England and Wales under company number 4268443, Registered Office is Cumbria House, 16-20 Hockliffe Street, Leighton Buzzard, Bedfordshire, LU7 1GN. VAT Registration Number is 500 2481 05.



020 8769 9393



Streatham@barnardmarcus.co.uk



120 Mitcham Lane, Streatham, London, SW16 6NS



barnardmarcus.co.uk