



PORTNALL ROAD, W9

£675,000

Set within an attractive Victorian conversion, this well presented ground floor flat offers two double bedrooms, a stylish bathroom, and an impressive extended open plan kitchen and reception room designed for

Two Bedrooms
Period Conversion
Extended

Approximately 694sq ft
Share of Freehold
Chain Free

STEP INSIDE PORTNALL ROAD

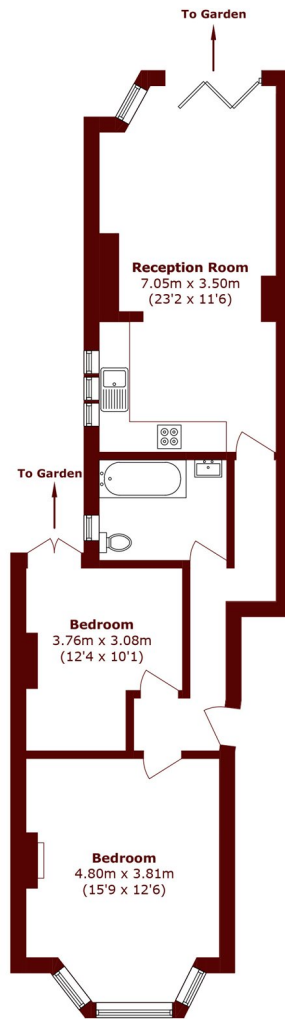

Ground Floor

Total Area (approx.): 64.5 sq. m (694.2 sq. ft)

Little Venice
020 7993 3050

Energy Rating: We aim to make our particulars both accurate and reliable. However, they are not guaranteed; nor do they form part of an offer or contract. If you require clarification on any points then please contact us, especially if you're traveling some distance to view. Please note that appliances and heating systems have not been tested and therefore no warranties can be given as to their good working order

MARSH &
PARSONS