

# Towers Wills

Town & Country

📞 01935 577 032 | 01460 298 530 | ✉ info@towerswills.co.uk



**17, Grebe Road, Yeovil, Somerset BA22 8FY**

**Offers Over £260,000**

Brief description Towers Wills welcome to the market this beautifully presented three bedroom semi detached home situated in Augusta Park the property briefly comprises reception hallway, cloakroom/WC, living room, kitchen /diner, three bedrooms, en suite, bathroom, parking, garage rear garden.

### Accommodation:

Situated on the popular Agusta Park development on the western fringe of Yeovil, this modern three-bedroom semi-detached home, built in 2020 by Persimmon Homes, is beautifully presented throughout and perfectly suited to contemporary family living.

The property welcomes you with a reception hallway and convenient ground floor WC, leading through to a bright and comfortable living room with a front aspect. To the rear, the stylish kitchen/diner forms the heart of the home—ideal for entertaining—featuring a comprehensive range of fitted units, integrated electric oven and induction hob, with space for further appliances. The dining area comfortably accommodates a table and chairs, with double doors opening onto the rear garden, creating a seamless indoor-outdoor flow.

Upstairs, there are three well-proportioned bedrooms, including a principal bedroom with built-in wardrobe and en-suite shower room. Bedroom two is a generous double, while bedroom three is a good-sized single, all served by a modern family bathroom.

### Outside:

Externally, the enclosed rear garden is designed for enjoyment, offering a decked seating area, patio, lawn and planted borders, along with an external tap, power point and gated side access. The property also benefits from parking to the rear and a garage located beneath a coach house (measuring approximately 5.76m x 2.46m). Garage is leasehold.

A fantastic opportunity to acquire a stylish, move-in-ready home in a sought-after residential location.

## Key Features

- Popular Agusta Park Development
- Semi-Detached
- Three Bedrooms
- Master En-suite
- Garage & Driveway
- Rear Garden

## Contact Us

### Towers Wills Estate Agents - Yeovil

114, Hendford Hill  
Yeovil

Somerset

BA202RF

T: 01935 577032

E: [info@towerswills.co.uk](mailto:info@towerswills.co.uk)

## Energy Efficiency

Score	Energy rating	Current	Potential
92+	A		95 A
81-91	B	82 B	
69-80	C		
55-68	D		
39-54	E		
21-38	F		
1-20	G		

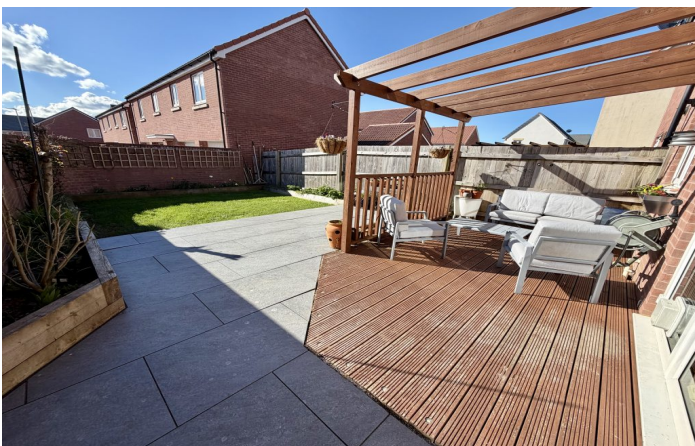

# Floor Plan

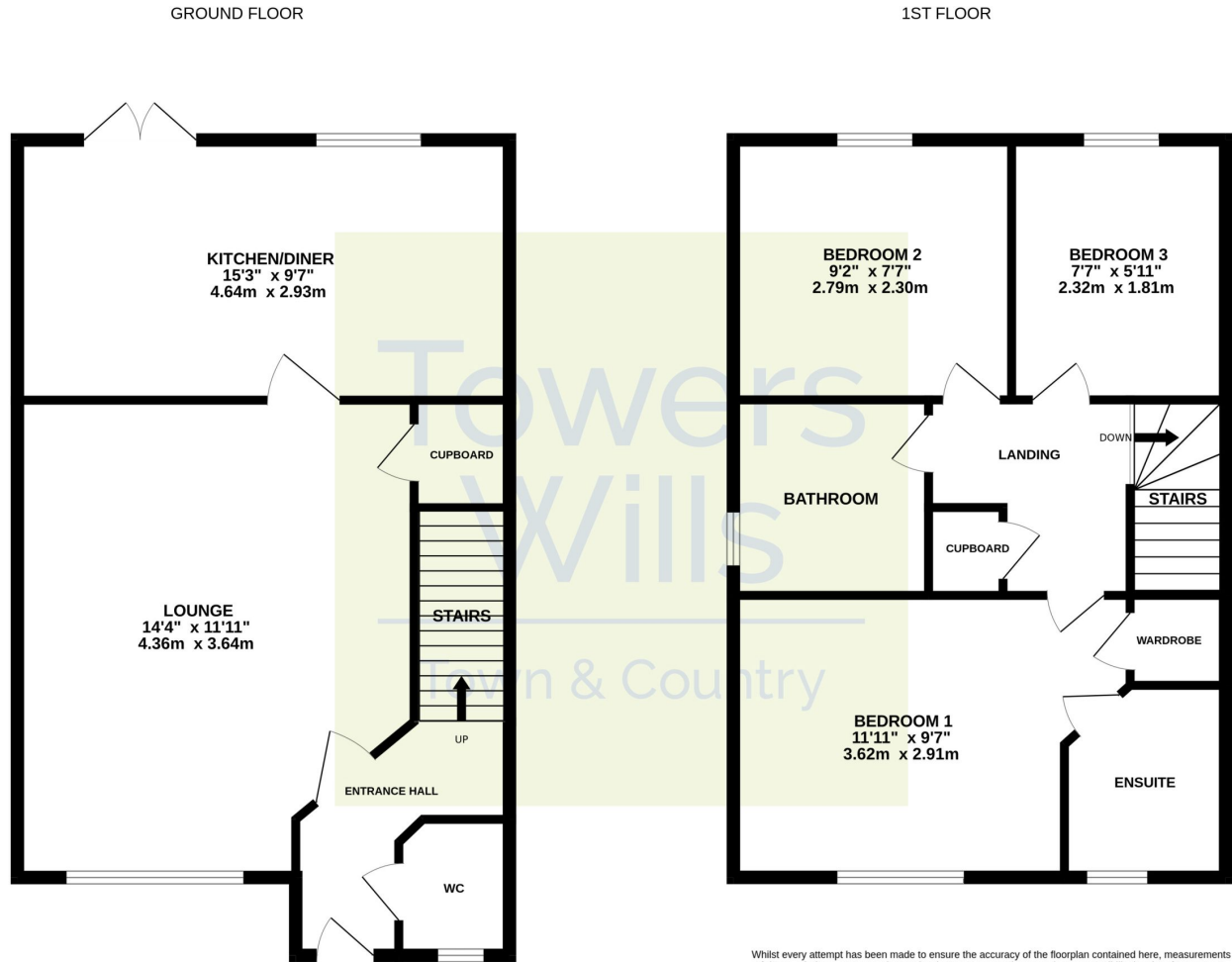

Whilst every attempt has been made to ensure the accuracy of the floorplan contained here, measurements of doors, windows, rooms and any other items are approximate and no responsibility is taken for any error, omission or mis-statement. This plan is for illustrative purposes only and should be used as such by any prospective purchaser. The services, systems and appliances shown have not been tested and no guarantee as to their operability or efficiency can be given.  
Made with Metropix ©2025

Please Note No tests have been undertaken of any of the services and any intending purchasers should satisfy themselves in this regard. Towers Wills Ltd for themselves and for the vendor of this property whose agents they are, give notice that, (i) these particulars do not constitute any part of an offer or contract, (ii) all statements contained within these particulars are made without responsibility on the part of Towers Wills or the vendor, (iii) whilst made in good faith, none of the statements contained within these particulars are to be relied upon as a statement of representation or fact, (iv) any intending purchaser must satisfy him/herself by inspection or otherwise as to the correctness of each of the statements contained within these particulars, (v) the vendor does not make or give either Towers Wills or any person in their employment any authority to make or give representation or warranty whatsoever in relation to this property.

Photographs / Floor Plans Photographs are reproduced for general information and it must not be inferred that any item is included for sale with this property. Please note floor plans are not to scale and are for identification purposes only. The photographs used in these particulars may have been taken with the use of a wide angle lens. If you have any queries as to the size of the accommodation or plot, please address these with the agent prior to making an appointment to view

**Towers Wills**

The White House, 114 Hendford Hill, Yeovil BA20 2RF

Yeovil 01935 577032 / South Petherton 01460 298530

[info@towerswills.co.uk](mailto:info@towerswills.co.uk) | [www.towerswills.co.uk](http://www.towerswills.co.uk)