



Connells

Highglen Drive
Plymouth



Property Description

Beautifully presented throughout, this three-bedroom semi-detached home is located in a peaceful cul-de-sac within the sought-after Newnham Downs development on the edge of Plympton. The property offers well-proportioned accommodation, including a welcoming entrance hall, a convenient downstairs WC, and a spacious kitchen/diner that opens onto the enclosed rear garden-perfect for outdoor dining and family living. The separate lounge provides a comfortable and bright space to relax.

Upstairs offers three well-sized bedrooms and a modern family bathroom, making this an ideal home for families, first-time buyers, or those seeking a quiet, well-connected location. Additional features include off-street parking and easy access to local parkland, with pedestrian routes through Stoggy Lane leading up to Chaddlewood, ideal for walkers and commuters.

Entrance Hall

Double glazed door to the front aspect, door access to lounge and downstairs WC, stairs to kitchen, radiator

Lounge

10' 3" max x 17' 5" max (3.12m max x 5.31m max)

Double glazed window to the front elevation, radiator

Kitchen

8' 8" max x 16' 6" max (2.64m max x 5.03m max)

Double glazed window to the rear elevation, fitted kitchen with wall and base units, sink and draining board with mixer tap, space for cooker, fridge freezer, washing machine and dishwasher, boiler, double glazed door to the rear garden, radiator

Downstairs Wc

Double glazed window to the front elevation, wash hand basin and vanity unit, low level WC

Landing

Two storage cupboards

Bedroom One

10' 10" max x 13' 2" max (3.30m max x 4.01m max)

Double glazed window to the front elevation, radiator

Bedroom Two

10' 2" max x 10' 11" max (3.10m max x 3.33m max)

Double glazed window to the rear elevation, built in mirrored wardrobes

Bedroom Three

7' 11" max x 7' 1" max (2.41m max x 2.16m max)

Double glazed window to the front elevation, radiator

Bathroom

Double glazed window to the rear elevation, bath with shower over, wash hand basin, low level WC, tiled, radiator

Rear Gaden

Tiered garden with decking area and chicken coup



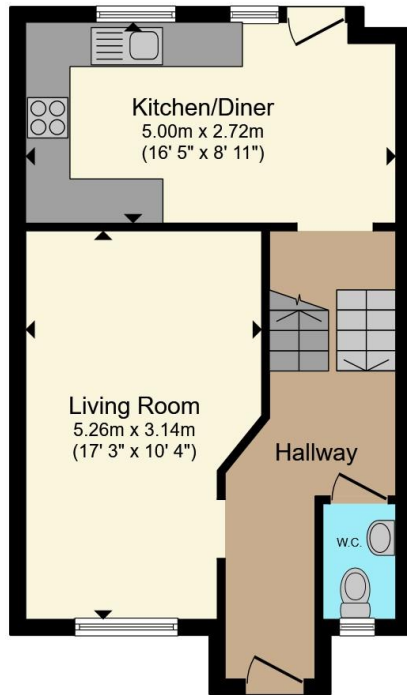

Ground Floor

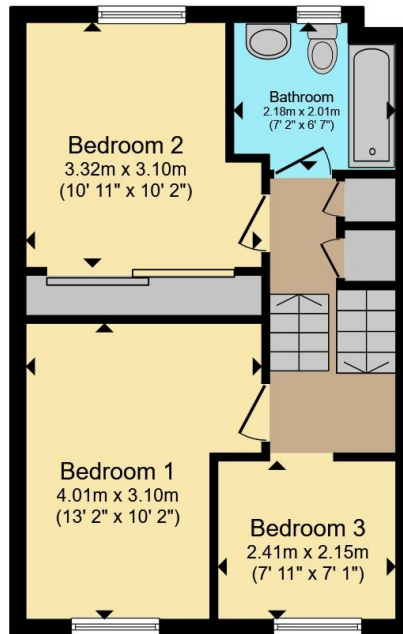

First Floor

Total floor area 81.4 m² (876 sq.ft.) approx

This floor plan is for illustrative purposes only. It is not drawn to scale. Any measurements, floor areas (including any total floor area), openings and orientation are approximate. No details are guaranteed, they cannot be relied upon for any purpose and they do not form part of any agreement. No liability is taken for any error, omission or misstatement. A party must rely upon its own inspection(s). Powered by www.propertybox.io



To view this property please contact Connells on

T 01752 345 135
E plympton@connells.co.uk

110 Ridgeway Plympton
 PLYMOUTH PL7 2HN

EPC Rating: C Council Tax
 Band: C

Tenure: Freehold

view this property online connells.co.uk/Property/PLN306772



1. MONEY LAUNDERING REGULATIONS Intending purchasers will be asked to produce identification documentation at a later stage and we would ask for your co-operation in order that there will be no delay in agreeing the sale. 2. These particulars do not constitute part or all of an offer or contract. 3. The measurements indicated are supplied for guidance only and as such must be considered incorrect. Potential buyers are advised to recheck measurements before committing to any expense. 4. We have not tested any apparatus, equipment, fixtures, fittings or services and it is in the buyers interest to check the working condition of any appliances.

Connells Residential is registered in England and Wales under company number 1489613, Registered Office is Cumbria House, 16-20 Hockliffe Street, Leighton Buzzard, Bedfordshire, LU7 1GN. VAT Registration Number is 500 2481 05.

See all our properties at www.connells.co.uk | www.rightmove.co.uk | www.zoopla.co.uk

Property Ref: PLN306772 - 0006