



## **10 King John Terrace, Newcastle Upon Tyne, NE6 5XY**

**£315 Per Week**

Available August 2026 | £105 per person per week | Hive Estates presents to the market a 3 bedroom upper floor flat to the market. The property has 3 double bedrooms and a great sized lounge area with dining space. There is a kitchen to the rear with breakfast bar area and comes fully equipped. The bathroom is modern with a bath and shower over.

Externally there is a rear yard and free on street parking.



Floor Plan

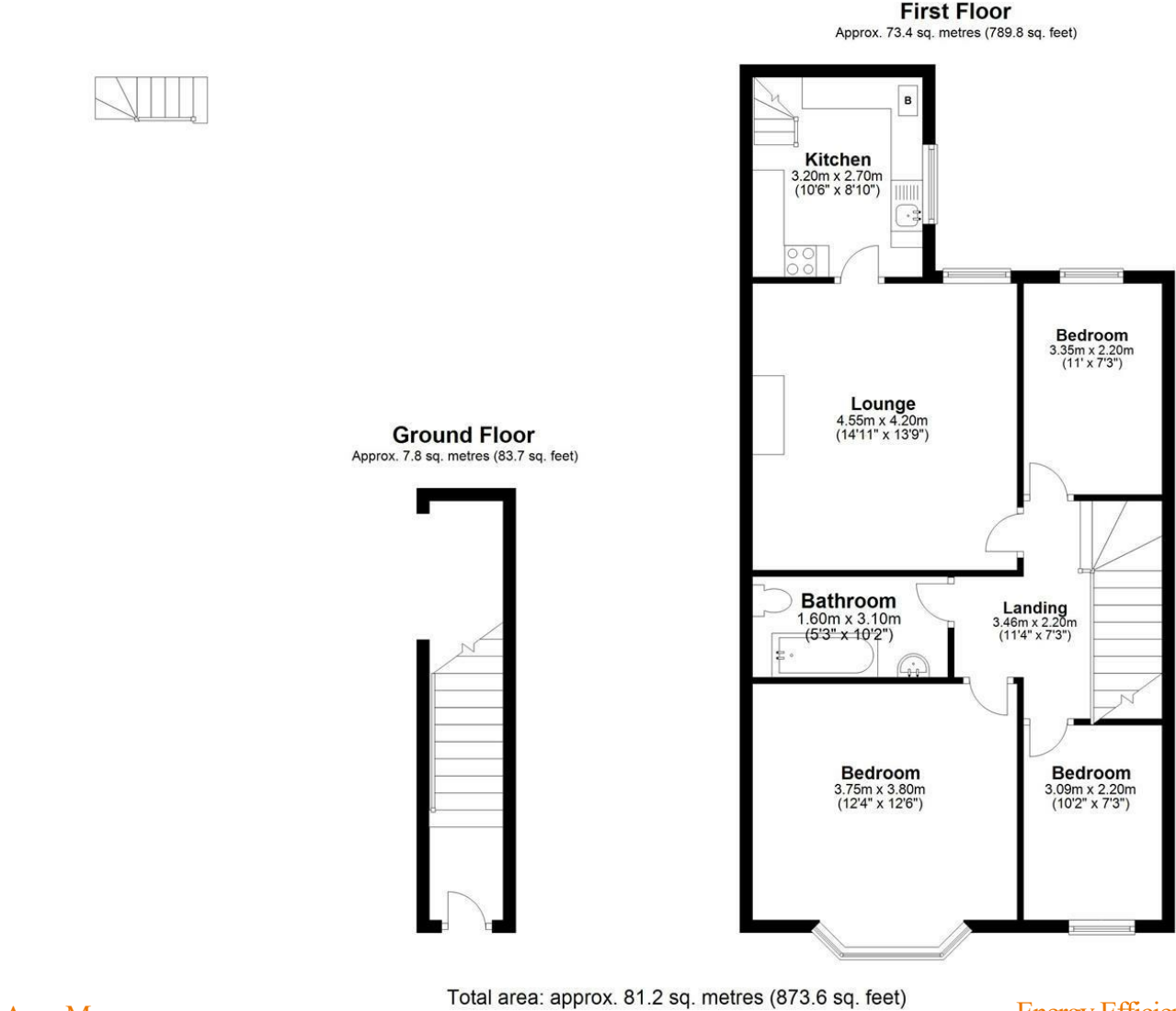

Area Map

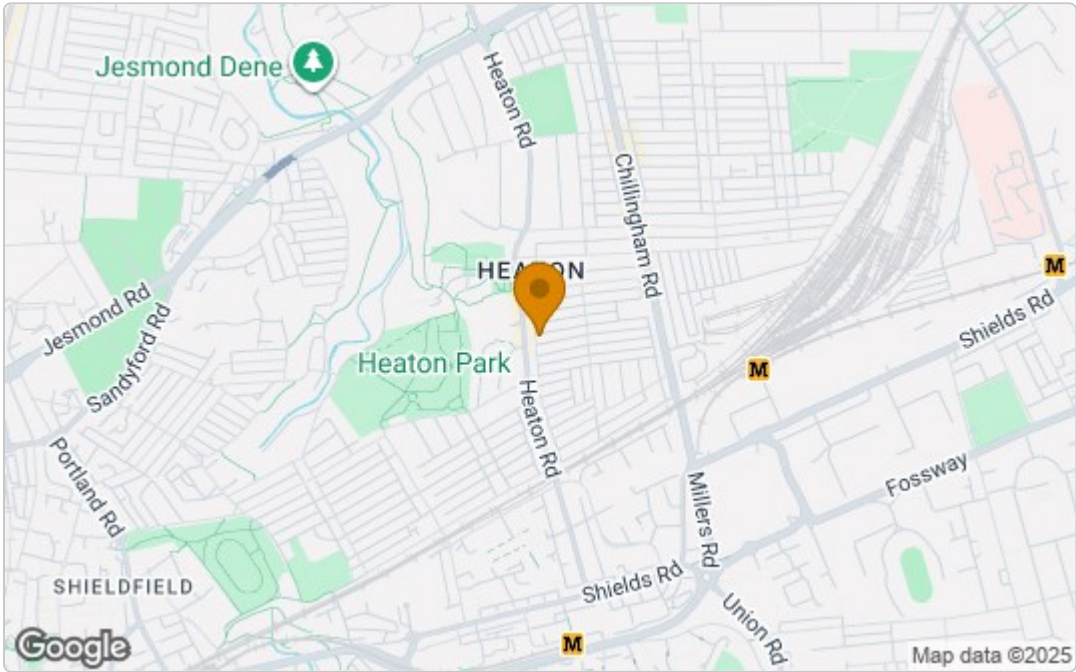

Energy Efficiency Graph

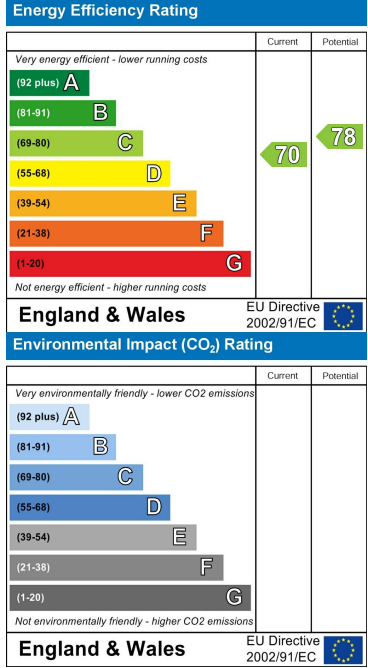

These particulars, whilst believed to be accurate are set out as a general outline only for guidance and do not constitute any part of an offer or contract. Intending purchasers should not rely on them as statements of representation of fact, but must satisfy themselves by inspection or otherwise as to their accuracy. No person in this firms employment has the authority to make or give any representation or warranty in respect of the property.