



**9 Waterside Court Portland Road, Hythe - CT21 6EF**

Guide Price **£265,000**

Approximate Gross Internal Area (Excluding Garage) = 43 sq m / 463 sq ft  
Garage = 12 sq m / 129 sq ft

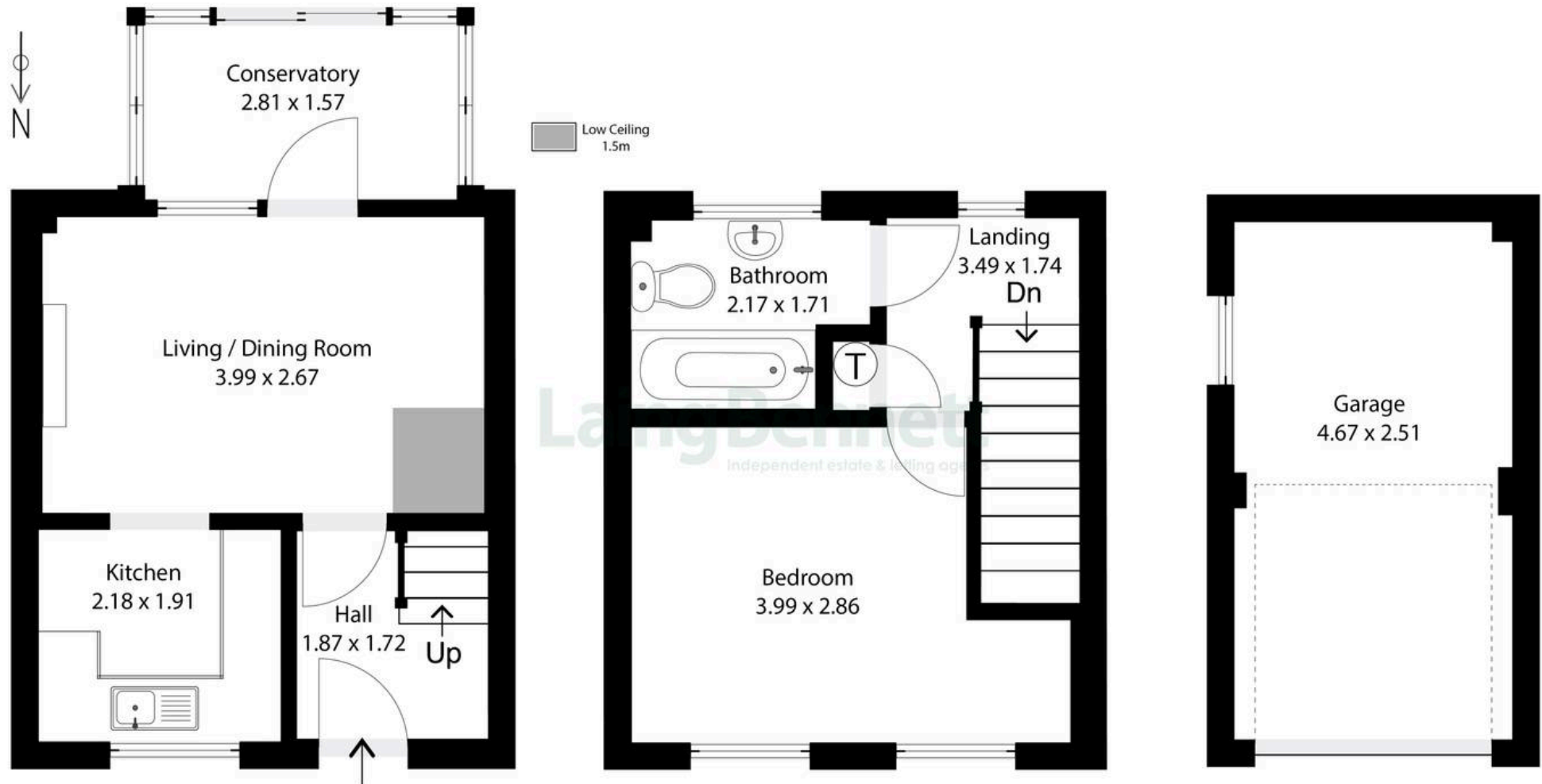

Illustration for Identification purposes only. Measurements are approximate. Dimensions given are between the widest points.

Not to scale. Outbuildings are not shown in actual location.

© Unauthorised reproduction prohibited - chriskemps@hotmail.com



## 9 Waterside Court Portland Road

Hythe, Hythe

This charming one-bedroom terraced house enjoys a highly sought-after location close to the town centre, canal, and seafront. Ideal for first-time buyers, downsizers, or investment, the home is offered with no forward chain. The accommodation comprises an entrance hall, a living/dining room with a door leading to the conservatory, and a kitchen positioned at the front of the property. Upstairs, the landing leads to a double bedroom featuring two front-facing windows overlooking the canal, along with a bathroom. Outside, the low-maintenance front garden is laid to patio, ideal for pots and practical for bin storage. The rear garden is block-paved with planted borders, with a rear gate providing direct access to the garage. A well-located home with great potential, early viewing is recommended.

Council Tax band: B

Tenure: Freehold

EPC Energy Efficiency Rating: D

EPC Environmental Impact Rating:





## Laing Bennett

Laing Bennett Ltd, The Estate Office, 8 Station Road – CT18 8HP

01303 863393

[info@laingbennett.co.uk](mailto:info@laingbennett.co.uk)

[www.laingbennett.co.uk/](http://www.laingbennett.co.uk/)

DISCLAIMER – These details are for guidance only and do not form part of an offer or contract. Measurements are approximate. Laing Bennett Ltd and the Vendor/Landlord accept no liability. Services and appliances are untested. Applicants must make their own checks. Items shown may not be included. No staff have authority to give warranties.