



## Hazel Close, TW8

£475,000



- Four Bedrooms

- One Bathroom

- First Floor

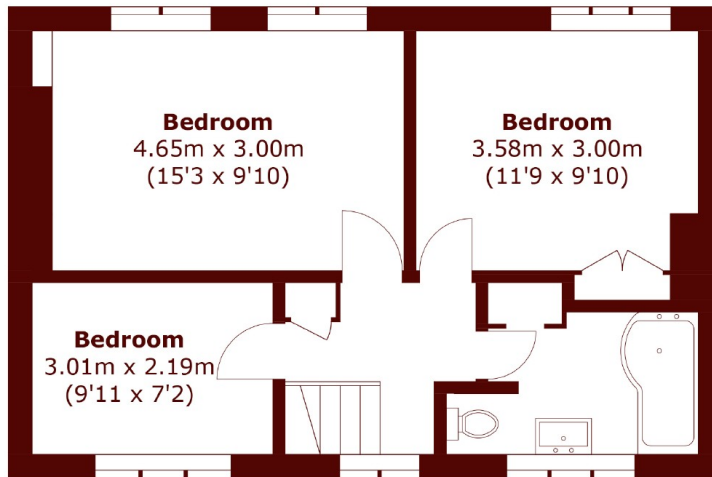

## First Floor

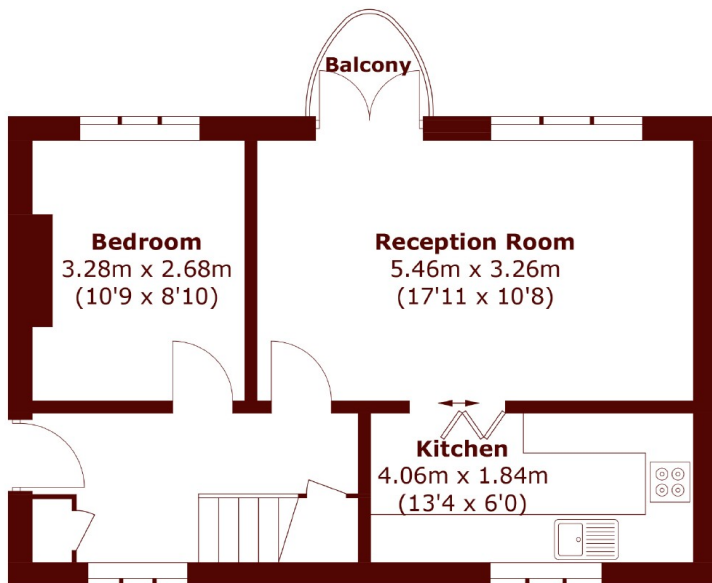

## Ground Floor

Total area (approx.): 88.1 sq. m (948.3 sq. ft)

Balcony area: 1.5 sq. m (16.1 sq. ft)

### Marsh & Parsons Chiswick

34-38 Turnham Green  
Terrace, London, W4 1QP  
020 8994 2556