



**Little Orchard Pea Lane, Northchurch Berkhamsted HP4 3SX**



A beautifully extended and impeccably presented four-bedroom detached bungalow, occupying a prime position on one of Northchurch's most sought-after no through roads. Offering spacious and versatile accommodation throughout, Little Orchard combines stylish modern living with a peaceful countryside setting, all within a short drive, or a level walk of Berkhamsted High Street and mainline station.

This exceptional home has been thoughtfully extended and maintained to an immaculate standard. The welcoming entrance leads to a stunning open-plan kitchen/breakfast room featuring a beautifully bespoke fitted kitchen, creating the perfect heart of the home for both family living and entertaining. A separate utility room provides additional practicality. The spacious lounge is a wonderful place to relax, centred around a striking log-burning stove and enjoying a warm, inviting atmosphere. The property offers four generous double bedrooms, with the impressive principal bedroom benefiting from a stylish en-suite bathroom and a separate walk-in wardrobe. Bedroom three also enjoys the convenience of its own separate W/C, while a modern shower room serves the remaining accommodation.

#### **Outside**

Externally, the beautifully landscaped and enclosed rear garden is a true standout feature, offering a wonderful degree of privacy with attractive patio areas ideal for outdoor entertaining as well as a fenced and gated kitchen garden. The front entrance has been professionally designed and landscaped including a feature raised patio with built-in lighting and raised planters. Little Orchard also benefits from solar panels with battery storage, which can significantly reduce energy bills.





## welcome to Little Orchard Pea Lane, Northchurch Berkhamsted

- Beautifully extended four-bedroom detached bungalow
- Immaculate condition throughout
- Stunning bespoke open-plan kitchen/breakfast room
- Spacious lounge with feature log-burning stove
- Principal suite with en-suite and walk-in wardrobe

Tenure: Freehold EPC Rating: C  
Council Tax Band: E

# £1,000,000

Situated in an idyllic location with delightful countryside views, this exceptional home offers the perfect balance of semi-rural living while remaining conveniently close to the amenities, restaurants and transport links of Berkhamsted.

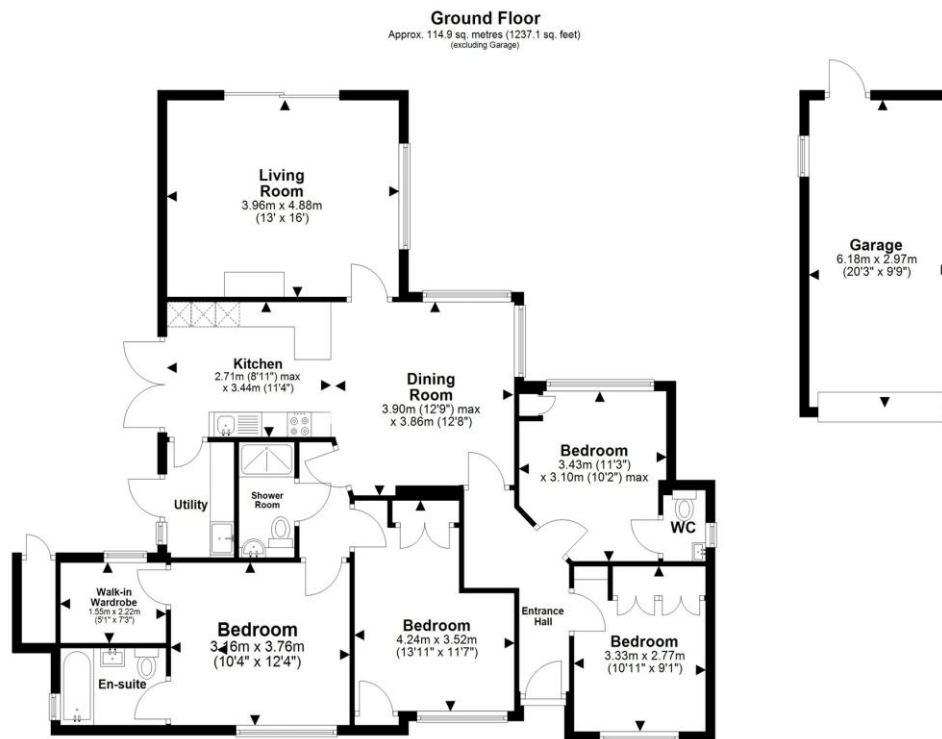

The Floor Plan is not to Scale and measurements and areas shown are approximate and therefore should be used for illustrative purposes only. The plan has been prepared with due diligence and whilst we have confidence in the information produced it should not be relied upon. Maximum lengths and widths are represented on the plan. If there are any aspects of particular importance, you should carry out or commission your own inspection of the property. Copyright © SKMSTUDIO

Plan produced using PlanUp. □

**check out more properties at** [brownandmerry.co.uk](https://www.brownandmerry.co.uk)  
**see all our properties on** [zoopla.co.uk](https://www.zoopla.co.uk) | [rightmove.co.uk](https://www.rightmove.co.uk) | [sequencehome.co.uk](https://www.sequencehome.co.uk)



Property Reference:  
BKH103345 - 0004

1. MONEY LAUNDERING REGULATIONS Intending purchasers will be asked to produce identification documentation at a later stage and we would ask for your co-operation in order that there is no delay in agreeing the sale. 2. These particulars do not constitute part or all of an offer or contract. 3. The measurements indicated are supplied for guidance only and as such must be considered incorrect. Potential buyers are advised to recheck measurements before committing to any expense. 4. We have not tested any apparatus, equipment, fixtures or services and it is in the buyers interest to check the working condition of any appliances. 5. Where an EPC, or a Home Report (Scotland only) is held for this property, it is available for inspection at the branch by appointment. If you require a printed version of a Home Report, you will need to pay a reasonable production charge reflecting printing and other costs. 6. We are not able to offer an opinion either written or verbal on the content of these reports and this must be obtained from your legal representative. 7. Whilst we take care in preparing these reports, a buyer should ensure that his/her legal representative confirms as soon as possible all matters relating to title including the extent and boundaries of the property and other important matters before exchange of contracts.



**01442 870444**



[berkhamsted@brownandmerry.co.uk](mailto:berkhamsted@brownandmerry.co.uk)



124 High Street, BERKHAMSTED,  
Hertfordshire, HP4 3AT



[brownandmerry.co.uk](https://www.brownandmerry.co.uk)