



ROSS BURBIDGE



@ ross.burbidge@exp.uk.com

 rossburbidge.exp.uk.com

 07792 512 628

2 Grove Mews, Grove Street, Cheltenham, GL50

£285,000

🛏️ 2 🚿 1 🚗 1



Please Quote: RB1393-Ross Burbidge. This stylish, purpose-built modern home is ideally suited to a professional couple and enjoys a highly convenient location close to Waitrose supermarket and within easy walking distance of Cheltenham Spa railway station via the popular Honeybourne Line. Finished to a high standard throughout, the property offers a wealth of quality features including underfloor heating, branded integrated appliances and contemporary glass balustrades to the staircase and landing.

The accommodation begins with a welcoming entrance hall and a downstairs cloakroom, leading into an impressive open-plan living space that combines a modern fitted kitchen with a bright and comfortable sitting and dining area. The kitchen is well equipped with an integrated fridge/freezer, dishwasher, electric hob and oven, along with plumbing for a washing machine. French patio doors open directly onto the rear garden, creating an excellent flow between indoor and outdoor living.

To the first floor are two well-proportioned double bedrooms and a modern family bathroom. The principal bedroom further benefits from its own en-suite shower room, providing added convenience and privacy.

Outside, the property offers dedicated off-street parking via a single integral carport, while to the rear is a fully enclosed private garden, ideal for relaxing or entertaining. Overall, this is a superbly presented home in a sought-after location, combining modern design with practical living.



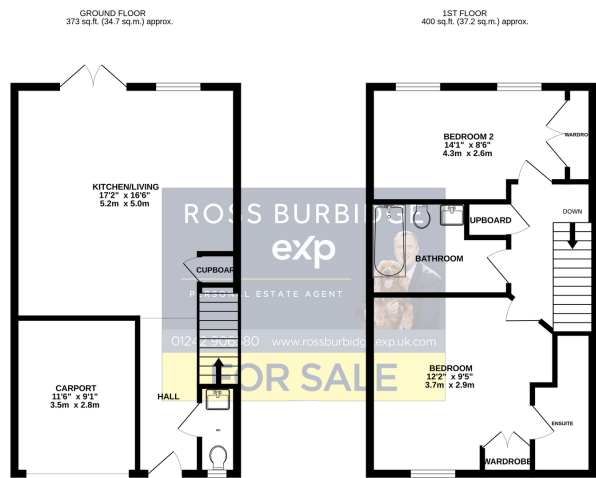

- Two Bedroom Mews House
- Town Centre
- Enclosed Private Garden
- Perfect Airbnb
- Town Centre Location
- Please Quote: RB1393-Ross Burbidge
- Modern Family Bathroom
- Integrated Fridge/Freezer And Dishwasher
- Car-Port
- Gas Central Heating

