



Hurworth Springs Country Park, Neasham Road, Hurworth Moor, Darlington, DL2 1PY

£240,000

🛏 2 🚿 2 🛋 1



- Detached Park Home Lodge
- Two Double Bedrooms
- Site Fees Paid Until March 2026
- Wonderful Countryside Views
- Decked Patio Area
- Generous Corner Plot
- Residential Park
- Driveway Parking
- Immaculately Presented
- No Stamp Duty To Pay



A stunning two double bedroom, 50ft park home lodge occupying a generous plot on the outskirts of this sought after gated residential park for the over 45's. This spacious home boasts a lounge measuring over 21ft in length with large windows and doors which boast wonderful views over open countryside, a modern, fitted kitchen with integrated appliances, vaulted ceilings, separate WC, utility room, dining room and two double bedrooms with both having built in wardrobes and ensuites. There are corner plot, lawned gardens to the front, side and the rear which backs onto fields and there is plenty of room on the driveway for multiple cars.

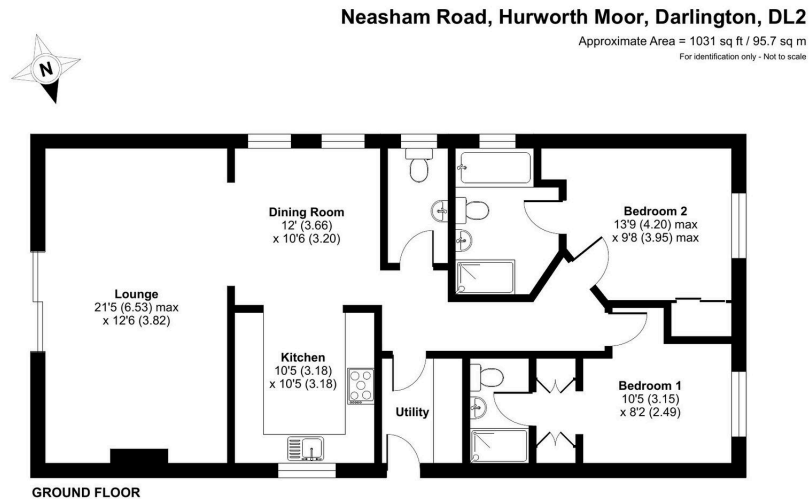

Floor plan produced in accordance with RICS Property Measurement 2nd Edition, incorporating International Property Measurement Standards (IPMS2 Residential). © richvecom 2025. Produced for The Park Home Agency Ltd. REF: 1331133



01793 230185
sales@theparkhomeagency.co.uk

Agents Notes: All measurements are approximate and quoted in metric with imperial equivalents and for general guidance only and whilst every attempt has been made to ensure accuracy, they must not be relied on. The fixtures, fittings and appliances referred to have not been tested and therefore no guarantee can be given that they are in working order. Internal photographs are reproduced for general information and it must not be inferred that any item shown is included with the property. For a free valuation, contact the numbers listed on the brochure