



Marlborough Hill

St John's Wood, NW8

Asking Price £950,000

Joint Sole Agent. A superb two-bedroom, two-bathroom apartment located on the top floor (with lift) of this modern building in Marlborough Hill.

The property boasts a 20ft reception/dining room with far reaching westerly views of London, 2 double bedrooms (1 en suite), family bathroom and a fully fitted kitchen.

The apartment further benefits from an underground parking space and is approximately half a mile from St John's Wood Underground station (Jubilee Line).

CHESTERTONS



Marlborough Hill

St John's Wood, NW8

- 2 Bedrooms, 2 Bathrooms
- Very Long Leasehold
- 975 sq. ft.
- Allocated Parking Space
- Lift



Tenure: Leasehold

Service Charge: £6,358pa (Includes £1,846pa into the sinking fund).

Ground Rent: £300pa

Local Authority: Westminster

Council Tax Band: G

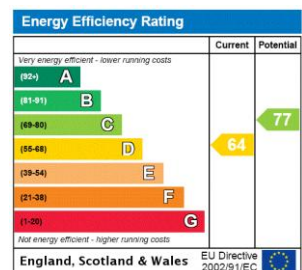

Chestertons St John's Wood Sales

105 St. John's Wood Terrace

London

NW8 6PL

stjohnswood@chestertons.co.uk

020 3040 8611

chestertons.co.uk

**Marlborough Hill,
St. Johns Wood, NW8**

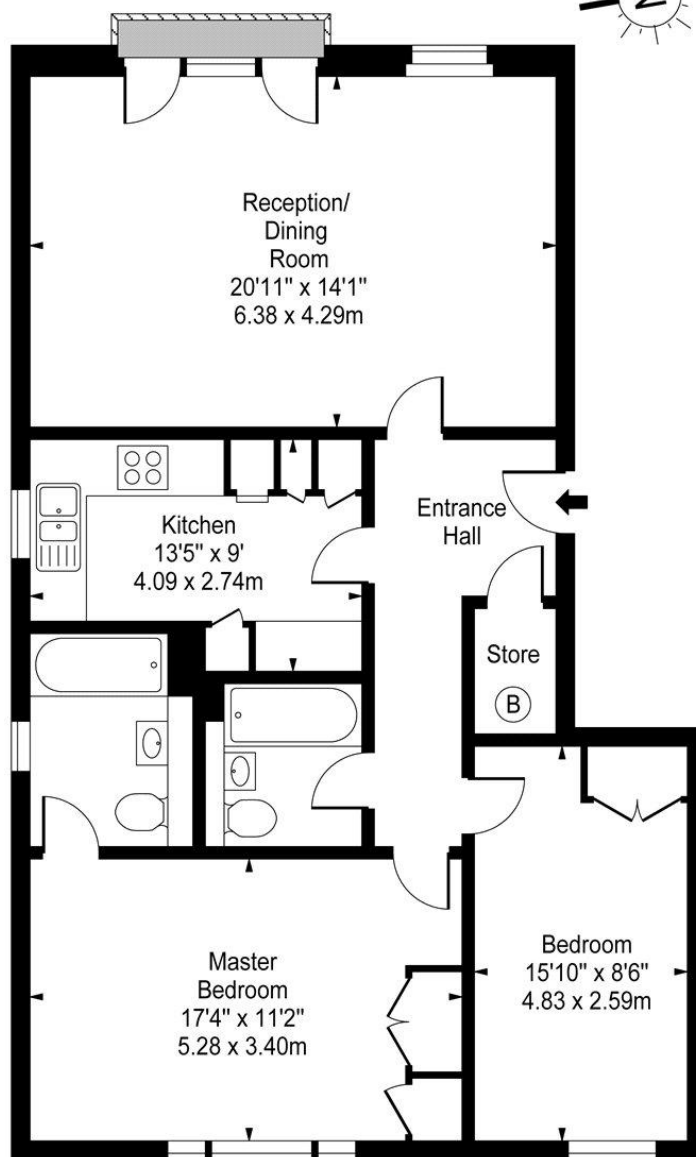
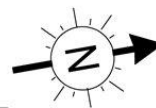

Third Floor

Approx Gross Internal Area 975 Sq Ft - 90.58 Sq M

For Illustration Purposes Only - Not To Scale

www.goldlens.co.uk

Produced for Chestertons

Ref. No. 001351

