



**164 Blackamoor Lane, Maidenhead SL6 8RT**

**welcome to**

**164 Blackamoor Lane, Maidenhead**

An attractive three bedroom, two bathroom period semi-detached family home, skilfully extended and improved upon to create a blend of character and contemporary living. No onward chain.





## Blackamoor Lane, Maidenhead, SL6

Approximate Area = 1126 sq ft / 104.6 sq m

Limited Use Area(s) = 15 sq ft / 1.3 sq m

Store = 81 sq ft / 7.5 sq m

Total = 1222 sq ft / 113.4 sq m

For identification only - Not to scale

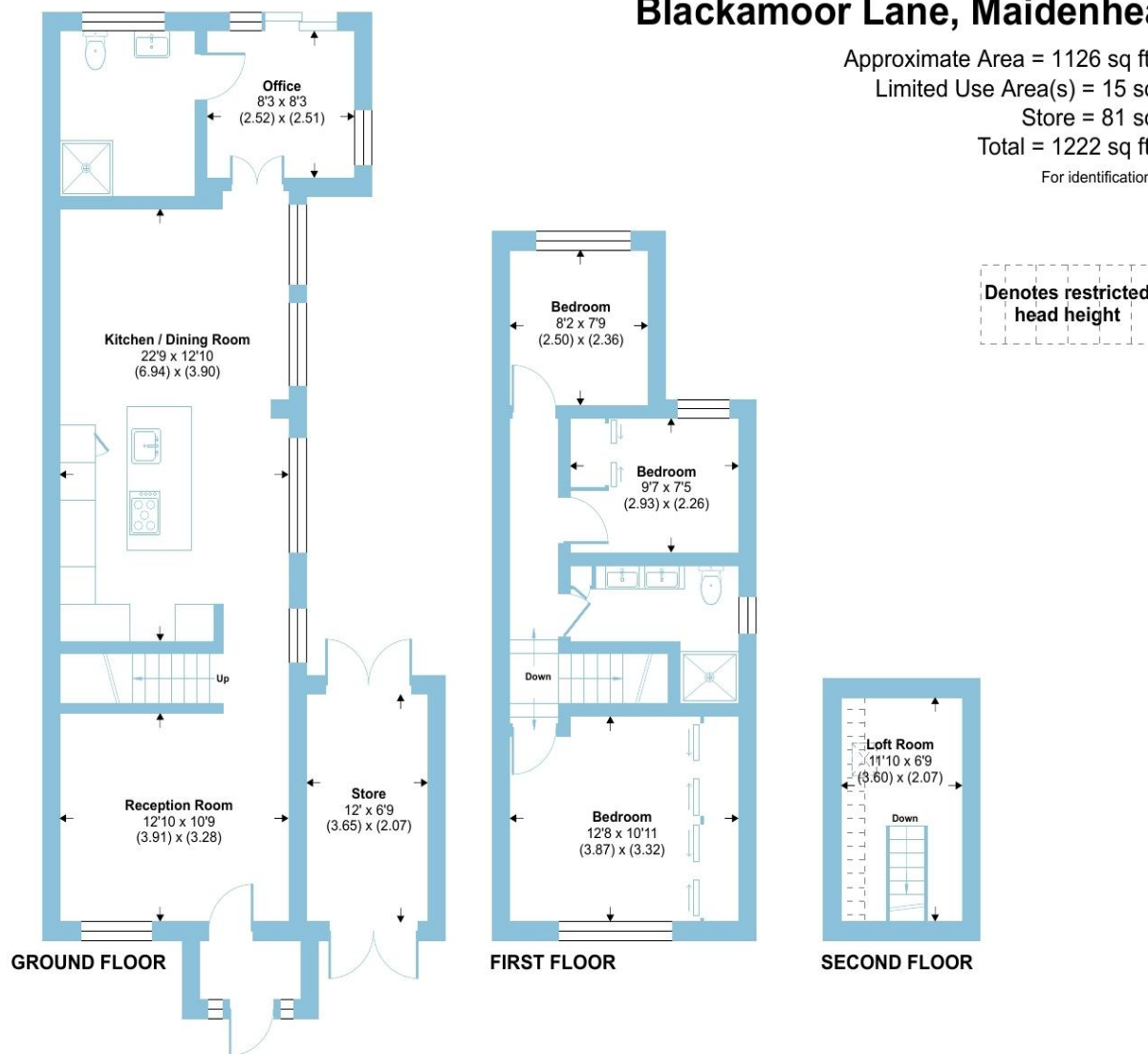

The property has been vastly updated & improved upon by the current owners and is accessed via an enclosed entrance porch and then into the light, bright living room; this in turn leads into the fantastic kitchen/dining/family area with a bespoke high-end fitted kitchen with quality integrated appliances and ample units at eye & base level with fabulous work-surface areas - an ideal space for family and entertaining. From here, there is a study area and a modern shower room and utility space.

Upstairs, there is a sizeable main bedroom and two further double bedrooms - and from the landing, there is a pull-down ladder accessing the bonus loft room - ideal for a play-room or study area. Completing the first floor is the modern family bathroom.

The rear garden is a great space for alfresco dining, with a large decked terrace and a feature bridge over the water feature to a second decked terrace. There is a lawn and the garden provides a good degree of seclusion. There is off-street parking to the front for two cars.

welcome to

## 164 Blackamoor Lane, Maidenhead

- EXTENDED SEMI-DETACHED HOME
- EXCELLENT CONDITION THROUGHOUT
- THREE BEDROOMS
- TWO BATHROOMS
- LOVELY GARDEN
- DRIVEWAY PARKING
- EASY ACCESS TO TOWN CENTRE & STATION
- NO ONWARD CHAIN

Tenure: Freehold EPC Rating: D

Council Tax Band: D

guide price

**£625,000**



check out more properties at [rogerplatt.co.uk](https://rogerplatt.co.uk)

Please note the marker reflects the postcode not the actual property



Property Ref:  
MHD122927 - 0005

1. MONEY LAUNDERING REGULATIONS Intending purchasers will be asked to produce identification documentation at a later stage and we would ask for your co-operation in order that there is no delay in agreeing the sale. 2. These particulars do not constitute part or all of an offer or contract. 3. The measurements indicated are supplied for guidance only and as such must be considered incorrect. Potential buyers are advised to recheck measurements before committing to any expense. 4. We have not tested any apparatus, equipment, fixtures or services and it is in the buyers interest to check the working condition of any appliances. 5. Where an EPC, or a Home Report (Scotland only) is held for this property, it is available for inspection at the branch by appointment. If you require a printed version of a Home Report, you will need to pay a reasonable production charge reflecting printing and other costs. 6. We are not able to offer an opinion either written or verbal on the content of these reports and this must be obtained from your legal representative. 7. Whilst we take care in preparing these reports, a buyer should ensure that his/her legal representative confirms as soon as possible all matters relating to title including the extent and boundaries of the property and other important matters before exchange of contracts.

Roger Platt is a trading name of Sequence (UK) Limited which is registered in England and Wales under company number 4268443, Registered Office is Cumbria House, 16-20 Hockliffe Street, Leighton Buzzard, Bedfordshire, LU7 1GN. VAT Registration Number is 500 2481 05.

roger platt



**01628 773333**



Maidenhead@rogerplatt.co.uk



25-29 Queen Street, MAIDENHEAD, Berkshire,  
SL6 1NB



**rogerplatt.co.uk**