





137 Fontygary Road, Rhoose

Council Tax: E; Freehold; EPC E50

- UNIQUE OPPORTUNITY
- BUY AS IS OR BUY WHEN REFURBISHED
- LARGE LIVING ROOM WITH FRENCH DOORS
- 2 DOUBLE BEDROOMS & BATHROOM SPACE
- DINING ROOM OPEN TO THE KITCHEN
- EXTENDED TO THE REAR ELEVATION
- LOVELY GARDEN; GARAGE; NO CHAIN
- DETACHED BUNGALOW WITH CHANNEL VIEWS

The bungalow is currently work in progress and is available to purchase NOW at a discounted price, or when the full refurbishment has been completed at the advertised £450,000.

The accommodation is versatile and can be changed to suit the buyer's requirements. A mix of three bedrooms and a main living space, or perhaps two bedrooms plus two receptions and a kitchen. There are great options to consider.

Situated on the channel side of Fontygary Road, this detached bungalow has been extended to the rear. It currently comprises a central hall with 2 bedrooms to the front, a middle bathroom space and to the rear is the extended living room, plus dining room/sitting room which leads to the kitchen. There is a large loft area with side Velux accessed via pull down ladder. There is a long drive which leads to a detached garage and a delightful SOUTHERLY ASPECT rear garden. The property has uPVC windows and is available with no onward chain.

The amenities of the Village including the Fontygary complex, Raj Kinara and beaches plus Tesco and local shops are all within striking





Entrance Hall

Accessed via a covered storm porch and then through an original door with stained glazing. Access to the living room, dining / sitting room (this leads to the kitchen), bathroom / WC and the two double bedrooms.

Living Room

25' 0" x 13' 10" (7.61m x 4.21m)

An extended room over two levels. Side uPVC double glazed window and French style uPVC doors lead out onto the enclosed South facing garden and also there are fabulous Channel views.

Dining / Sitting Room

16' 3" x 9' 10" (4.95m x 2.99m)

With a side uPVC window, two storage cupboards and there is open access - via two steps - to the kitchen extension.

Kitchen

12' 5" x 8' 5" (3.78m x 2.56m)

With a selection of eye level and base units, rear uPVC window offering fabulous Channel views.

Bedroom One

14' 10" x 9' 11" (4.52m x 3.02m)

A double bedroom with front uPVC window.

Bedroom Two

10' 1" x 9' 7" (3.07m x 2.92m)

A double bedroom with front uPVC window.

Bathroom / WC

6' 3" x 5' 3" (1.90m x 1.60m)

With an obscure glazed uPVC window.

Informal Loft Room

13' 0" x 10' 6" (3.96m x 3.20m)

Accessed via pull down ladder in the hallway. Side Velux window. An ideal room for a conversion and with the benefit of a rear Velux where the views would be fantastic.





REAR GARDEN

60' 11" x 36' 12" (18.58m x 11.27m)

A beautiful rear garden which is primarily laid to lawn and borders are flanked with established shrubs and plants. Enjoys a Southerly aspect and sea views from the raised patio.

FRONT GARDEN

Nicely maintained with level lawn which is flanked by established plants and shrubs. There is a patio area adjacent to the property. Adjoining the driveway.

GARAGE

Single Garage

Dimensions: 20' 1" x 9' 11" (6.12m x 3.02m). Block built and with power and lighting. Accessed via up and over door and there is a uPVC double glazed window to the rear.

DRIVEWAY

5 Parking Spaces

Extending to the side of the bungalow, leading to the garage and providing off road parking for up to 5 vehicles.





137 Fontygary Road

Approximate Gross Internal Area
1055 sq ft - 98 sq m

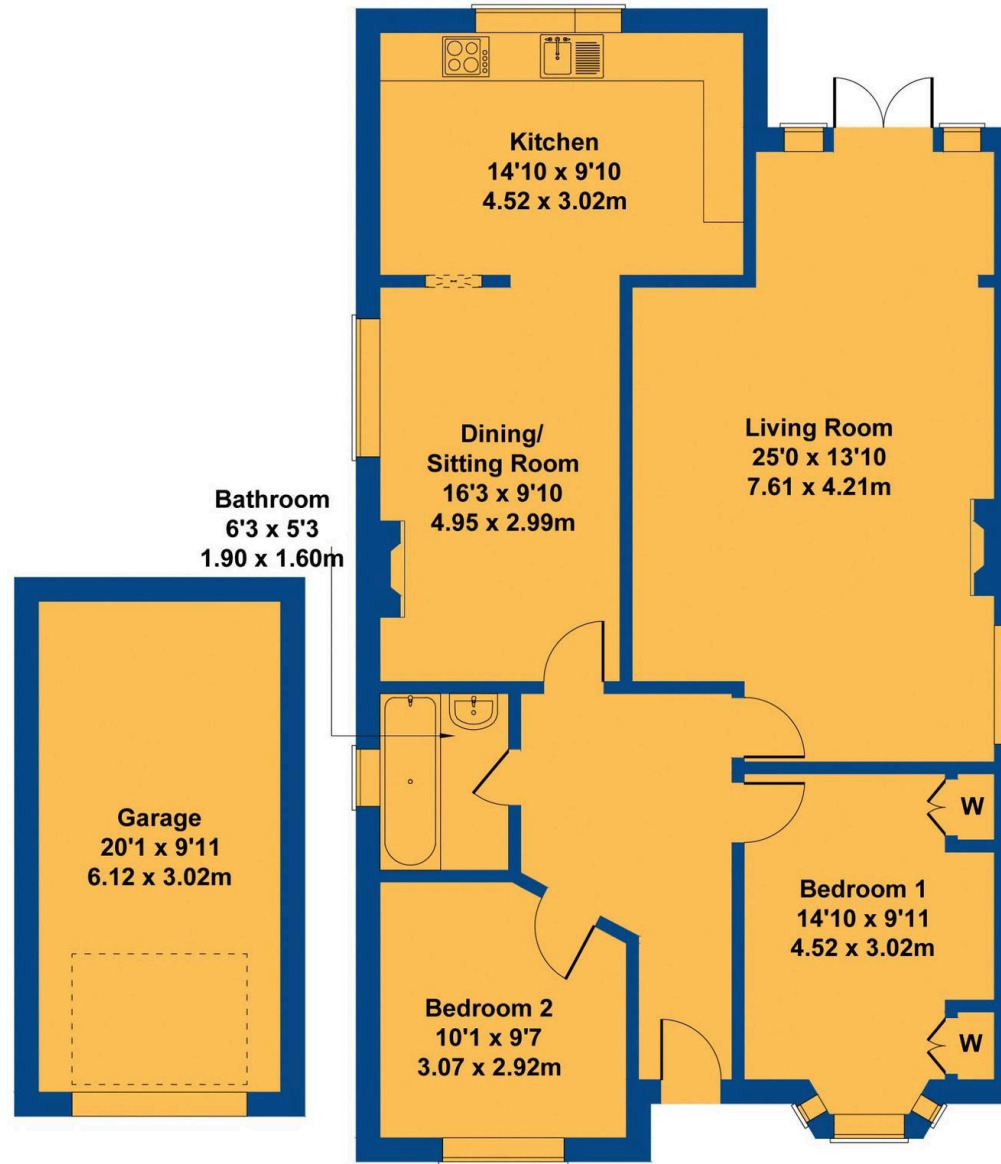

GARGAE

Not to Scale. Produced by The Plan Portal 2023
For Illustrative Purposes Only.



Chris Davies Estate Agents

Chris Davies Estate Agents, 29 Fontygary Road – CF62 3DS

01446 711900

rhoose@chris-davies.co.uk

www.chris-davies.co.uk/

HELPFUL INFORMATION – whilst we try to ensure our sales particulars are complete, accurate and reliable, if there is any point which is particularly important, please ask and we will be happy to check it, including specific information in respect of commuting links, surroundings, noise, views, or condition. For security purposes, applicants who wish to view will need to provide their name, address and telephone number. All measurements are approximate to the widest and longest points. Buyers are advised to instruct a solicitor to obtain verification of tenure and a surveyor to check that appliances, installations and services are in satisfactory condition.