



Honeysuckle Drive, PL19

Guide Price £330,000

3 2 1



- Very well presented semi-detached property
- Master Ensuite, Family Bathroom & Downstairs Cloakroom
- Separate Lounge
- Driveway Parking
- Level Rear Garden & Patio
- Three bedrooms
- Kitchen/Dining Room overlooking rear Garden
- Fitted Wardrobes in each Bedroom
- Close to Local Bus Routes
- Ready to Move Into!



This very well-presented semi-detached home offers spacious accommodation ideal for modern family living. The property was constructed circa 2022 by Cavanna Homes and features three bedrooms all with fitted wardrobes, including a main bedroom with en-suite, a well-equipped Kitchen/Dining room that has French doors leading out to the patio area and level lawned garden, a separate Lounge and downstairs cloakroom. The property has private driveway parking for several vehicles and a side gate that leads through to the rear garden with generous patio area, raised beds and two timber storage sheds. Ready to move into!

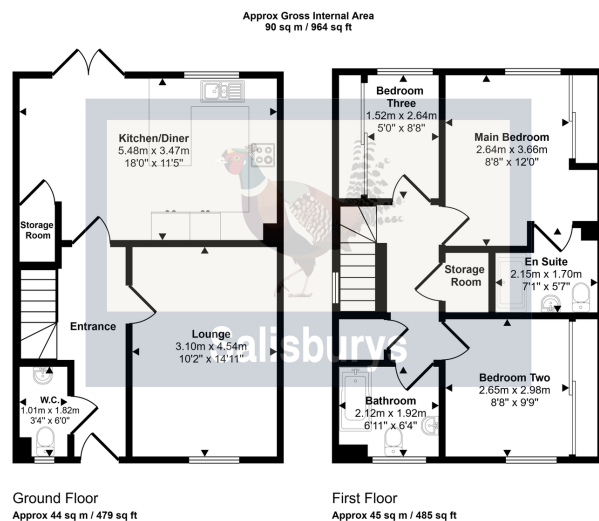

This floorplan is only for illustrative purposes and is not to scale. Measurements of rooms, doors, windows, and any items are approximate and no responsibility is taken for any error, omission or mis-statement. Icons of items such as bathroom suites are representations only and may not look like the real items. Made with Made Snappy 360.

Score	Energy rating	Current	Potential
92+	A		96 A
81-91	B	85 B	
69-80	C		
55-68	D		
39-54	E		
21-38	F		
1-20	G		

