





PATER STREET LONDON W8
£3,000 PER MONTH AVAILABLE 10/03/2026

Hamptons
THE HOME EXPERTS

{ THE PARTICULARS

Pater Street London W8

£3,000 Per Month
Unfurnished

-  2 Bedrooms
-  2 Bathrooms
-  1 Reception

Features

- Two Bedrooms, - Two Bathrooms, -
Modern Kitchen, - Communal Garden, -
Unfurnished, - Excellent location, - Pets
Considered

Council Tax

Council Tax Band F

Hamptons
8 Hornton Street
Kensington, London, W8 4NW
020 7937 9372
KensingtonLettings@hamptons.co.uk
www.hamptons.co.uk

{ A BEAUTIFULLY PRESENTED TWO BED APARTMENT WITH COMMUNAL GARDEN

The Property

A beautifully presented two bedroom two bathroom apartment set on the lower ground floor of this mansion block in Kensington. The apartment comprises modern eat-in kitchen, good size reception room, principal bedroom with en-suite bathroom, second bedroom and family bathroom. There is direct access to a private outside area at the front of the building and to the building communal garden at the back of the building. The apartment is offered unfurnished.

Location

Warwick Chambers is located moments from the amenities and transport links of Kensington High Street (Circle & District lines).



WARWICK CHAMBERS

Approximate Gross Internal Area
 Lower Ground Floor = 957 Sq. Ft. (88.9 Sq. M.)
 Ground Floor = 27 Sq. Ft. (2.5 Sq. M.)
 Total = 984 Sq. Ft. (91.4 Sq. M.)

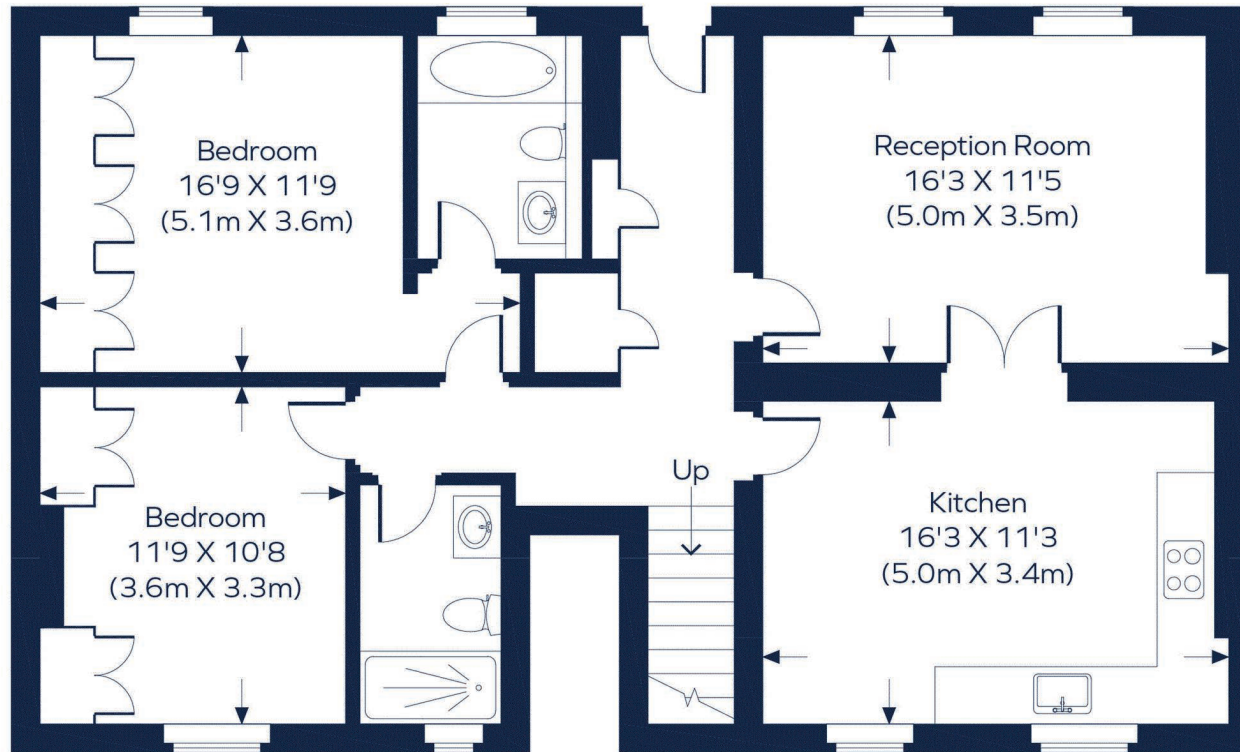

Lower Ground Floor

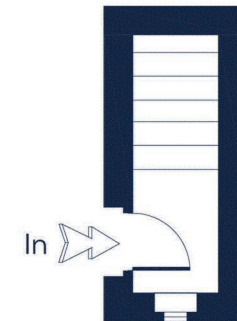

Ground Floor

This plan is for layout guidance only. Not drawn to scale unless stated. Windows and door openings are approximate. Whilst every care is taken in the preparation of this plan, please check all dimensions, shapes and compass bearings before making any decisions reliant upon them.
 ID 1274682

For Clarification

We wish to inform prospective tenants that we have prepared these particulars as a general guide and they have been confirmed as accurate by the landlord. We have not verified permissions, nor carried out a survey, tested the services, appliances and specific fittings. Room sizes are approximate and measurement figures rounded: they are taken between internal wall surfaces and therefore include cupboards/shelves, etc. Accordingly, they should not be relied upon for

carpets and furnishings. It should also be noted that all fixtures and fittings, carpeted, curtains/blinds, kitchen equipment and garden statuary, whether fitted or not, are deemed removable by the landlord unless specifically itemised with these particulars. Please enquire in office or on our website for details on holding deposit and tenancy deposit figures.

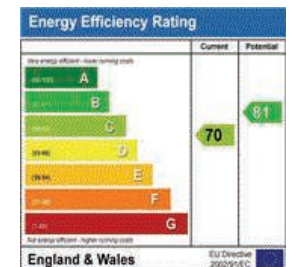



Awaiting Photograph