



Grainger Gardens, Southampton SO19 0SD

welcome to

Grainger Gardens, Southampton

* TWO BEDROOM END OF TERRACE HOUSE * MODERN & BEAUTIFULLY PRESENTED THROUGHOUT * SPACIOUS LOUNGE/DINER * FITTED KITCHEN & BATHROOM * LOW MAINTENANCE REAR GARDEN * DRIVEWAY * CLOSE TO LOCAL AMENITIES, SCHOOLS & GREAT TRANSPORT LINKS *

Front Garden

Driveway with enough parking for one/two cars, steps down to access, outside cupboard.

Entrance Hall

Access to all rooms, stairs to first floor.

Lounge

24' 9" x 13' 8" (7.54m x 4.17m)

Laminate flooring, double glazed window to the front aspect, under stairs storage, space for dining table and chairs.

Kitchen

13' 8" x 7' (4.17m x 2.13m)

Wall and base cupboard units, sink and drainer, electric oven/hob, overhead extractor, tiled walls, gas radiator, access to garden.

Bedroom One

12' 2" x 11' 1" (3.71m x 3.38m)

Carpeted, double glazed window to the front aspect, freestanding wardrobe.

Bedroom Two

12' 7" x 8' 6" (3.84m x 2.59m)

Carpeted, double glazed window to the rear aspect, freestanding wardrobe.

Bathroom

Bath with overhead shower, low level w/c, wash hand basin, tiled walls, heated towel rail, double glazed window to the rear aspect.

Rear Garden

Patio area, shed, low maintenance turf.





This beautifully presented two-bedroom end of terrace home offers modern living in a highly convenient location, making it an ideal purchase for first-time buyers, small families, or investors.

The ground floor boasts a spacious and stylish lounge/diner, providing the perfect space for both relaxing and entertaining. This leads through to a contemporary fitted kitchen, finished to a high standard and offering both functionality and modern appeal. Upstairs, the property features two well-proportioned bedrooms, along with a modern family bathroom, all maintained to an excellent standard throughout.

Externally, the property benefits from a low-maintenance, well-presented rear garden, ideal for enjoying outdoor space with minimal upkeep. To the front, there is off-road parking for two vehicles.

Situated close to local amenities, well-regarded schools, and offering excellent access to the M27, the property is perfectly positioned for commuters and families alike. An ideal home in a desirable location – early viewing is highly recommended to avoid disappointment.



view this property online fox-and-sons.co.uk/Property/BIT113224



welcome to

Grainger Gardens, Southampton

- End of Terrace House
- Two Bedrooms
- Beautifully Presented Throughout
- Modern Fitted Kitchen & Bathroom
- Generous Lounge/Diner

Tenure: Freehold EPC Rating: E
Council Tax Band: B

£260,000

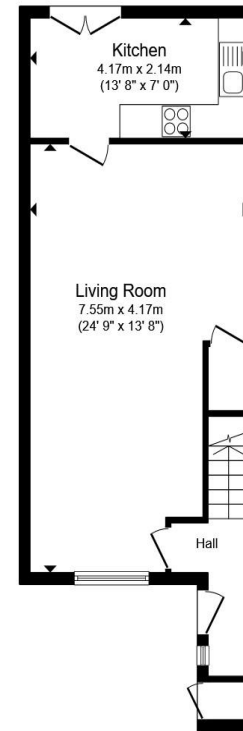

Ground Floor

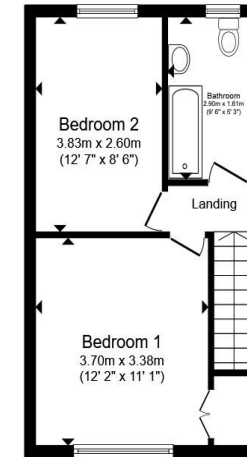

First Floor

Total floor area 77.0 m² (829 sq.ft.) approx

This floor plan is for illustrative purposes only. It is not drawn to scale. Any measurements, floor areas (including any total floor area), openings and orientation are approximate. No details are guaranteed, they cannot be relied upon for any purpose and they do not form part of any agreement. No liability is taken for any error, omission or misstatement. A party must rely upon its own inspection(s). Powered by www.propertybox.io



view this property online fox-and-sons.co.uk/Property/BIT113224



Property Ref:
BIT113224 - 0002

1. MONEY LAUNDERING REGULATIONS Intending purchasers will be asked to produce identification documentation at a later stage and we would ask for your co-operation in order that there is no delay in agreeing the sale. 2. These particulars do not constitute part or all of an offer or contract. 3. The measurements indicated are supplied for guidance only and as such must be considered incorrect. Potential buyers are advised to recheck measurements before committing to any expense. 4. We have not tested any apparatus, equipment, fixtures or services and it is in the buyers interest to check the working condition of any appliances. 5. Where an EPC, or a Home Report (Scotland only) is held for this property, it is available for inspection at the branch by appointment. If you require a printed version of a Home Report, you will need to pay a reasonable production charge reflecting printing and other costs. 6. We are not able to offer an opinion either written or verbal on the content of these reports and this must be obtained from your legal representative. 7. Whilst we take care in preparing these reports, a buyer should ensure that his/her legal representative confirms as soon as possible all matters relating to title including the extent and boundaries of the property and other important matters before exchange of contracts.

Fox & Sons is a trading name of Sequence (UK) Limited which is registered in England and Wales under company number 4268443, Registered Office is Cumbria House, 16-20 Hockliffe Street, Leighton Buzzard, Bedfordshire, LU7 1GN. VAT Registration Number is 500 2481 05.



023 8044 6724



Bitterne@fox-and-sons.co.uk



390c Bitterne Road, Bitterne, SOUTHAMPTON,
Hampshire, SO18 5RS



fox-and-sons.co.uk