

24 Brattice Way,
Mapplewell S75 6GX

OFFERS OVER
£200,000



TUCKED AWAY ON THIS POPULAR RESIDENTIAL DEVELOPMENT THIS FABULOUSLY PRESENTED TWO DOUBLE BEDROOM SEMI-DETACHED PROPERTY WHICH OFFERS STYLISH, MODERN OPEN PLAN LIVING. IT BOASTS A SUPERB ENCLOSED REAR GARDEN WITH BI FOLD DOORS FROM THE LIVING AREA. THERE IS A GROUND FLOOR WC, UTILITY CUPBOARD AND OFF ROAD PARKING FOR TWO CARS.

FREEHOLD (ESTATE MANAGEMENT FEES APPLY) / COUNCIL TAX BAND B / ENERGY RATING B

PAISLEY
PROPERTIES

HALL 7'10" apx x 7'1" apx



You enter the property through a composite front door into this spacious area with plenty of room to remove shoes and coats. There is ample natural light via the double glazed panel to the side of the door with obscure glass. There is a wall mounted radiator, pendant lighting and internal doors to the ground floor WC and open plan living area. A staircase leads to the first floor landing.

GROUND FLOOR WC 5'2" apx x 4'11" apx



Well proportioned ground floor WC having a two piece suite consisting of a wall mounted wash basin with mixer tap and close coupled toilet. Natural light comes from the frosted double glazed window to the front, there is laminate flooring and full height tiling to two walls. There is a wall mounted radiator, inset ceiling spotlights and an extractor fan. An internal door leads to the hall.

OPEN PLAN LOUNGE KITCHEN DINER 18'7" apx plus recess x 14'5" max including cupboa



This thrilling space provides contemporary open plan living with, undoubtedly, the stand out feature being the bi-fold doors, which link the inside and outside beautifully.

KITCHEN AREA



Having an excellent range of wall and base units with a two tone finish, complementary square edged worktops and tiled splashbacks with an inset one and a half bowl stainless steel sink with mixer tap. The many integral appliances include an eye level oven and microwave oven/grill, four ring gas hob with extractor over, fridge freezer and dishwasher. There laminate in this area which flows into the living space, space for a table and chairs and wall mounted radiator. There is also a very convenient utility cupboard which has worktop space, plumbing for a washing machine and gives extra storage space. There are inset ceiling spotlights and an internal door leads to the hall and the space is open to the living area.



LIVING AREA



This lovely living area features the magnificent bi-fold doors, bathing the whole area with natural light and when fully open, linking the outside to inside wonderfully. There is laminate flooring, a wall mounted radiator and pendant ceiling lighting.



LANDING



A carpeted staircase leads from the hall to the first floor landing having carpet flooring, a double glazed window to the side and loft hatch. Internal doors leads to the bathroom and both bedrooms.

BEDROOM ONE 14'5" max to rear of robes x 8'2" apx



A good size double bedroom, situated at the rear of the property with two double glazed windows giving views of the garden and bringing in plenty of natural light. There is an excellent range of fitted wardrobes having sliding doors, laminate flooring and a wall mounted radiator. There is pendant ceiling lighting and an internal door leads to the landing

BATHROOM 6'9" x 5'6"



Having a three piece suite in white consisting of a panel bath with concealed wall taps, rain shower over and glass screen plus separate corner retractable hose, wall mounted wash basin with drawer and wall mounted taps and a concealed flush WC. There is a chrome ladder towel radiator, full height tiling to the walls, a vinyl floor, inset ceiling spotlights, shaver point and extractor fan. An internal door leads to the landing.



BEDROOM TWO 10'7" plus recess x 8'7" apx



Second well proportioned double bedroom, this time at the front of the property again with two double glazed windows bringing in natural light. There is a useful recess area, a boiler cupboard housing the combination boiler, carpet flooring, pendant ceiling lighting and a wall mounted radiator. An internal door leads to the landing.



FRONT AND PARKING



To the front, there is parking for two cars with a gate giving secure access to the rear garden.

REAR GARDEN



The secure side gate gives access to the impressive, south facing rear garden, having patio area, lawn bordered by mature plants and flowers plus a garden shed. There is an outside tap and the bi-fold doors take you back into the living area.



~ Material Information ~

TENURE:
Freehold

ADDITIONAL COSTS:
Management fees apply

COUNCIL AND COUNCIL TAX BAND:
Barnsley C

PROPERTY CONSTRUCTION:
Standard

PARKING:
Driveway

RIGHTS AND RESTRICTIONS:
None

DISPUTES:
There have not been any neighbour disputes

BUILDING SAFETY:
There have not been any structural alterations to the property /

PLANNING PERMISSIONS AND DEVELOPMENT PROPOSALS:
There are no known planning applications on neighbouring properties or land and the vendor confirmed they have not received any notices

UTILITIES:
Water supply - Mains
Sewerage - Mains
Electricity - Mains
Heating Source - Mains Gas
Broadband - Suggested speeds up to 100 mbps

ENVIRONMENT:
There has not been any flooding, mining or quarrying which has affected the property throughout our vendor's ownership.

~ Agent Notes ~

Please note information within our sales particulars has been provided by the vendors. Paisley Properties have not had sight of the title documents and therefore the buyer is advised to obtain verification from their solicitor. References to the Tenure of the property are based upon information provided by the vendor and again the buyer should obtain verification from their solicitor.

All measurements are approximate and quoted in metric with imperial equivalents and for general guidance only and whilst every attempt has been made to ensure accuracy, they must not be relied on. We advise you take your own measurements prior to ordering any fixtures, fittings or furnishings.

The fixtures, fittings and appliances referred to have not been tested and therefore no guarantee can be given that they are in working order.

Internal photographs are produced for general information and it must not be inferred that any item shown is included with the property.

You are advised to check availability and book a viewing appointment prior to travelling to view.

~ Paisley Properties ~

We are available to do appointments up until 8pm Monday to Friday and up until 4pm Saturday and Sunday so please contact the office if you would like to arrange a viewing. We also offer a competitive sales and letting service, please contact us if you would like to arrange an appointment to discuss marketing your property through Paisley, we would love to help.

~ Paisley Mortgages ~

Mandy Weatherhead at our sister company, Paisley Mortgages, is available to offer clear, honest whole of market mortgage advice. We also run a first time buyer academy to help you prepare in advance for your first mortgage, home-mover and re-mortgage advice. If you would like to speak to Mandy, please contact us on 01484 444188 / 07534 847380 to arrange an appointment.

*Your home may be repossessed if you do not keep up repayments on your mortgage. *

~ Paisley Surveyors ~

We work alongside Michael Kelly at Paisley Surveyors, who can assist you with any survey requirements on your purchase. We offer 3 levels of survey and can be contacted on 01484 501072 / office@paisley-surveyors.co.uk for a free, no obligation quote or for more information.

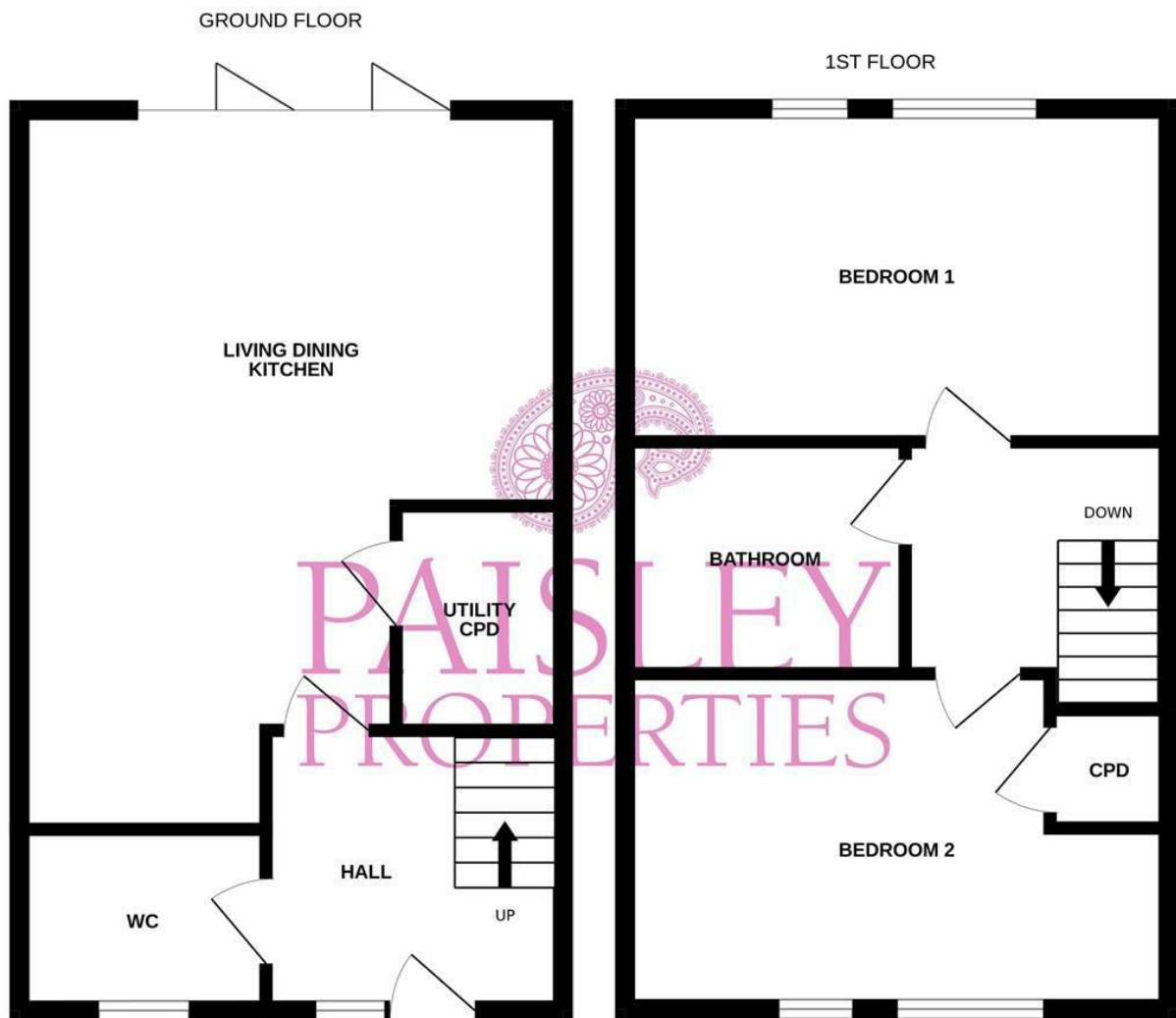

Whilst every attempt has been made to ensure the accuracy of the floorplan contained here, measurements of doors, windows, rooms and any other items are approximate and no responsibility is taken for any error, omission or mis-statement. This plan is for illustrative purposes only and should be used as such by any prospective purchaser. The services, systems and appliances shown have not been tested and no guarantee as to their operability or efficiency can be given.

Made with Metropix ©2025

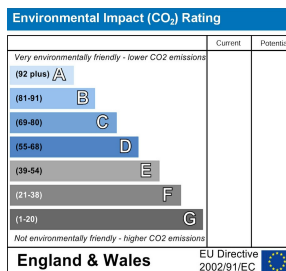
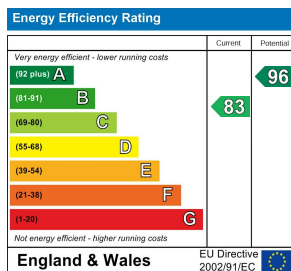

www.paisleyproperties.co.uk

Skelmanthorpe Office:
17 Commercial Road,
Skelmanthorpe, HD8 9DA
t: 01484 443893

Almondbury Office:
75-77 Northgate,
Almondbury, HD5 8RX
t: 01484 443922

Mapplewell Office:
4 Blacker Road,
Mapplewell, S75 6BW
t: 01226 395404

PAISLEY
PROPERTIES