

Portland Square

ST PAULS

APPROXIMATE FLOOR AREA

60 SQM / 646 SQFT

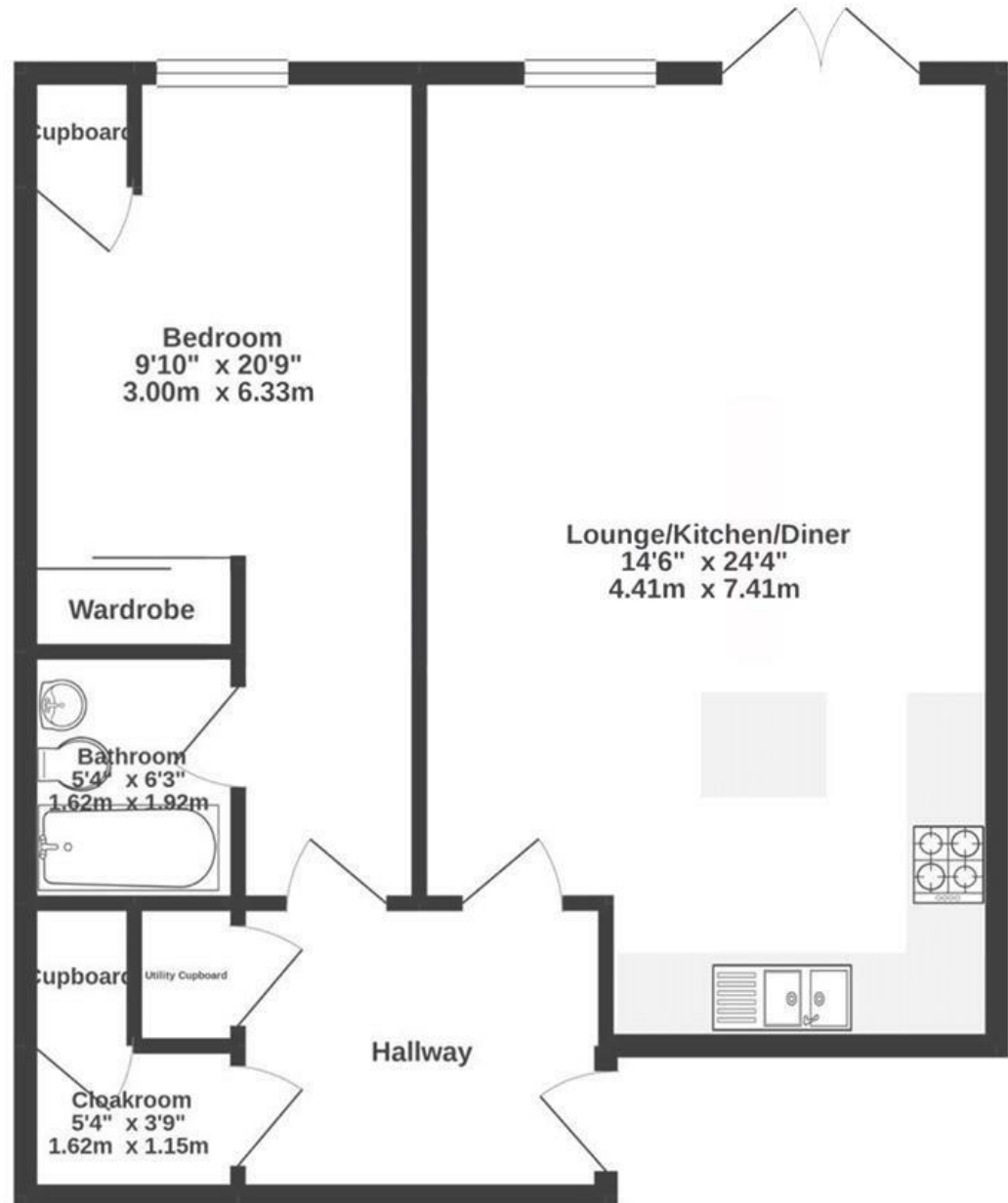

Boardwalk

Portland Square , BRISTOL

£

£300,000



BS2 8RZ

zzz

1 Bedrooms



1 Bathrooms

"This apartment has been a brilliant home over the years. The building and the square have a lovely community feel. Friends love the large open-plan kitchen/living room which is such a great entertaining space. I'll miss having my regular pastry from Farro, or coffee from Greytone, whilst sitting in the square, or enjoying an iced drink catching the afternoon sun in the courtyard."

