



Christmas Cottage, High Street, Chrishall, Royston £300,000 **Freehold**



# Key Features

2 1 E B

- Two bedroom cottage
- Lounge with log burner
- Kitchen/breakfast room
- Bathroom
- Front garden - south facing

This charming two bedroom cottage is full of character and dates back to around 1840. Boasting many original features the cottage comprises of a gorgeous living room, good size kitchen area with two double bedrooms and a bathroom on the first floor. The current owner has this to say about the property:

'I have lived in Christmas Cottage for 12 years and in the local area my whole life. Christmas Cottage is a happy house that has given us happy times and it always puts a smile on my face when I walk through the door. If I could pick the cottage up and take it with me, I would!  
Christmas Cottage is small but perfectly





formed and started out life, around 200 years ago, as a weavers cottage as there was a thriving cotton industry in Chrishall. The walks round here are amazing with the Icknield Way, the oldest path in Britain, running through the village. Sad as I am to leave Christmas Cottage I hope that the next person enjoys living here as much as I have done'.

The popular and picturesque village of Chrishall boasts its own church, inn and primary school with adjoining preschool. Set within open countryside the village is between the market towns of Saffron Walden and Royston. There are road and rail links with the main line railway stations at Royston and Audley End (Saffron Walden) providing a regular commuter service to London's King's Cross and Liverpool Street respectively. Access to the M11 is 7 miles and provides access to London, the M25 and the North

Porch  
Lounge  
4.03m max x 3.60m max  
13'3" max x 11'10" max



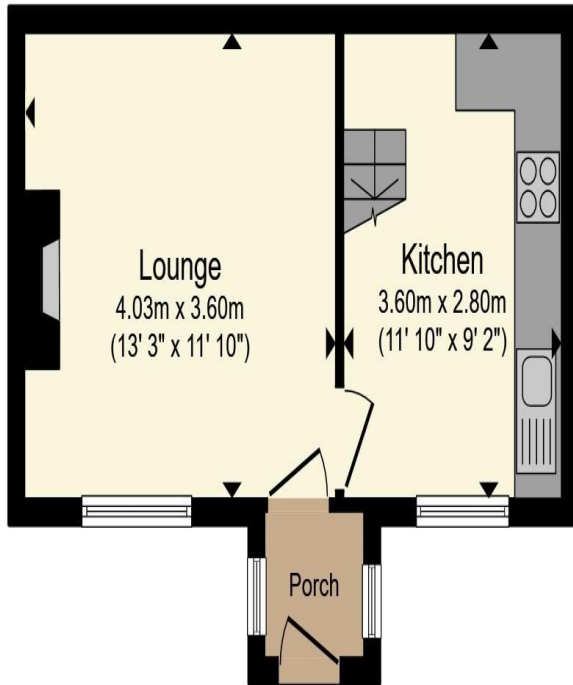

**Ground Floor**

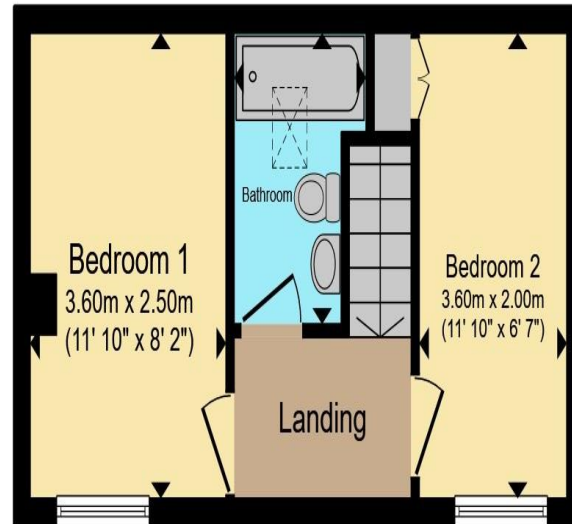

**First Floor**

Total floor area 55 sq.m. (592 sq.ft.) approx

This floor plan is for illustrative purposes only. It is not drawn to scale. Any measurements, floor areas (including any total floor area), openings and orientation are approximate. No details are guaranteed, they cannot be relied upon for any purpose and they do not form part of any agreement. No liability is taken for any error, omission or misstatement. A party must rely upon its own inspection(s). Powered by [www.propertybox.io](http://www.propertybox.io)



**Kitchen**  
3.60m max x 2.80m max  
11'10" x 9'2"

**Landing**  
Access to partly boarded loft.

**Bedroom One**  
3.60m x 2.50m  
11'10" x 8'2"

**Bedroom Two**  
3.60m x 2.00m  
11'10" x 6'7"

**Bathroom**  
Front  
South facing paved garden. Storage shed en-bloc.

To view this property call Kevin Henry on:  
01799 513632



# Selling your property?

Contact us to arrange a FREE home valuation.

 01799 513632

 1 Market Street, SAFFRON WALDEN, Essex, CB10 1JB

 [sales@kevinhenry.co.uk](mailto:sales@kevinhenry.co.uk)

 [www.Kevinhenry.co.uk](http://www.Kevinhenry.co.uk)



 SCAN ME



Kevin Henry is a trading name of Sharman Quinney Holdings Limited which is registered in England and Wales under company number 4174227, Registered Office is Cumbria House, 16-20 Hockliffe Street, Leighton Buzzard, Bedfordshire, LU7 1GN. VAT Registration Number is 500 2481 05.

1: These particulars do not constitute part or all of an offer or contract. 2: The measurements indicated are supplied for guidance only and as such must be considered incorrect. 3: Potential buyers are advised to recheck the measurements before committing to any expense. 4: Kevin Henry has not tested any apparatus, equipment, fixtures, fittings or services and it is the buyers interests to check the working condition of any appliances. 5: Kevin Henry has not sought to verify the legal title of the property and buyers must obtain verification from their legal representative. 6: Intending purchasers will be asked to produce identification documentation at a later stage and we would ask your co-operation in order that there will be no delay in agreeing the sale. Ref: SAF103715 - 0001

