



Aspen Road, High Wycombe, Buckinghamshire, HP10 9FA

Asking Price | £2,750

Property Features

- A Stunning Four Bedroom Town Home
- Located in the Abbey Barn Park Development
- A Newly Built Community In A Tranquil Countryside Setting
- En-Suite Shower to Main Bedroom
- High Standard Throughout
- Lounge with Juliet Balcony
- Garage and Driveway Parking
- Located Within a Short distance to High Wycombe Town Centre and Station
- Council Tax Band E
- Available Mid June 2026

Full Description

An extremely well presented four-bedroom, two-bathroom town house, offered to the market in immaculate condition, located in the Abbey Barn Park Development, a newly built community in a tranquil countryside setting. This property is offered to the rental market having been built by Berkley Homes just 5 years ago, this home is completed to an extremely high specification and offers modern and versatile accommodation.

The internal accommodation offers; entrance hallway which leads to open plan high specification kitchen/family room with a range of high-end appliances and patio doors to the garden and downstairs WC. The first floor offers the main living area with Juliet balcony, main bedroom with built in wardrobes and en-suite shower room. The 2nd floor offers three bedrooms, one of which could be used as an office/dressing area and the main the main family bathroom which offers a bath and separate shower. To the external of the property the property benefits from a rear garden, garage, and driveway parking for at least 2 cars.

The property is available from mid-June 2026 on an unfurnished basis.

Disclaimer: The photos used in this marketing material were taken approximately three years ago and may not reflect the current condition of the property. While we strive to provide accurate and up-to-date information, we recommend scheduling a viewing or inspection to confirm the property's present state.







Ground Floor Building 1

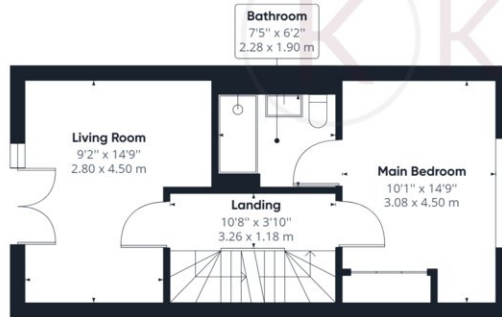

Floor 1 Building 1

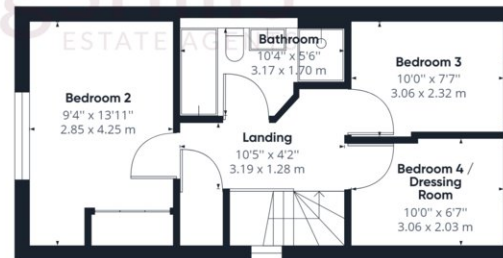

Floor 2 Building 1

Approximate total area⁽¹⁾

1281.25 ft²

119.03 m²

(1) Excluding balconies and terraces

While every attempt has been made to ensure accuracy, all measurements are approximate, not to scale. This floor plan is for illustrative purposes only.

GIRAFFE360