



Connells

Muirfield
Luton



Property Description

This three bedroom end of terrace home makes the ideal purchase for a growing family. With three bedrooms, all with built in storage, new shower room, kitchen/diner and private driveway this isn't one to miss. Located in the popular Bushmead area of LU2, a stone's throw from country idyllic walks.

Briefly comprises hallway, lounge and kitchen/diner downstairs.

Upstairs are three bedrooms, all with built in storage and shower room located off the landing.

The rear is laid mostly to lawn and holds a gate to the side.

The front is block paved with a driveway for two cars.

The area of Bushmead in LU2 is known for its family orientated suburb living, located a stone's throw from Warden Hills, the area offers picturesque views and walks.

Some local shops include a Co-op, community shop and pharmacy.

There is also a tapas restaurant, public house and church.

Local schools include Bushmead Primary, Icknield High and Cardinal Newman Catholic School.

Luton Sixth form college and Barnfield College are also within close reach.

Luton Mainline Railway Station is under 2 miles from the residence and Leagrave Station just over 2 miles.

Call now to book a viewing!

Entrance Hall

Double glazed door to front aspect. Storage cupboard. Stairs leading to first floor. Radiator.

Lounge

Double glazed window to front aspect. Radiator.

Kitchen/Diner

Double glazed patio doors and window to rear aspect. Fitted kitchen comprising a range of wall and base units with work surfaces over incorporating a sink unit. Integrated gas hob and oven with fan over. Space for a fridge/freezer. Plumbing for a washing machine and dishwasher. Under stairs storage cupboard. Part tiling. Tiled floor. Radiator.

First Floor Landing

Loft access with insulation and boarded. Storage cupboard.

Bedroom One

Double glazed bay window to front aspect. Double glazed window to side aspect. Built in wardrobes. Radiator.

Bedroom Two

Double glazed window to rear aspect. Built in wardrobes. Radiator.

Bedroom Three

Double glazed window to rear aspect. Built in wardrobes. Radiator.

Shower Room

Double glazed frosted window to side aspect. Suite comprising walk in shower cubicle with rainfall shower, wash hand basin and low level wc. Heated towel rail. Part tiling. Tiled flooring. Extractor fan.

Front Garden

Driveway for two vehicles.

Rear Garden

Laid to lawn with a patio area. Shed. Gate to side aspect.







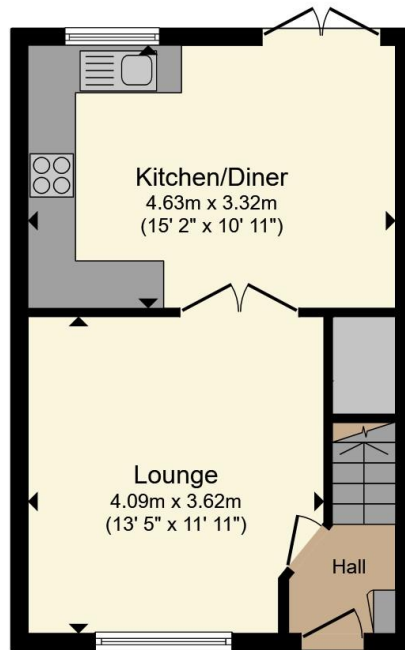

Ground Floor

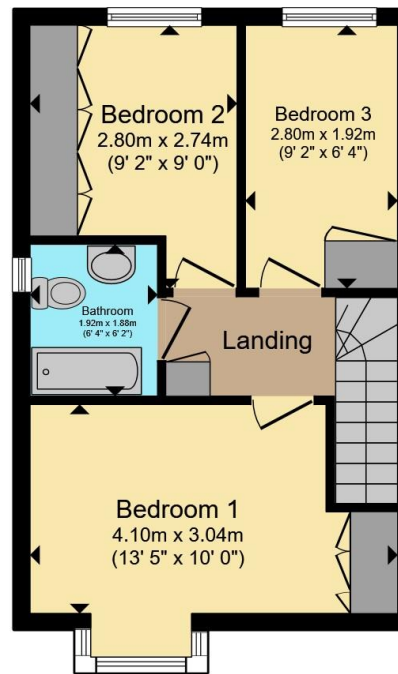

First Floor

Total floor area 69.4 m² (747 sq.ft.) approx

This floor plan is for illustrative purposes only. It is not drawn to scale. Any measurements, floor areas (including any total floor area), openings and orientation are approximate. No details are guaranteed, they cannot be relied upon for any purpose and they do not form part of any agreement. No liability is taken for any error, omission or misstatement. A party must rely upon its own inspection(s). Powered by www.propertybox.io



To view this property please contact Connells on

T 01582 592332
E lutonnorth@connells.co.uk

1A Riddy Lane
 LUTON LU3 2AD

EPC Rating: C Council Tax Band: C

Tenure: Freehold

view this property online connells.co.uk/Property/LUN103954



1. MONEY LAUNDERING REGULATIONS Intending purchasers will be asked to produce identification documentation at a later stage and we would ask for your co-operation in order that there will be no delay in agreeing the sale. 2. These particulars do not constitute part or all of an offer or contract. 3. The measurements indicated are supplied for guidance only and as such must be considered incorrect. Potential buyers are advised to recheck measurements before committing to any expense. 4. We have not tested any apparatus, equipment, fixtures, fittings or services and it is in the buyers interest to check the working condition of any appliances.

Connells Residential is registered in England and Wales under company number 1489613, Registered Office is Cumbria House, 16-20 Hockliffe Street, Leighton Buzzard, Bedfordshire, LU7 1GN. VAT Registration Number is 500 2481 05.

See all our properties at www.connells.co.uk | www.rightmove.co.uk | www.zoopla.co.uk

Property Ref: LUN103954 - 0005