

Sylvia Avenue BEDMINSTER

APPROXIMATE FLOOR AREA
112 SQM / 1209 SQFT

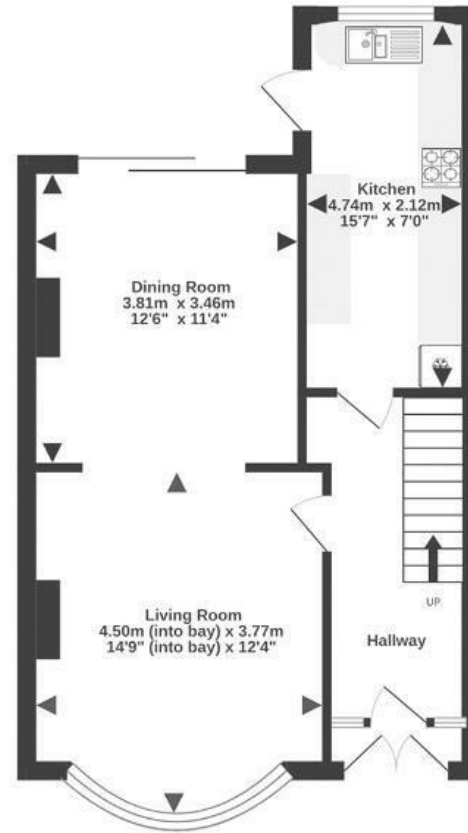

GROUND FLOOR



FIRST FLOOR

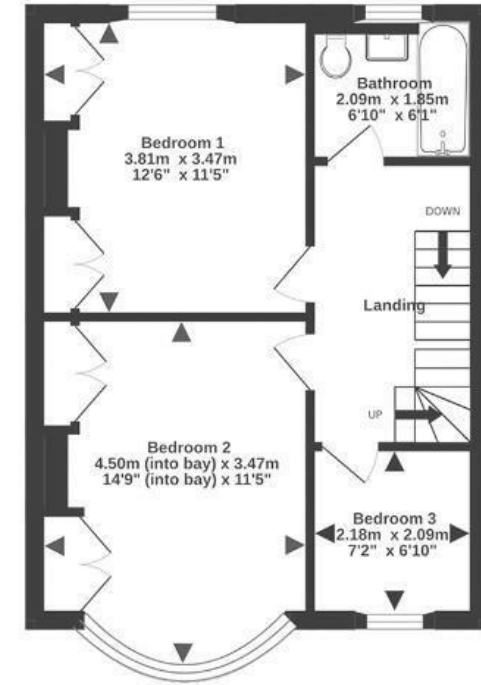

LOFT

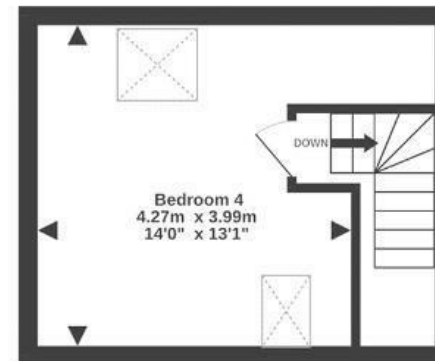

Boardwalk

Sylvia Avenue , BRISTOL



£600,000



4 Bedrooms



BS3 5BZ



1 Bathrooms

"We love the sense of space - with views over allotments at the back and parks on either side, plus you get really big skies from being up on a hill. In the summer, you get amazing sunsets on the patio and in winter you see fireworks over the city. It's a brilliant location, very green and super central - we're surrounded by three parks yet a stroll to Temple Meads, North St and the Harbourside, taproom and market at the city farm, and Sunday coffees in Victoria Park."

