



Peter
Buswell
Independent Family Estate Agents

Farthing Hill, Ticehurst

3 1 2



Main Description

This beautifully refurbished and thoughtfully extended three-bedroom semi-detached house conveniently located in the village of Ticehurst has been completed to an exceptional standard throughout with the accommodation arranged over three floors.

With off-road parking for several vehicles, the property immediately makes a strong first impression. Step inside via a welcoming entrance hall with useful storage for coats and shoes, leading through to a stylish living room featuring elegant mid-height wood panelling, engineered oak flooring, and a front-facing window. The space flows effortlessly into the dining area, creating a warm and sociable layout ideal for both everyday living and entertaining.

At the heart of the home is the stunning newly fitted kitchen, designed with both style and functionality in mind. Boasting a vaulted ceiling with a skylight dome, a striking central island with Corian worktops with an inset ceramic sink with a gold swan neck boiling water tap and a range of premium integrated appliances including an air fry double oven with steamer, microwave and dishwasher, this impressive space is perfectly suited to modern living. Bi-fold doors open directly onto the garden, seamlessly connecting indoor and outdoor spaces for entertaining and family gatherings alike.

The first floor offers two generously sized bedrooms alongside a beautifully finished family bathroom, complete with a bath and overhead shower, wall-mounted vanity unit with a ceramic bowl wash hand basin, and sophisticated gold fittings that add a touch of luxury.

Occupying the entire top floor, the principal bedroom provides a peaceful and light-filled retreat, enhanced by Velux windows to both the front and rear elevations.



Ground Floor
Approx. 48.7 sq. metres (523.7 sq. feet)

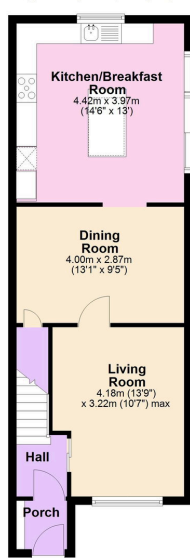

First Floor
Approx. 29.7 sq. metres (319.8 sq. feet)

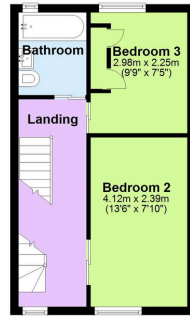

Second Floor
Approx. 18.6 sq. metres (199.7 sq. feet)



- GUIDE PRICE £400,000 TO £425,000
- SEMI DETACHED THREE BEDROOM HOUSE
- RECENTLY EXTENDED AND REFURBISHED TO A HIGH SPECIFICATION
- BEAUTIFULLY PRESENTED ACCOMMODATION SET OVER THREE FLOORS
- A NEWLY FITTED MODERN KITCHEN WITH INTEGRATED APPLIANCES & ISLAND
- BI-FOLDING DOORS FROM THE KITCHEN TO THE GARDEN
- MODERN FAMILY BATHROOM
- OFF ROAD PARKING FOR SEVERAL VEHICLES
- EPC RATING Awaited
- COUNCIL TAX BAND C

