

SIGNATURE

NORTH EAST

OFFICIALLY RATED THE NO.1 ESTATE AGENT IN THE NORTH EAST





📍 Gables End, Morpeth NE61 5RR

Gables End, Morpeth NE61 5RR

Offers Over £210,000

Signature North East welcomes you to this three-bedroom bungalow, ideally located within the sought-after village of Widdrington. Set within a peaceful private road and surrounded by an abundance of green spaces, the property offers a tranquil lifestyle while remaining close to local amenities available throughout the village. Druridge Bay Beach is just a short distance away, providing easy access to the Northumberland coastline, while Widdrington train station offers convenient transport links across the region.

The property is entered via the spacious kitchen, which features attractive wall and base units complemented by sleek worktops, offering a warm and inviting introduction to the home. From here, a hallway leads through to the dining area, which opens into the living room, creating a sociable and well-connected layout. Both spaces benefit from large windows that allow an abundance of natural light to flood in, while the living room is further enhanced by elegant French doors opening out to the rear garden.

Continuing through the home, you will discover three well-sized bedrooms, each offering comfortable and versatile living space. The second bedroom benefits from the added privacy of a modern en suite, creating a peaceful retreat within the home. Completing the home is a recently installed family bathroom, finished to a contemporary standard and fitted with a bathtub, overhead shower, wash basin and WC.

Externally, the property offers a well-sized garden laid with patio, ideal for outdoor seating and entertaining. Off-street parking is available for up to three vehicles via the driveway. The home is further enhanced by a CCTV system, offering an added sense of security.



PLEASE NOTE THAT THE VENDOR HAS CERTIFIED THE PROPERTY INFORMATION AND IMAGES.

PROPERTY FLOORPLAN

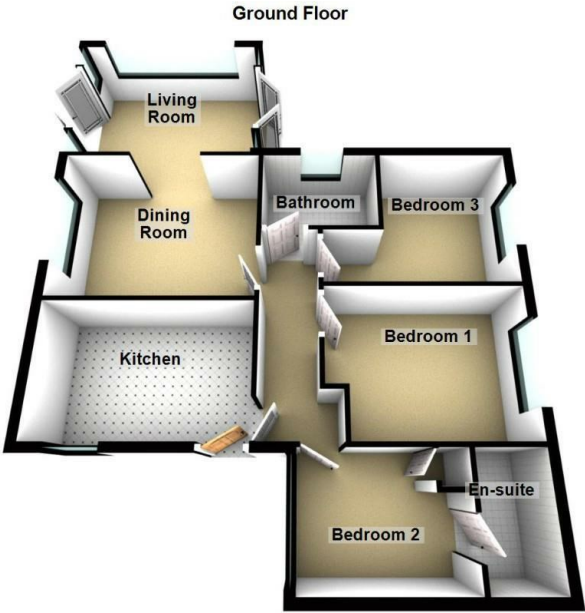

Total area: approx. 78.9 sq. metres (848.8 sq. feet)

Measurements:

Kitchen
8'9" x 13'6"

Dining Room
10'8" x 13'6"

Living Room
9'7" x 12'11"

Bedroom One
9'9" x 12'9"

Bedroom Two
10'0" x 7'8"

En Suite
3'1" x 7'9"

Bedroom Three
9'8" x 12'11"

Bathroom
5'6" x 7'9"

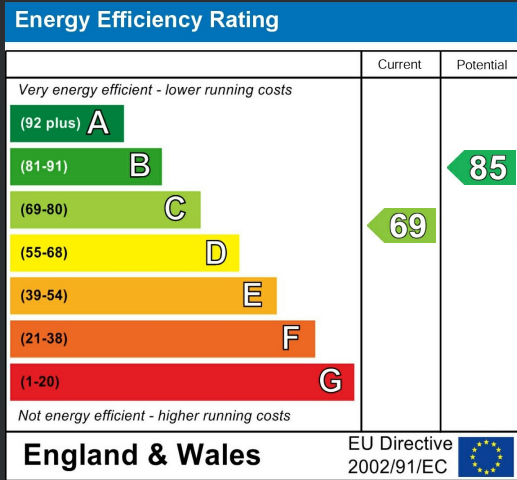





More 5 Star Customer Reviews than any other Agent based in the North East on [allAgents.co.uk](https://allagents.co.uk)



SALES

LETTINGS

FINANCE

LAW

WE COVER THE WHOLE OF THE NORTH EAST

Whitley Bay
0191 251 3344

Cramlington
01670 897 213

Tynemouth
0191 296 6689

Morpeth
01670 513 966

Ponteland
01661 820 082

Wallsend
0191 432 4151

Alnwick
01665 511 800

Heaton
0191 432 4275

Forest Hall
0191 266 9966

Other locations
0191 640 3523

Newcastle
0191 640 2284

Durham
0191 303 8252

Gosforth
0191 640 3523

Sunderland
0191 543 6390

Whickham
0191 432 5102

Gateshead
0191 432 4294

Jesmond
0191 281 1037

Killingworth
0191 640 3602

Ryton
0191 413 9845

Head Office &
Lettings
0191 253 4815

*Highest recommended 5-star reviews than any other Estate Agent based in the North East on [allAgents.co.uk](https://allagents.co.uk) - The UK's Largest Customer Review Website for the Property Industry & Awarded Best Estate Agency 2018 & 2019 - North East England by SME News