

SNELLERS

ESTATE AGENTS



Cranes Park Crescent, KT5

£390,000

This bright and spacious two double bedroom apartment is situated on the ground floor of this popular purpose built block and it benefits from having access to communal gardens.

Cranes Park Crescent is ideally situated between Kingston and Surbiton town centres where you will find a vast array of shops, pubs and restaurants. Surbiton's mainline station has a fast train to London Waterloo and the River Thames, accessed via the Queens Promenade walk is less than a mil away.

- Two Double Bedrooms • Ground Floor • Communal Gardens •
- Popular Location • Bright And Spacious • Good Condition •

SNELLERS

ESTATE AGENTS

Ground Floor

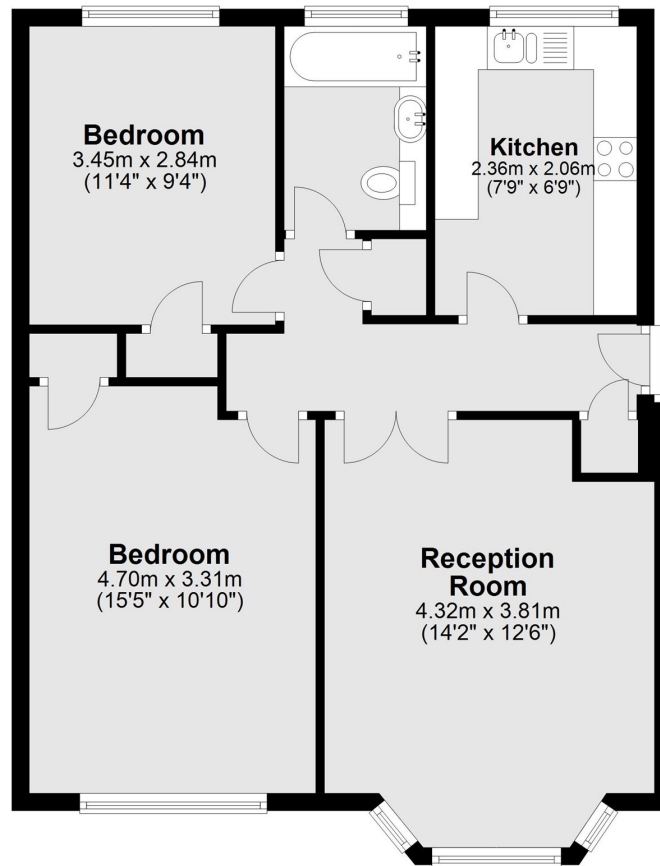

Total area: approx. 61.8 sq. metres (665.0 sq. feet)

Snellers Kingston Sales
17-21 Richmond Road
Kingston
KT2 5BW
020 8546 8715
kingstonsales@snellers.co.uk

Energy Rating: We aim to make our particulars both accurate and reliable. However they are not guaranteed; nor do they form part of an offer or contract. If you require clarification on any points then please contact us, especially if you're traveling some distance to view. Please note that appliances and heating systems have not been tested and therefore no warranties can be given as to their good working order