

The Tower, St. George Wharf SW8 2DU

£2,800 Per Week

- 24/7 concierge
- cinema
- parking space
- safe
- gym and spa
- business lounge
- under floor heating and air cooling
- swimming overlooking river
- meeting room / dining room
- smart home system

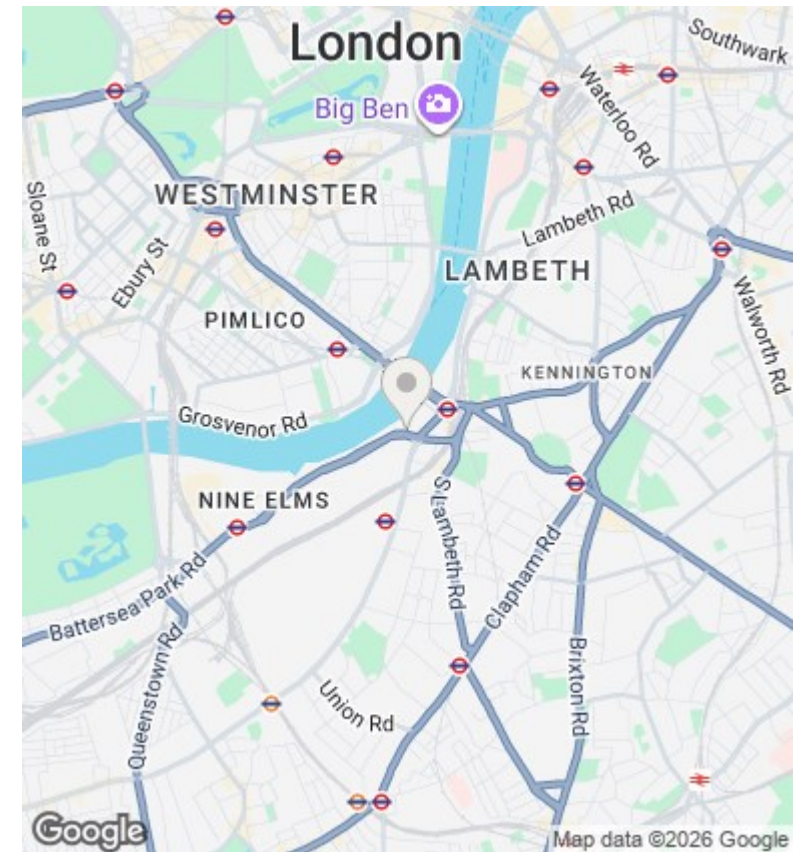
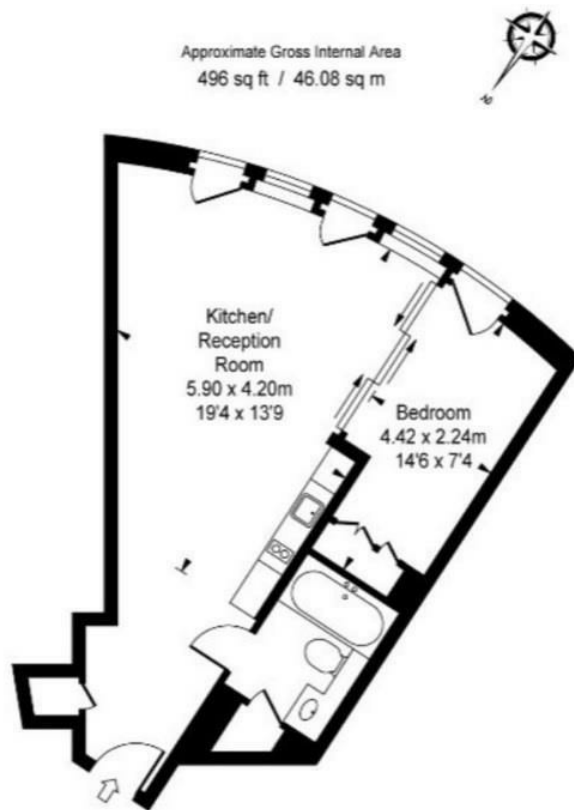

Viewings

Viewings by arrangement only.
Call 02077225022 to make an appointment.

Council Tax Band

F

EPC Rating:

Energy Efficiency Rating		
	Current	Potential
<i>Very energy efficient - lower running costs</i>		
(92 plus) A		
(81-91) B		
(69-80) C		
(55-68) D		
(39-54) E		
(21-38) F		
(1-20) G		
<i>Not energy efficient - higher running costs</i>		
England & Wales	EU Directive 2002/91/EC	