



Nightingale Walk, Woodhall Farm, Hemel Hempstead, HP2 7QY
Offers Over £160,000

Set in the popular area of Woodhall Farm, this charming one-bedroom apartment presents an excellent opportunity for both first-time buyers and buy to let investors alike. The property boasts a spacious reception room, a modern kitchen and bathroom and a good sized bedroom. This purpose-built flat is situated in a convenient location, making it ideal for those who appreciate easy access to local amenities and transport links. Viewing Essential!

COMMUNAL ENTRANCE

Door into communal areas with stairs to first floor.

ENTRANCE HALL

Wall mounted telecom entry system, doors to bedroom, bathroom and living room.

LIVING ROOM 9'6" x 15'4" (2.9 x 4.67)



Double glazed window, electric heating door to:

KITCHEN 6'7" x 10'7" (2.01 x 3.23)



Matching range of wall and base cupboard units with work surfaces over, stainless steel sink drainer unit, electric oven and hob, splash back tiling, space for washing machine and fridge freezer, two storage cupboards, double glazed window.

BEDROOM 12'7" x 9'8" (3.84 x 2.95)



Double glazed window, electric heater.

BATHROOM 6'5" x 5'5" (1.96 x 1.65)



Bath with mixer taps and shower attachment over, pedestal wash hand basin, LLWC, tiled flooring, extractor fan, frosted double glazed window.

OUTSIDE

COMMUNAL GARDENS & PARKING



Floor Plan

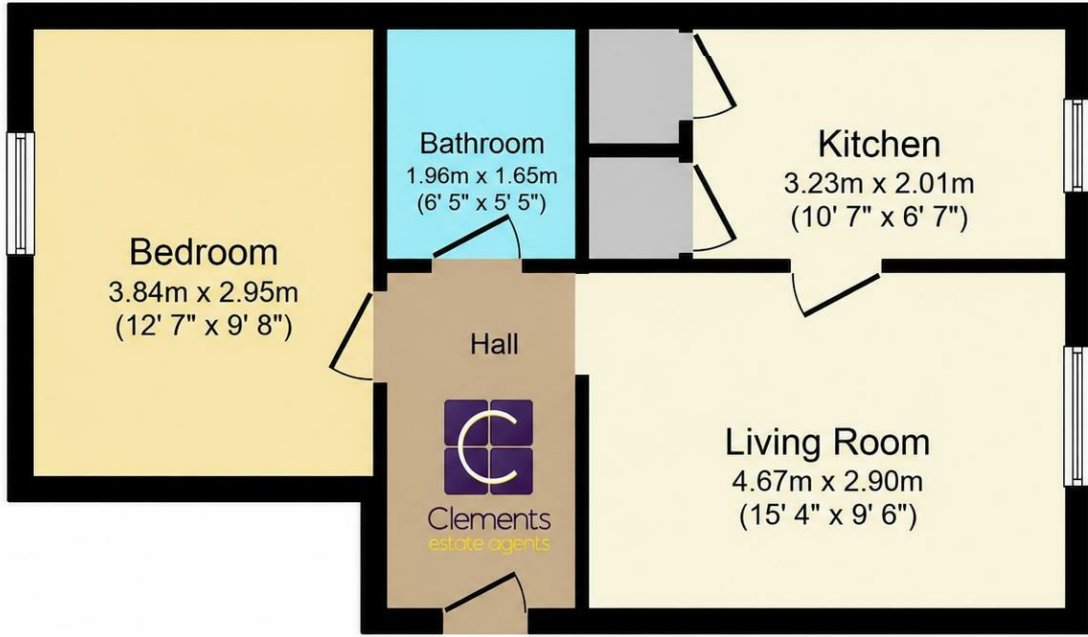

Floor Plan

Floor area 39.0 sq. m. (420 sq. ft.) approx

Total floor area 39.0 sq. m. (420 sq. ft.) approx

This Floor Plan is for illustration purposes only and may not be representative of the property. The position and size of doors, windows and other features are approximate. Unauthorized reproduction prohibited. © PropertyBOX

Area Map

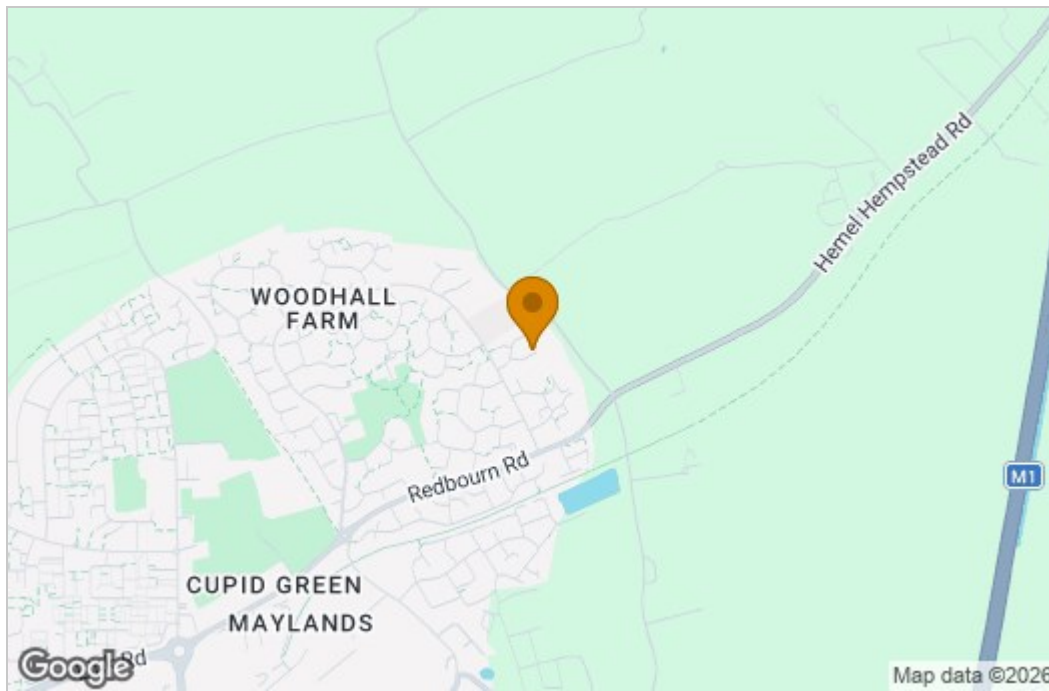

Energy Efficiency Graph

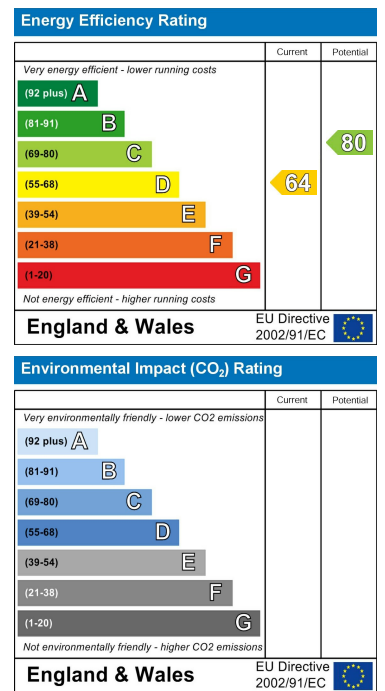

These particulars, whilst believed to be accurate are set out as a general outline only for guidance and do not constitute any part of an offer or contract. Intending purchasers should not rely on them as statements of representation of fact, but must satisfy themselves by inspection or otherwise as to their accuracy. No person in this firm's employment has the authority to make or give any representation or warranty in respect of the property.