



A bright and spacious, 2 bedroom apartment, located a few minutes from St John's Wood High Street and Tube Station.

The property is on the 4th floor of the Mansion Block, situated in the heart of St John's Wood. The apartment enjoys the benefit of two double bedrooms, two bathrooms, as well as a fitted kitchen and beautiful reception room.

Grove End Road

NW8 9EL

£784 Per Week

Subject to Contract

# FOXGREGORY



## Addison House, Grove End Road, London NW8

Approximate Gross Internal Floor Area = 77.1 sq m / 830 sq ft

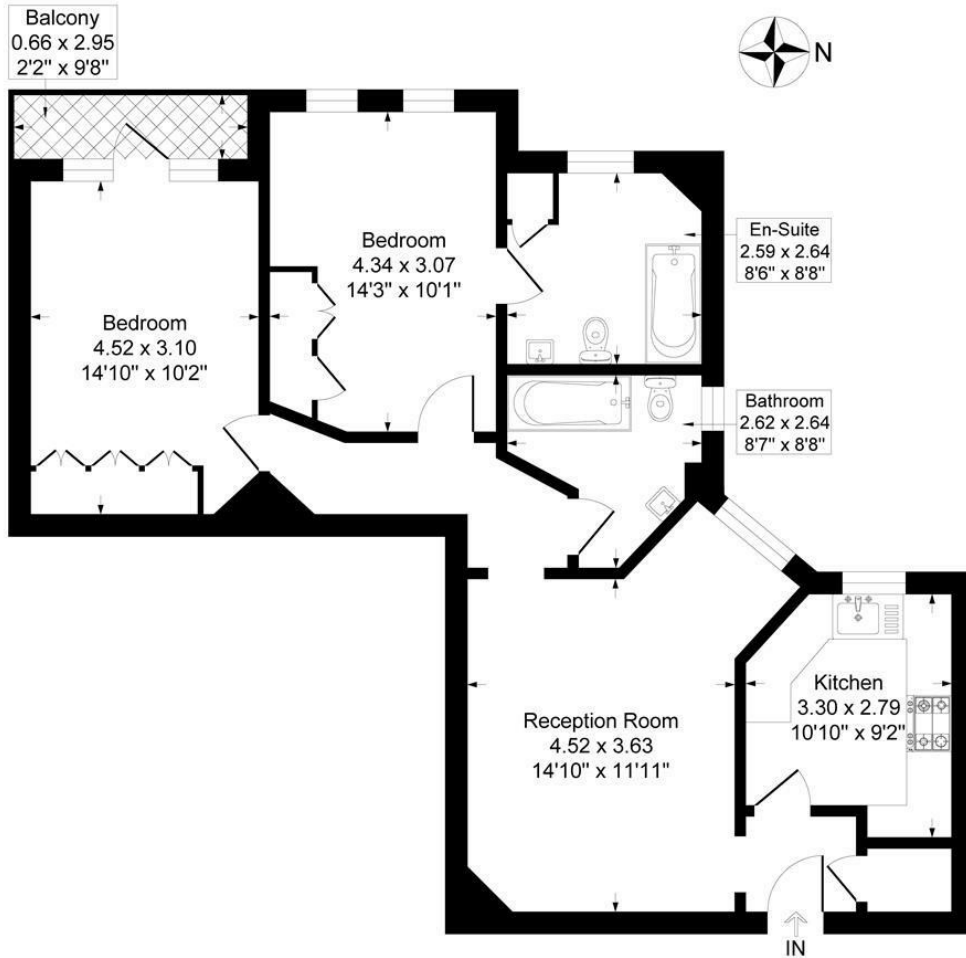

Fourth Floor

Illustration for identification purposes only, measurements are approximate, not to scale.

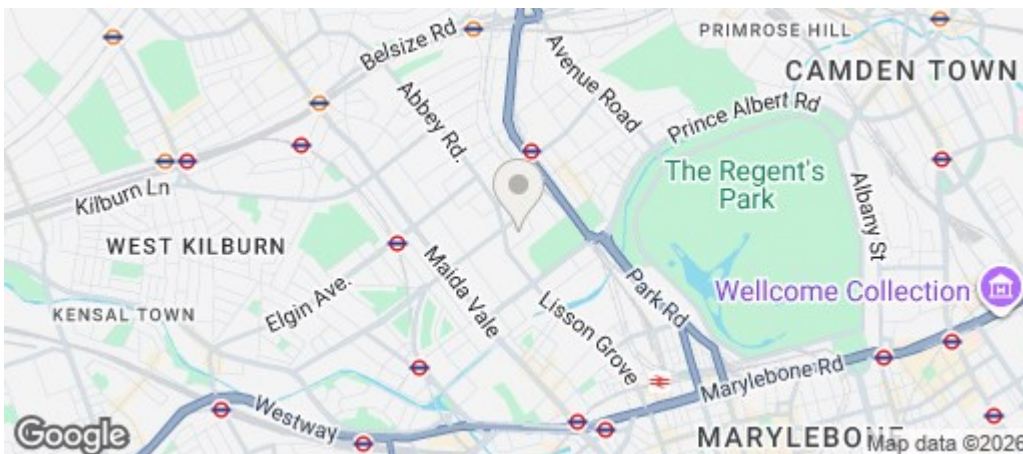

Energy Efficiency Rating		
	Current	Potential
Very energy efficient - lower running costs		
(92 plus) <b>A</b>		
(81-91) <b>B</b>		
(69-80) <b>C</b>		
(55-68) <b>D</b>		
(39-54) <b>E</b>		
(21-38) <b>F</b>		
(1-20) <b>G</b>		
Not energy efficient - higher running costs		
	<b>59</b>	
<b>England &amp; Wales</b>	EU Directive 2002/91/EC	