



Melbourne Avenue, W13

£400,000

This well presented first floor apartment offers stylish, modern living. The accommodation comprises an open plan kitchen/living area, a double bedroom and a contemporary bathroom.

Close to both Oaklands and Fielding primary schools, situated in between Northfields Avenue and Boston Road, this location is ideal for good transport links and convenient local amenities.

First Floor

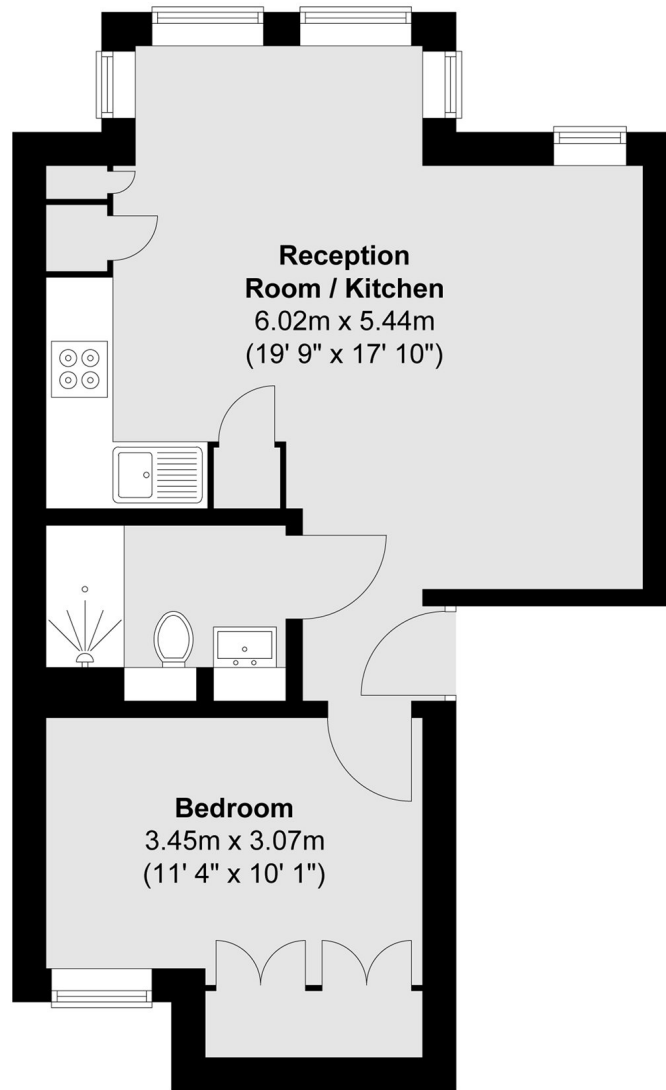

Total area (approx.) : 37.5 sq. m (403 sq. ft)

Robertson Smith & Kempson Northfields Sales
116 Northfield Avenue,
London, W13 9RT
020 8566 2340
northfieldssales@robertsonsmithandkempson.co.uk

Energy Rating: C. We aim to make our particulars both accurate and reliable. However they are not guaranteed; nor do they form part of an offer or contract. If you require clarification on any points then please contact us, especially if you're traveling some distance to view. Please note that appliances and heating systems have not been tested and therefore no warranties can be given as to their good working order.