



WORPLE ROAD MEWS, SW19

£1,950 per month

One bedroom
Modern
Balcony
Unfurnished
Communal roof terrace
Energy rating: c

@marshandparsons
marshandparsons.co.uk

MARSH &
PARSONS



ABOUT THE PROPERTY

A spacious one double bedroom flat with wooden flooring throughout. The property offers an open plan fully fitted kitchen/reception room with floor to ceiling windows, double bedroom with fitted wardrobes and a modern bathroom. The property also offers a communal roof terrace.

The property is located in a quiet modern mews development just minutes from Wimbledon main line station.



STEP INSIDE WORPLE ROAD MEWS

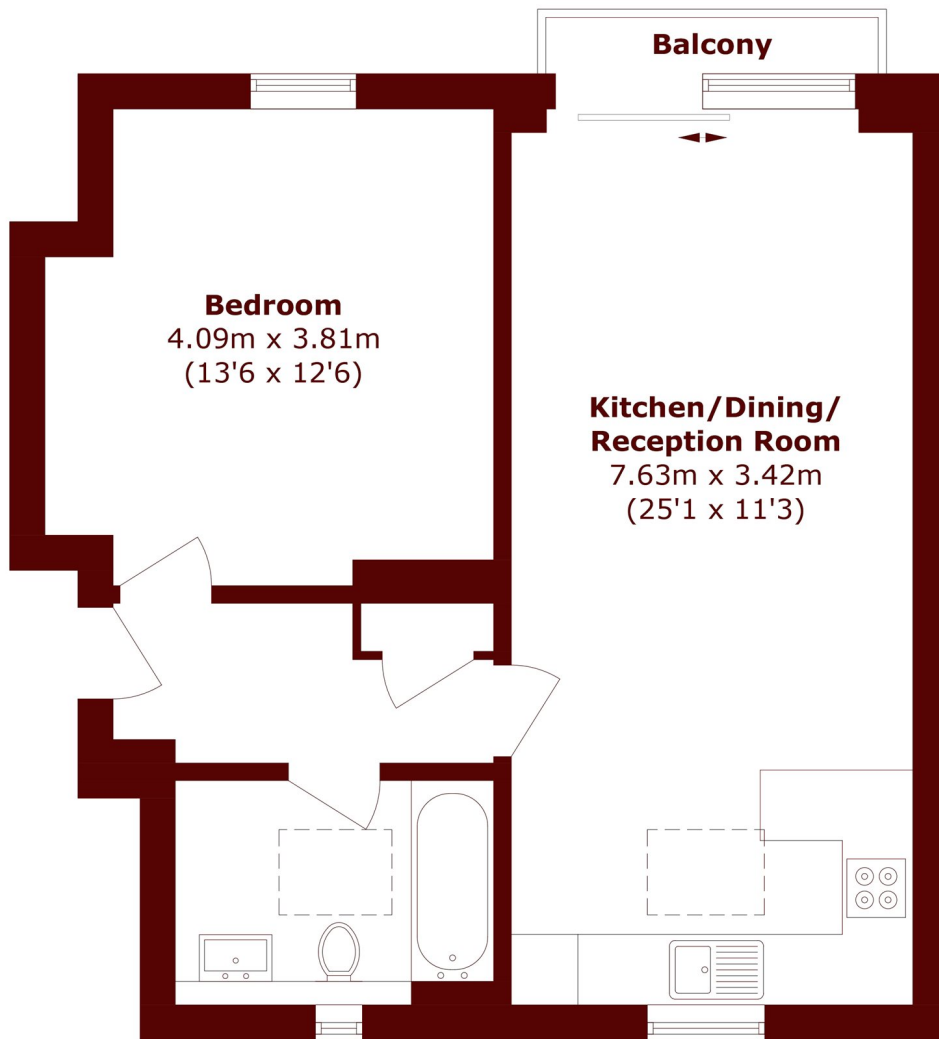

Total area (approx.): 52.2 sq. m (562.3 sq. ft)

Balcony (approx.): 1.4 sq. m (14.6 sq. ft)

Wimbledon
020 8879 6661

Energy Rating: C We aim to make our particulars both accurate and reliable. However, they are not guaranteed; nor do they form part of an offer or contract. If you require clarification on any points then please contact us, especially if you're traveling some distance to view. Please note that appliances and heating systems have not been tested and therefore no warranties can be given as to their good working order

MARSH &
PARSONS