



Blacksmiths Lodge, Lindford, Hampshire, GU35

£400,000

- Three spacious bedrooms
- Three bathrooms
- Large open plan living area
- Study room, guest WC and utility cupboard
- 986 sq ft
- South facing garden
- Energy-efficient construction
- 10-year structural warranty

This newly built three-bedroom home at Blacksmiths Lodge offers approximately 986 sq ft of thoughtfully designed living space. As the final three-bedroom residence available in this boutique development of three, it represents a unique opportunity in Lindford, East Hampshire.

The ground floor features a spacious open-plan kitchen and dining area, acting as the home's heart. Full-width bi-folding doors open onto a private, south-facing garden, creating a seamless indoor-outdoor connection. A dedicated study, guest WC, and utility cupboard add essential practicality. Uniquely, the house is offered without a fitted kitchen or carpets, allowing buyers to collaborate with the developer on a bespoke finish.

Upstairs, the layout includes a principal bedroom with an en-suite, a family bathroom, and two additional bedrooms overlooking the garden. Built for efficiency, the home includes an air source heat pump and underfloor heating. Externally, the property features block-paved parking and landscaped sandstone pathways. This high-specification home combines modern performance with a personalized touch, offering exceptional value for long-term living.





ONE LONDON

PROPERTY

*Blacksmiths Lodge,
Hampshire, GU35*

SIZE

986 sq ft

Three bedrooms | Three bathrooms

CONTACT

*0207 856 0396
info@one-london.uk
www.one-london.uk*

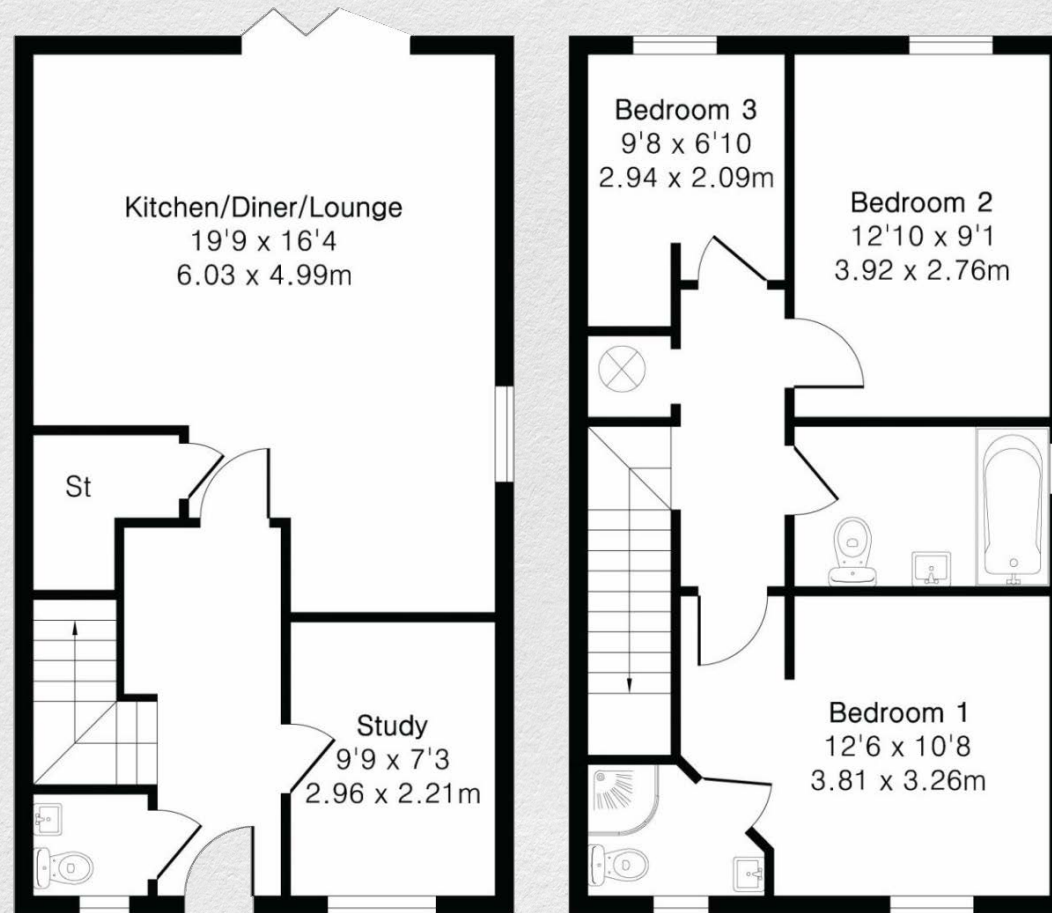

Ground Floor

First Floor

*** For illustration purposes only. Could not be to scale.
One-London aims to ensure accuracy but is not liable
for any discrepancies.*