

ALLDAY
& MILLER



Snowdrop Mews, Pinner, HA5 3WW
£300,000

1 1 1 C



Snowdrop Mews, Pinner, HA5 3WW

£300,000

- Generous Sized One Bedroom
- Penthouse
- Allocated Parking
- Close To Amenities
- 16ft Master Bedroom
- Private Balcony
- Well Presented Throughout
- Excellent Location
- Contemporary Fitted Kitchen
- Long Lease

Description

This well-presented apartment is offered in good condition throughout and provides bright, modern living accommodation.

The property comprises a spacious double bedroom, a modern bathroom, and a reception/dining area that offers a comfortable space for both relaxing and entertaining. The open-plan layout leads through to a fitted kitchen, creating a practical and sociable living area.

The main living space is bright and airy, with access to the balcony, providing a pleasant outdoor space.

Situation

Situated on the highly sought-after Snowdrop Mews in the heart of Pinner (HA5 3WW), this superbly located home offers the perfect balance of peaceful residential living and outstanding convenience. Just a short walk from Pinner Station (Metropolitan Line), the property provides direct access into Central London, along with excellent bus links to Harrow, Northwood and Ruislip. Moments away you'll find the charming and historic Pinner High Street with its boutique shops, cafés, restaurants, traditional pubs and supermarkets, creating a true village atmosphere. Families will appreciate the proximity to highly regarded schools including West Lodge Primary School, Pinner Wood School and Nower Hill High School. With attractive nearby green spaces such as Pinner Memorial Park offering leisure facilities and scenic walks.



Floor Plans

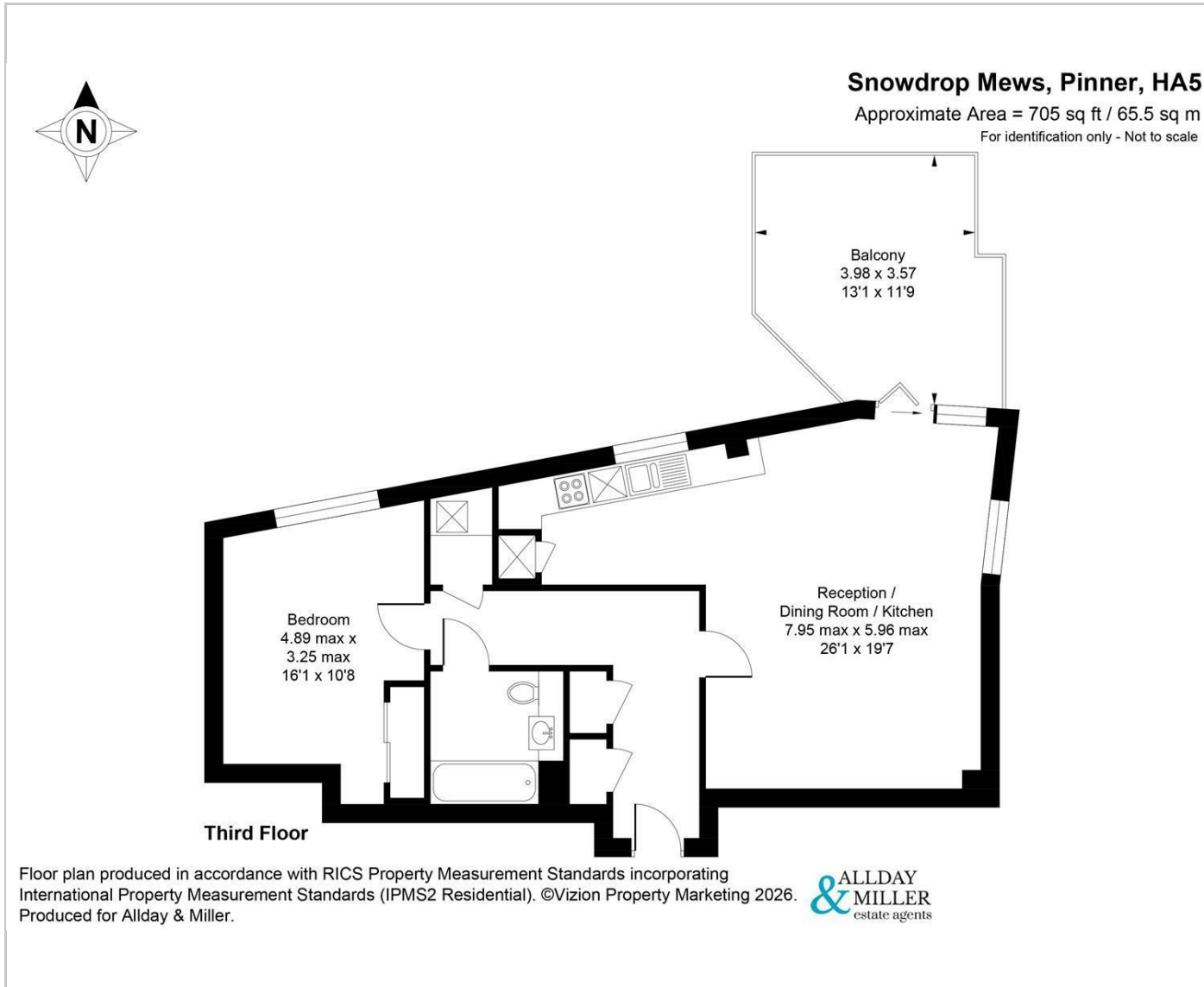

Area Map

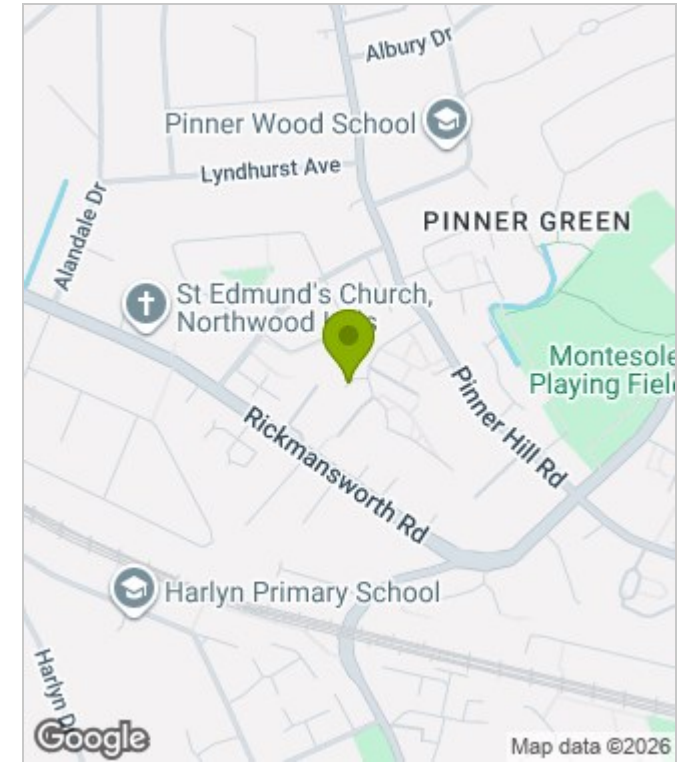

Energy Performance Graph

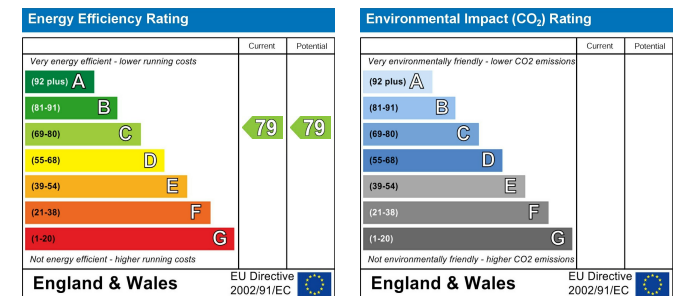

These particulars, whilst believed to be accurate are set out as a general outline only for guidance and do not constitute any part of an offer or contract. Intending purchasers should not rely on them as statements of representation of fact, but must satisfy themselves by inspection or otherwise as to their accuracy. No person in this firm's employment has the authority to make or give any representation or warranty in respect of the property.