



## 7 Grebe Gardens, High Road, Burgh Castle, Great Yarmouth, NR31 9QX

**\*\* OVER 50's \*\*** This idyllic two bedroom property, located in BURGH CASTLE close to SCENIC walking trails. Generously designed layout for OVER 50's. The property benefits from warden visits and landscaped garden with additional services on request supplied from the onsite residential home.

- Personalised aesthetics
- Extremely spacious and airy
- Two double bedrooms - Both with en suite, walk in wardrobe & Juliette balcony
- Allocated car parking space
- Eco heating, solar panels and underfloor heating
- Additional services and care available on site
- South facing communal garden
- Sought after Burgh Castle location - Close to local amenities and popular walking attractions

**£1,250 Per Month**

GROUND FLOOR  
845 sq.ft. (78.5 sq.m.) approx.

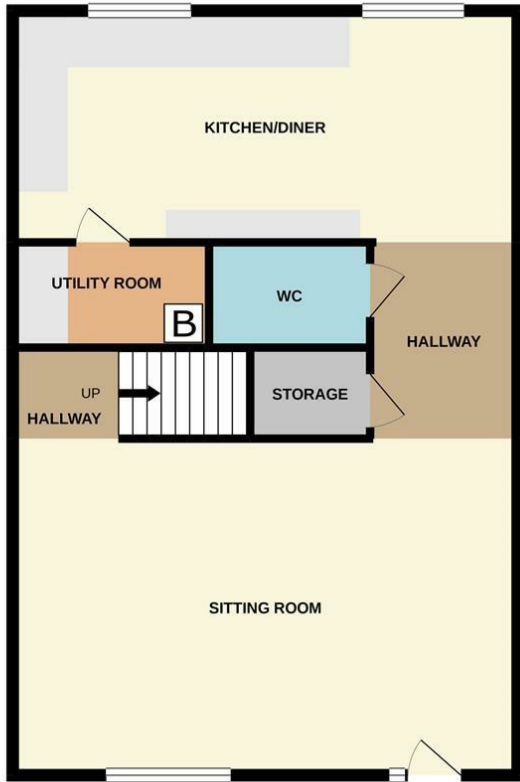

1ST FLOOR  
845 sq.ft. (78.5 sq.m.) approx.

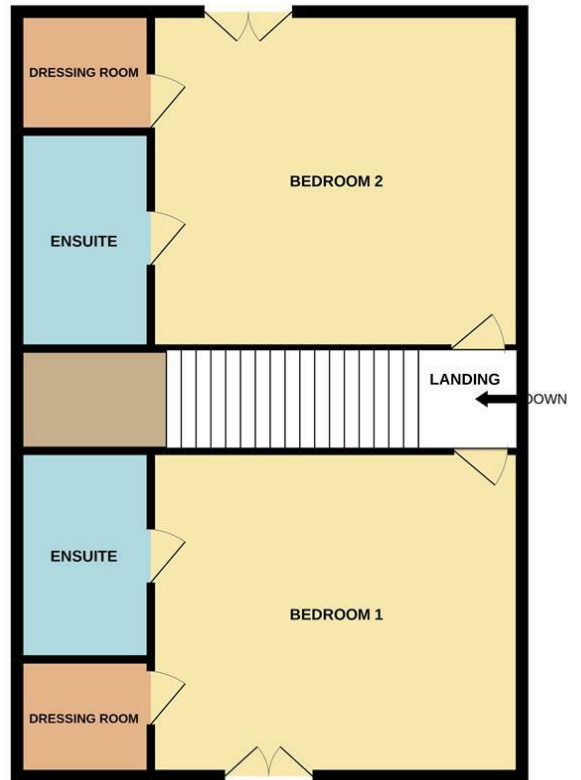

TOTAL FLOOR AREA : 1690 sq.ft. (157.0 sq.m.) approx.

Whilst every attempt has been made to ensure the accuracy of the floorplan contained here, measurements of doors, windows, rooms and any other items are approximate and no responsibility is taken for any error, omission or mis-statement. This plan is for illustrative purposes only and should be used as such by any prospective purchaser. The services, systems and appliances shown have not been tested and no guarantee as to their operability or efficiency can be given.  
Made with Metropix ©2021

Energy Efficiency Rating		Current	Potential
<i>Very energy efficient - lower running costs</i>			
(92 plus) <b>A</b>			
(81-91) <b>B</b>			
(69-80) <b>C</b>			
(55-68) <b>D</b>			
(39-54) <b>E</b>			
(21-38) <b>F</b>			
(1-20) <b>G</b>			
<i>Not energy efficient - higher running costs</i>			
<b>England &amp; Wales</b>	EU Directive 2002/91/EC		