

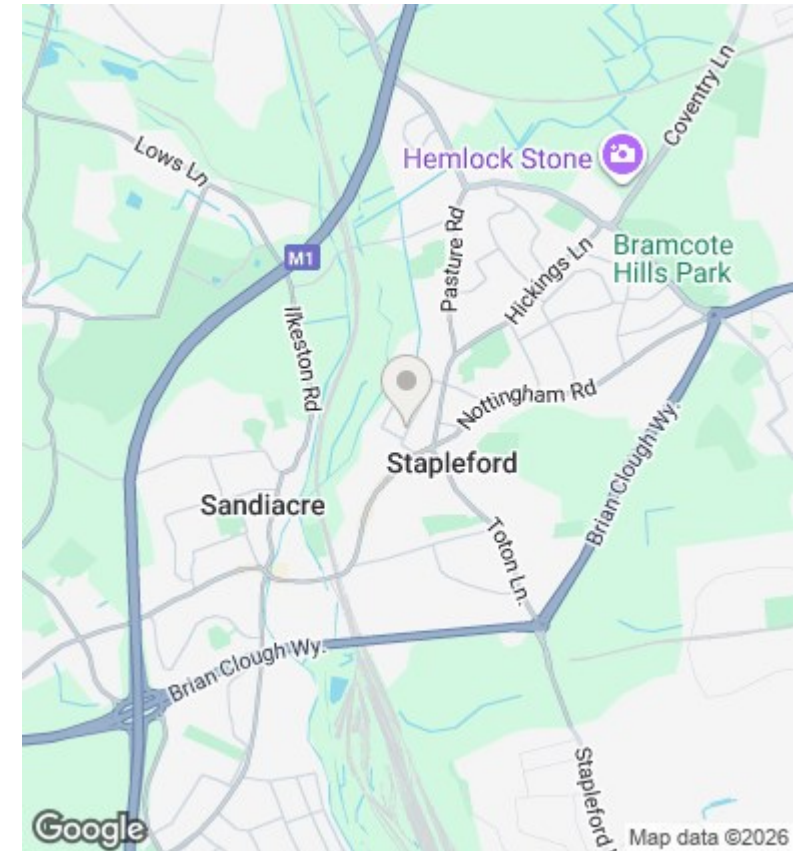

9 Frederick Road, Stapleford, Nottingham, NG9 8FL

£950

- 3 bedroom end terraced house
- Bathroom with shower enclosure and separate bath
- Secure rear garden
- New neutral décor and flooring
- Gas central heating system and combi boiler
- Excellent location for local amenities
- Newly fitted kitchen with integrated cooking facilities
- Double glazed throughout
- Council tax Band = A

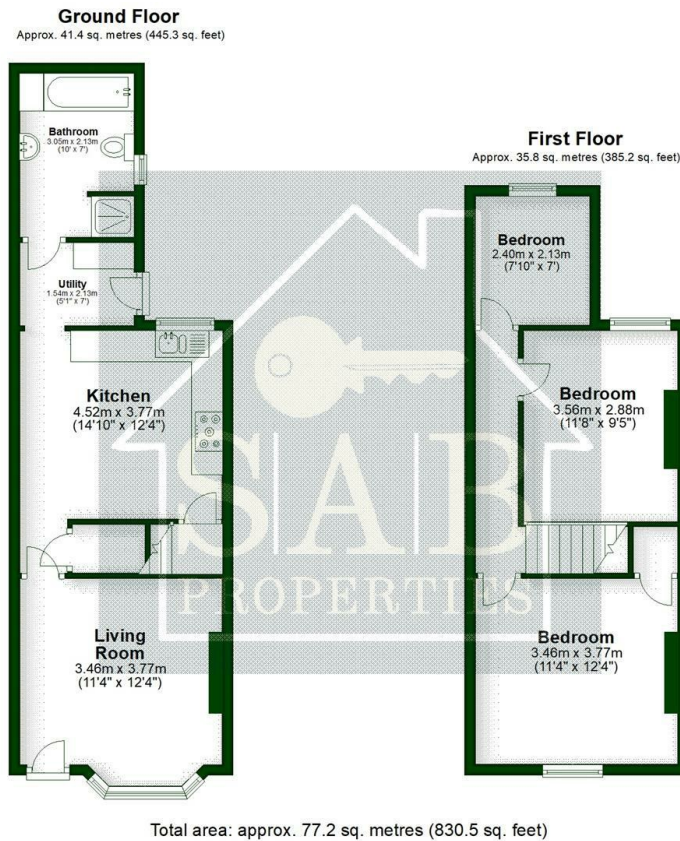

Directions

Viewings

Viewings by arrangement only. Call 0115 6713038 to make an appointment.

Council Tax Band

A

EPC Rating:

D

Energy Efficiency Rating		
	Current	Potential
Very energy efficient - lower running costs		
(92-plus) A		
(81-91) B		85
(69-80) C		
(55-68) D	60	
(39-54) E		
(21-38) F		
(1-20) G		
Not energy efficient - higher running costs		
England & Wales	EU Directive 2002/91/EC	