



Fordbridge Road
Birmingham

burchell
edwards



Property Description

Burchell Edwards Castle Bromwich are delighted to offer this stylish two bedroom semi-detached property with a garage, conveniently located in the Kingshurst area.

The property in brief comprises an entrance porch, spacious lounge, kitchen/diner, family bathroom and two bedrooms. Outside, the rear you have a low maintenance rear garden and to the front ample off road parking and garage.

Location is key as it allows easy access to many amenities including shops, eateries and public transport links into Birmingham City Centre, Birmingham Airport and many more popular destinations.

We would recommend a viewing to be essential in order to appreciate the space and accommodation available.

Entrance Porch

Door to front elevation, double glazed window to side elevation and carpet.

Lounge

Double glazed window to front elevation, door to front elevation, laminate flooring, central heating radiator and stairs to first floor accommodation.

Kitchen/ Diner

Double glazed window to rear elevation, door to garden, a range of wall and base units with work surface over incorporating a sink with drainer unit, space and connections for gas cooker, space and plumbing for washing machine and dishwasher, central heating radiator, spotlights, laminate flooring and central heating boiler housed.

Landing

Loft access via hatch and carpet.

Bedroom One

Double glazed window to front elevation, central heating radiator, carpet and laminate flooring.

Bedroom Two

Double glazed window to rear elevation, central heating radiator and carpet.

Bathroom

Double glazed window to side elevation, W.C, wash hand basin, bath with shower over, heated towel rail, tiling to splash prone areas, vinyl flooring, spotlights.

Front Garden

Driveway providing off road parking.

Rear Garden

Block paved patio, astro turf, plants, decorative rockery, access to garage.





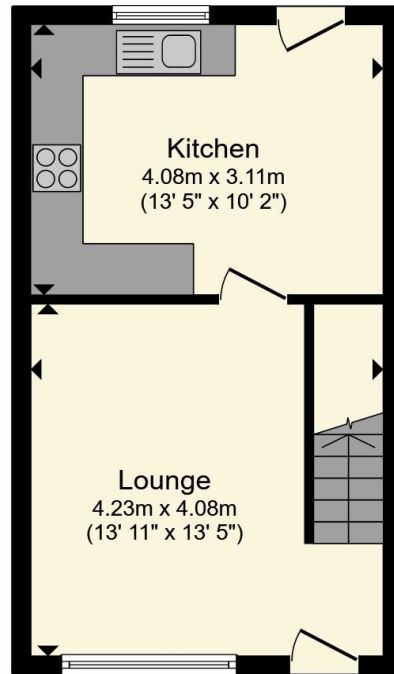

Ground Floor

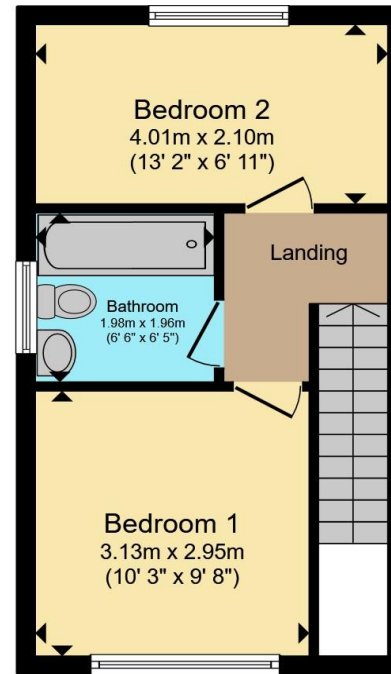

First Floor

Total floor area 59.6 m² (642 sq.ft.) approx

This floor plan is for illustrative purposes only. It is not drawn to scale. Any measurements, floor areas (including any total floor area), openings and orientation are approximate. No details are guaranteed, they cannot be relied upon for any purpose and they do not form part of any agreement. No liability is taken for any error, omission or misstatement. A party must rely upon its own inspection(s). Powered by www.propertybox.io



To view this property please contact Burchell Edwards on

T 0121 749 7888
E castlebromwich@burchelledwards.co.uk

2-4 Hurst Lane
 BIRMINGHAM B34 7HR

EPC Rating: C Council Tax
 Band: B

Tenure: Freehold

view this property online burchelledwards.co.uk/Property/CBW211121



1. MONEY LAUNDERING REGULATIONS Intending purchasers will be asked to produce identification documentation at a later stage and we would ask for your co-operation in order that there will be no delay in agreeing the sale. 2. These particulars do not constitute part or all of an offer or contract. 3. The measurements indicated are supplied for guidance only and as such must be considered incorrect. Potential buyers are advised to recheck measurements before committing to any expense. 4. We have not tested any apparatus, equipment, fixtures, fittings or services and it is in the buyers interest to check the working condition of any appliances.

Burchell Edwards is a trading name of Connells Residential which is registered in England and Wales under company number 1489613, Registered Office is Cumbria House, 16-20 Hockliffe Street, Leighton Buzzard, Bedfordshire, LU7 1GN. VAT Registration Number is 500 2481 05.

See all our properties at www.burchelledwards.co.uk | www.rightmove.co.uk | www.zoopla.co.uk

Property Ref: CBW211121 - 0004