



MILES ESTATE AGENTS

**3 Wheatstones Bishops Lydeard
Taunton TA4 3NS £285,000**



A well presented and extended 4 bedroom semi detached house set in lovely mature gardens in the heart of this ever popular Quantock village 6 miles North West of Taunton within Kingsmead catchment area. Good size sitting room, separate dining room with conservatory, semi integral garage and off road parking. Early viewing highly recommended. Freehold Council Tax Band C EPC : D





Features:

- Entrance porch
- Good size sitting room
- Separate dining room
- Updated kitchen
- Useful conservatory
- 4 bedrooms
- Family bathroom & separate WC
- Lovely mature garden
- Garage & off road parking
- Freehold
- Council Tax Band C
- EPC : D



GROUND FLOOR
54.0 sq.m. (582 sq.ft.) approx.

1ST FLOOR
41.9 sq.m. (451 sq.ft.) approx.

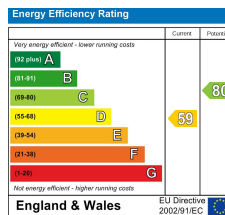
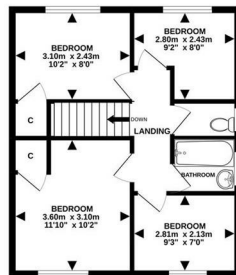

TOTAL FLOOR AREA: 95.9 sq.m. (1033 sq.ft.) approx.
Made with Measure (2002)



Viewings strictly through the selling agents:

Miles Estate Agents

2 Piffin Lane, Bishops Lydeard, Taunton, Somerset, TA4 3AS

Tel: 01823 470 500

lydeard@milesestateagents.co.uk

www.milesestateagents.co.uk



rightmove

OnTheMarket.com

MILES ESTATE AGENTS

BEST
ESTATE AGENT GUIDE
2019 : EXCEPTIONAL
SALES