

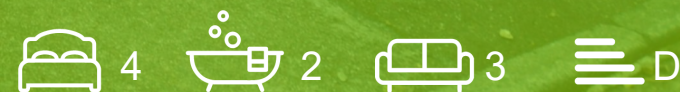

19 The Green, Croxley Green, Rickmansworth, WD3 3HN  
£3,400 PCM

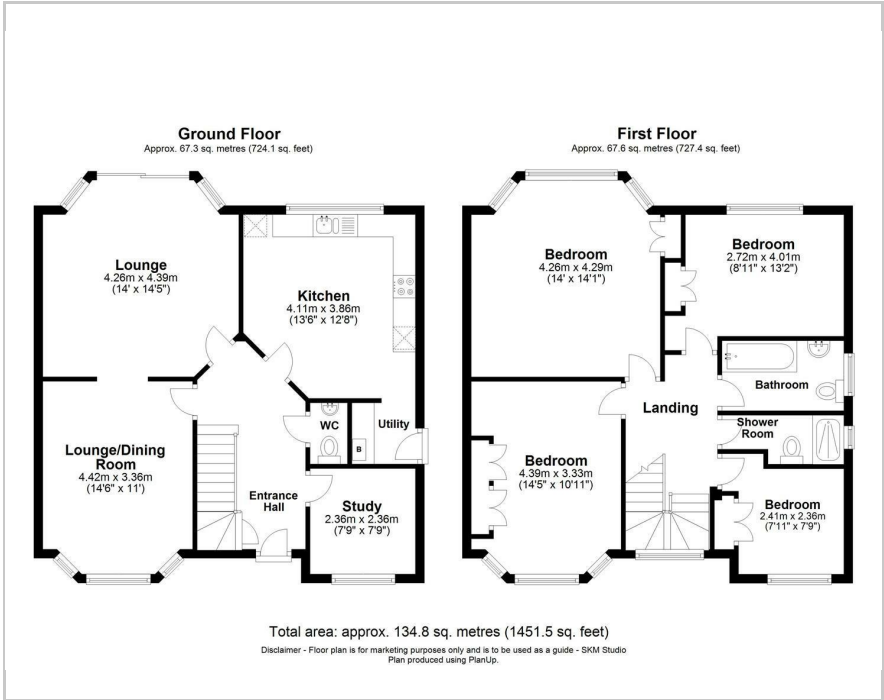

Floor Plan



Area Map



Accommodation

- Beautiful location just off The Green
- Quiet residential side road.
- New Kitchen, 4 Bedrooms.
- 3 Recs. New flooring throughout
- Modern bathroom & shower room
- OSP | Secluded rear garden
- Walking distance to met line.
- Close to good schools
- Available now!

Viewing

Please contact our Grosvenor Estate Agents Ltd Office on 01923 711651 if you wish to arrange a viewing appointment for this property or require further information.

Energy Efficiency Graph

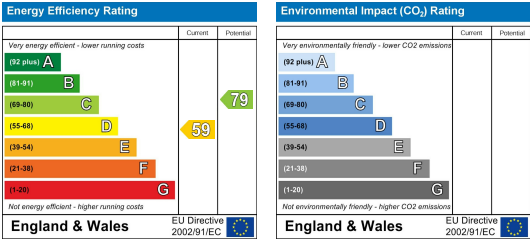

These particulars, whilst believed to be accurate are set out as a general outline only for guidance and do not constitute any part of an offer or contract. Intending purchasers should not rely on them as statements of representation of fact, but must satisfy themselves by inspection or otherwise as to their accuracy. No person in this firms employment has the authority to make or give any representation or warranty in respect of the property.