

**Aldreds**  
Estate Agents



16 Paston Road  
Gorleston, NR31 7AU  
£165,000



## 16 Paston Road

Gorleston, NR31 7AU

Situated in a Gorleston location not far from the town centre, this three bedroom mid-terrace home is offered chain free and presents an excellent opportunity for first-time buyers or investors alike. The property features a welcoming layout with three well-proportioned bedrooms off the landing, a convenient downstairs cloakroom, and gas central heating throughout. Its close proximity to local amenities and transport links adds to the home's everyday appeal.

To the rear, a private and secure garden provides a pleasant outdoor space with plenty of potential. Requiring some modernization, the property offers fantastic scope to add value and create a home tailored to your taste. Combining location, space, and opportunity, this is a property not to be missed.

### Entrance Hall

Vinyl floor, double glazed door to front, stairs to first floor, access to lounge.

### Lounge

14'6" x 12'5" (4.42m x 3.81m)

Laminate floor, radiator, double glazed window to front, built in desk and shelving area, access to Kitchen.

### Kitchen

14'6" x 8'1" (4.42m x 2.47m)

Vinyl floor, double glazed window and door to rear, laminate counter tops with over and under counter cupboards, sink and draining board, space for cooker, under counter fridge and freezer, plumbing for washing machine, wall mounted gas combi boiler, access to downstairs WC through small lobby, radiator.

### Inner Lobby

Vinyl floor, access to cloak room, cupboard under stairs.

### Cloakroom

Vinyl floor, WC, basin, double glazed window to rear.

### First Floor Landing

Carpet floor, loft hatch, access to 3 bedrooms and bathroom.

### Bedroom 1

10'11" x 9'6" (3.33m x 2.91m)

Carpet floor, double glazed window to front, built in wardrobe space, radiator.

### Bedroom 2

8'6" x 11'2" (2.61m x 3.41m)

Carpet floor, double glazed window to rear, radiator, built in cupboard.





### Bedroom 3

8'8" x 8'0" (2.65m x 2.46m)

Carpet floor, double glazed window to rear, radiator, high window looking into landing.

### Bathroom

Vinyl floor, double glazed window to front, WC, basin, bath tub with wall mounted shower, heated towel rail.

### Outside Front

Combination of grass lawn and gravel, timber fence and brick wall boundaries, concrete path to front door.

### Outside Rear

Artificial lawn, gravel area, concrete patio seating area, timber shed, timber fence boundaries with access gate to the rear.

### Council Tax Band

Great Yarmouth Borough Council - Band A

### Services

Mains gas, water, electric, drainage.

### Tenure

Freehold

### Directions

Head south along the High Street, turn right at the traffic lights in to Church Lane, continue over the roundabout turning left in to Baliol Road and right into Paston Road where the property can be found on the right hand side.

### Location

Gorleston on Sea is a coastal town 2 miles from Great Yarmouth centre and has a varied selection of local shops \* Golf Course \* Modern District hospital \* Schools for all ages \* Library \* Regular bus services to the main shopping areas and a sandy beach.

### What 3 Words

///driftwood.mashing.opposite

### Ref



## Floor Plan

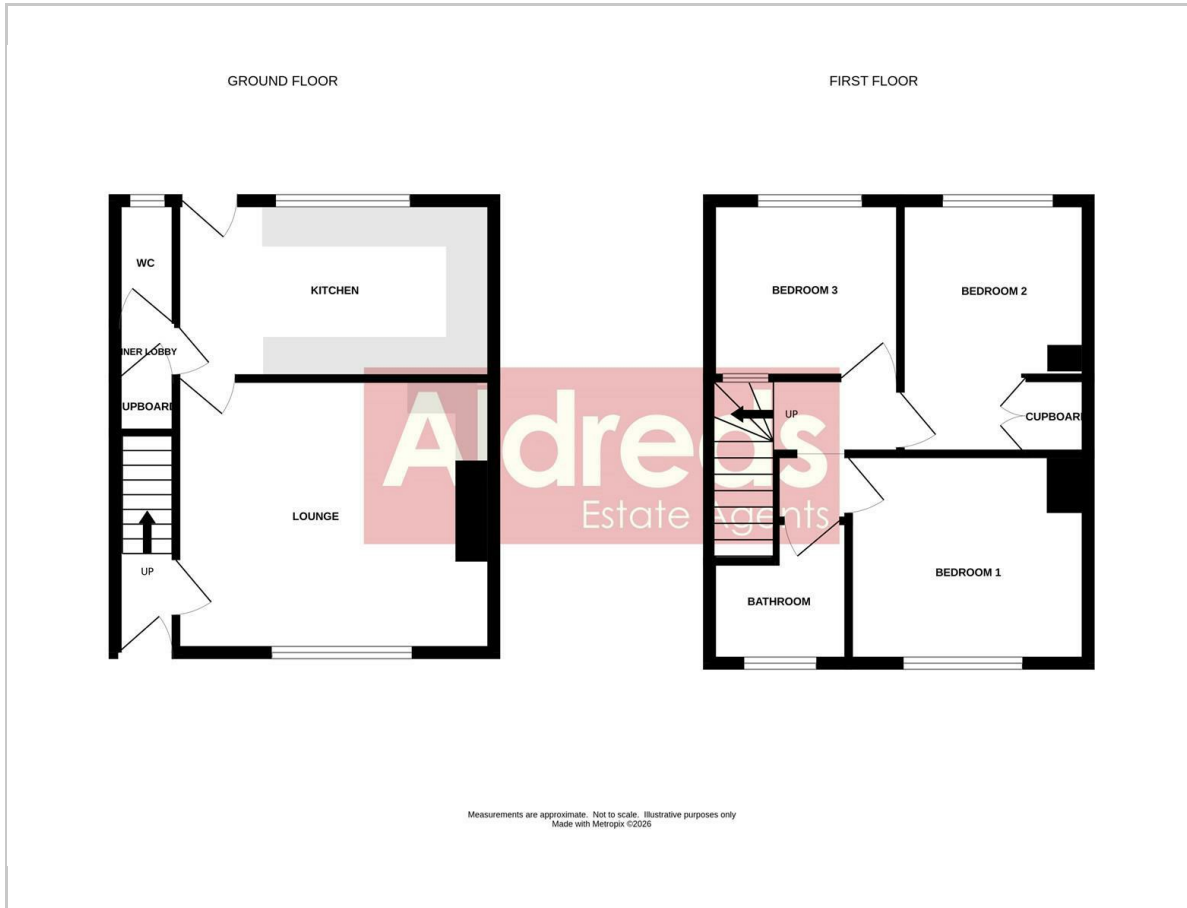

## Viewing

Please contact our Aldreds Gorleston Office on 01493 664600 if you wish to arrange a viewing appointment for this property or require further information.

### Disclaimer

These particulars are issued on an understanding that all negotiations shall be conducted through Messrs. Aldreds. Please note: Messrs. Aldreds for themselves and for the vendors or lessors of this property whose agents they are given notice that: 1. Particulars are set out as a general outline only for guidance of intending purchasers or lessees, and do not constitute nor constitute part of, an offer or contract. 2. All descriptions, dimensions, references to condition and necessary permissions for use and occupation, and other details are given without responsibility and any intending purchasers or tenants should not rely on them as statements or representations of fact but must satisfy themselves by inspection or otherwise as to the correctness of each of them. 3. No person in the employment of Messrs. Aldreds has any authority to make or give any representation or warranty whatever in relation to this property. 4. If you are proposing to visit the property and are travelling some distance please check with Aldreds on the issue of availability prior to travelling. 5. Aldreds Property Consultants and associated services may offer additional services to the prospective purchaser for which they will be entitled to receive a commission.

Aldreds are pleased to be working with Mortgage Advice Bureau. They're an award-winning mortgage broker with over 1,400 advisers across the UK, and have access to over 12,000 mortgage products from over 90 lenders. Aldreds Estate Agents Ltd receive a commission of £200 on each completed case. Your home may be repossessed if you do not keep up repayments on your mortgage. There may be a fee for mortgage advice. The actual amount you pay will depend upon your circumstances. The fee is up to 1%, but a typical fee is 0.3% of the amount borrowed. Mortgage Advice Bureau is a trading name of Mortgage Seeker Limited which is an appointed representative of Mortgage Advice Bureau Limited and Mortgage Advice Bureau (Derby) Limited which are authorised and regulated by the Financial Conduct Authority. Mortgage Seeker Limited Registered Office: Lovewell Blake, Sixty Six North Quay, Great Yarmouth, Norfolk, NR30 1HE. Registered in England Number: 03721415. 6. Potential purchasers should check with their providers that the broadband and mobile phone coverage they would require is available.

## Area Map

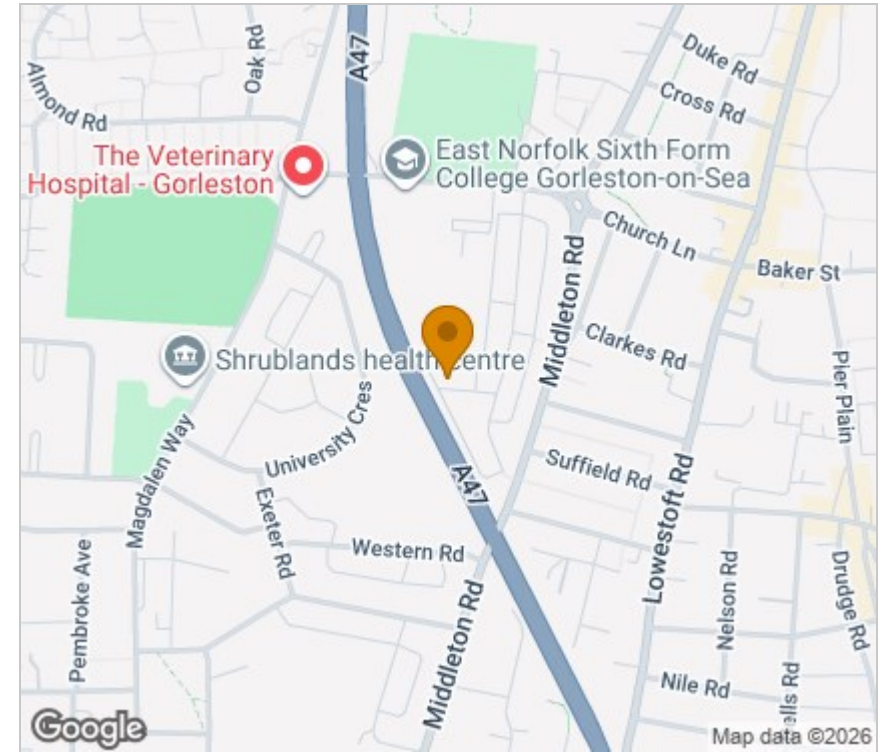

## Energy Efficiency Graph

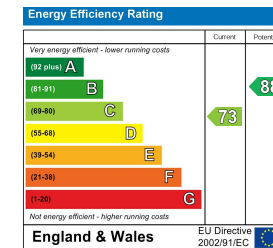

149 High Street, Gorleston, Norfolk, NR31 6RB

Tel: 01493 664600 Email: [gorleston@aldreds.co.uk](mailto:gorleston@aldreds.co.uk) <https://www.aldreds.co.uk/>

Registered in England Reg. No. 08945751 Registered Office: 17 Hall Quay, Great Yarmouth, Norfolk NR30 1HJ

Directors: Mark Duffield B.S.c. FRICS. Dan Crawley MNAEA Paul Lambert MNAEA